

**Product number C14606\_HB-2X2-WW**

Family	HighBay	FWHM	(simulated) 69
Type	Lens array	Efficiency	(simulated) 94 %
LED	XT-E	cd/Im	(simulated) 0.780
Color	Clear	Gerber File	Available
Diameter	50x50 mm		
Height	8.5 mm		
Style	Square		
Optic Material	PMMA		
Holder Material	-		
Fastening	["pin", "screw"]		
Status	Production ready		

**Product number C15925\_HB-2X2-ON**

Family	HighBay	FWHM	(simulated) 14+55
Type	Lens array	Efficiency	(simulated) 91 %
LED	XT-E	cd/Im	(simulated) 2.900
Color	Clear	Gerber File	Available
Diameter	50 x 50 mm		
Height	10 mm		
Style	Rectang		
Optic Material	PMMA		
Holder Material	-		
Fastening	["screw"]		
Status	Production ready		

**Product number C13233\_HB-2X2-M**

Family	HighBay	FWHM	25 degrees
Type	Lens array	Efficiency	92 %
LED	XT-E	cd/Im	3.700
Color	Clear	Gerber File	Available
Diameter	50x50 mm		
Height	8.5 mm		
Style	Square		
Optic Material	PMMA		
Holder Material	-		
Fastening	["glue", "screw", "pin"]		
Status	Production ready		

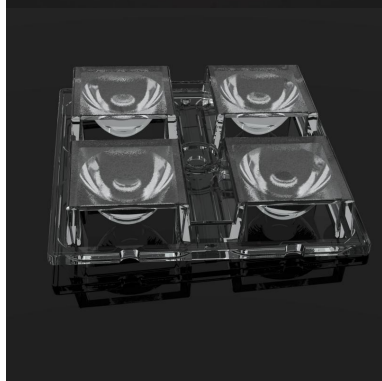
**Product number C13239\_HB-2X2-M-BLIND**

Family	HighBay	FWHM	25 degrees
Type	Lens array	Efficiency	92 %
LED	XT-E	cd/Im	3.700
Color	Clear	Gerber File	Available
Diameter	50x50 mm		
Height	8.5 mm		
Style	Square		
Optic Material	PMMA		
Holder Material	-		
Fastening	["glue", "pin"]		
Status	Production ready		

**Product number C13605\_HB-2X2-RW**

Family	HighBay
Type	Lens array
LED	XT-E
Color	Clear
Diameter	50x50 mm
Height	8.5 mm
Style	Square
Optic Material	PMMA
Holder Material	-
Fastening	["glue", "screw", "pin"]
Status	Production ready

FWHM	44 degrees
Efficiency	91 %
cd/Im	1.600
Gerber File	Available

Wide light pattern between C13233\_HB-2X2-M and C13232\_HB-2X2-WW beam angles.

**Product number C12361\_HB-2X2-W**

Family	HighBay
Type	Lens array
LED	XT-E
Color	Clear
Diameter	50x50 mm
Height	8.5 mm
Style	Square
Optic Material	PMMA
Holder Material	-
Fastening	["glue", "pin", "screw"]
Status	Production ready

FWHM	50 degrees
Efficiency	87 %
cd/Im	0.970
Gerber File	Available

**Product number C13232\_HB-2X2-WW**

Family	HighBay
Type	Lens array
LED	XT-E
Color	Clear
Diameter	50x50 mm
Height	8.5 mm
Style	Square
Optic Material	PMMA
Holder Material	-
Fastening	["screw", "pin", "glue"]
Status	Production ready

FWHM	65 degrees
Efficiency	91 %
cd/Im	0.900
Gerber File	Available

**Product number C13237\_HB-2X2-WW-BLIND**

Family	HighBay
Type	Lens array
LED	XT-E
Color	Clear
Diameter	50x50 mm
Height	8.5 mm
Style	Square
Optic Material	PMMA
Holder Material	-
Fastening	["pin", "glue"]
Status	Production ready

FWHM	65 degrees
Efficiency	91 %
cd/Im	0.900
Gerber File	Available



**PRODUCT DATASHEET**  
**HighBay series**  
last update 21/4/2016

**NOTE:** The typical divergence will be changed by different color, chip size and chip position tolerance. The typical total divergence is the full angle measured where the luminous intensity is half of the peak value.

**GENERAL INFORMATION**

- Product series especially designed & optimized for XT-E series of LEDs.
- Special care taken to make light distribution as uniform as possible.
- Lens material optical grade PMMA with high UV and temperature resistance. Allows use of high current and temperature conditions.

Please find more information about used material from below:

[http://ledil.fi/sites/default/files/Documents/Technical/Material/PMMA%20N%20UL94\\_Yellow%20Card.pdf](http://ledil.fi/sites/default/files/Documents/Technical/Material/PMMA%20N%20UL94_Yellow%20Card.pdf)

<http://ledil.fi/sites/default/files/Documents/Technical/Material/PMMA%20N%20PLEXIGLAS-Datasheet.pdf>

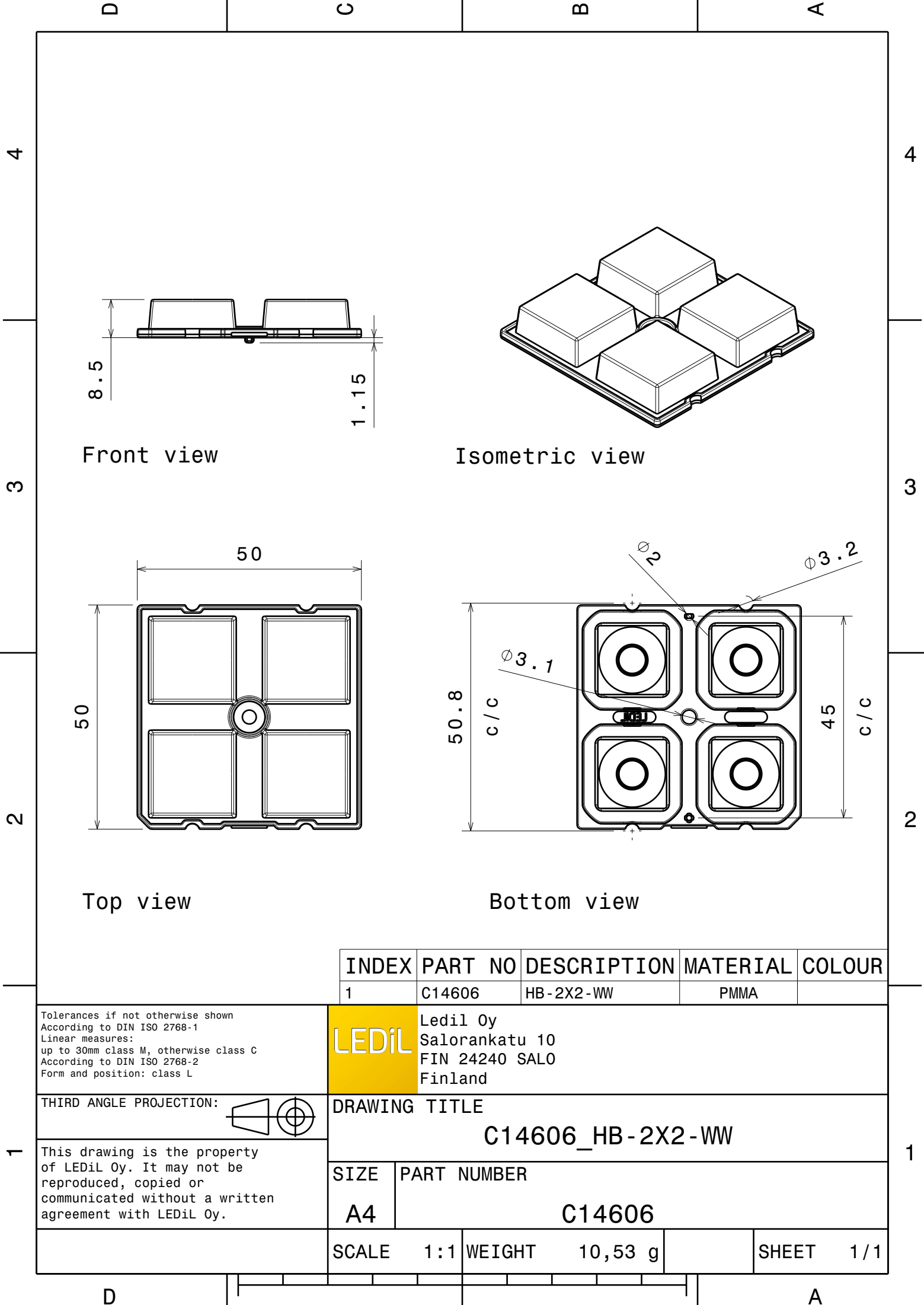

Front view

Isometric view

Top view

Bottom view

INDEX	PART NO	DESCRIPTION	MATERIAL	COLOUR
1	C14606	HB - 2X2 - WW	PMMA	

Tolerances if not otherwise shown  
According to DIN ISO 2768-1  
Linear measures:  
up to 30mm class M, otherwise class C  
According to DIN ISO 2768-2  
Form and position: class L

LEDiL

Ledil Oy  
Salorankatu 10  
FIN 24240 SALO  
Finland

THIRD ANGLE PROJECTION:

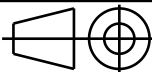

DRAWING TITLE

C14606\_HB-2X2-WW

This drawing is the property  
of LEDiL Oy. It may not be  
reproduced, copied or  
communicated without a written  
agreement with LEDiL Oy.

SIZE

PART NUMBER

A4

C14606

SCALE

1 : 1

WEIGHT

10,53 g

SHEET

1 / 1

Luminaire: Ledil Oy C14606\_HB-2X2-WW\_(XT-E)\_SIMULATED  
Lamps: 1 x Cree XT-E

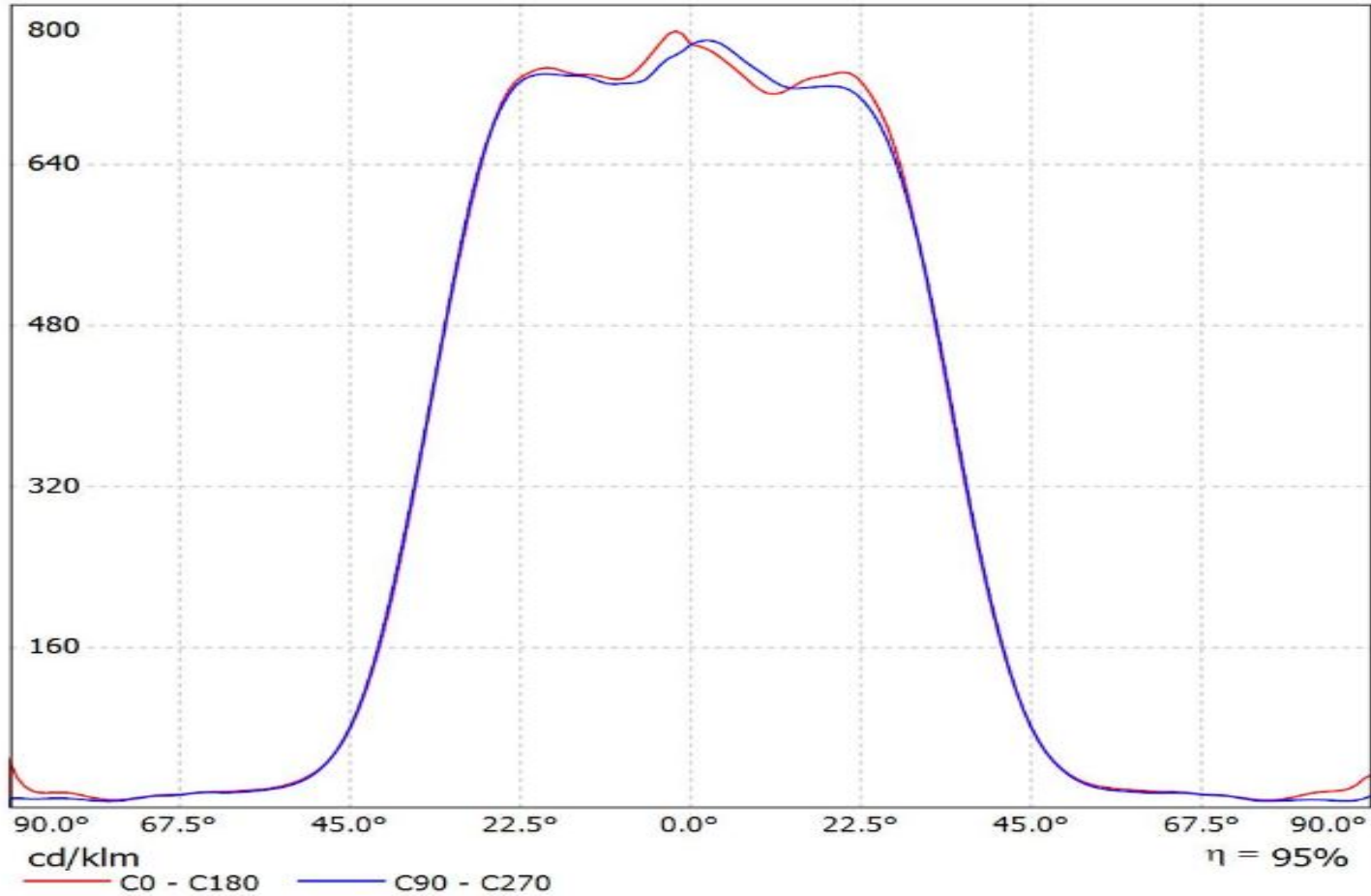

Luminaire: Ledil Oy PRELIMINARY\_C15925\_HB-2X2-ON\_(XT-E)\_SIMULATED  
Lamps: 1 x Cree XT-E

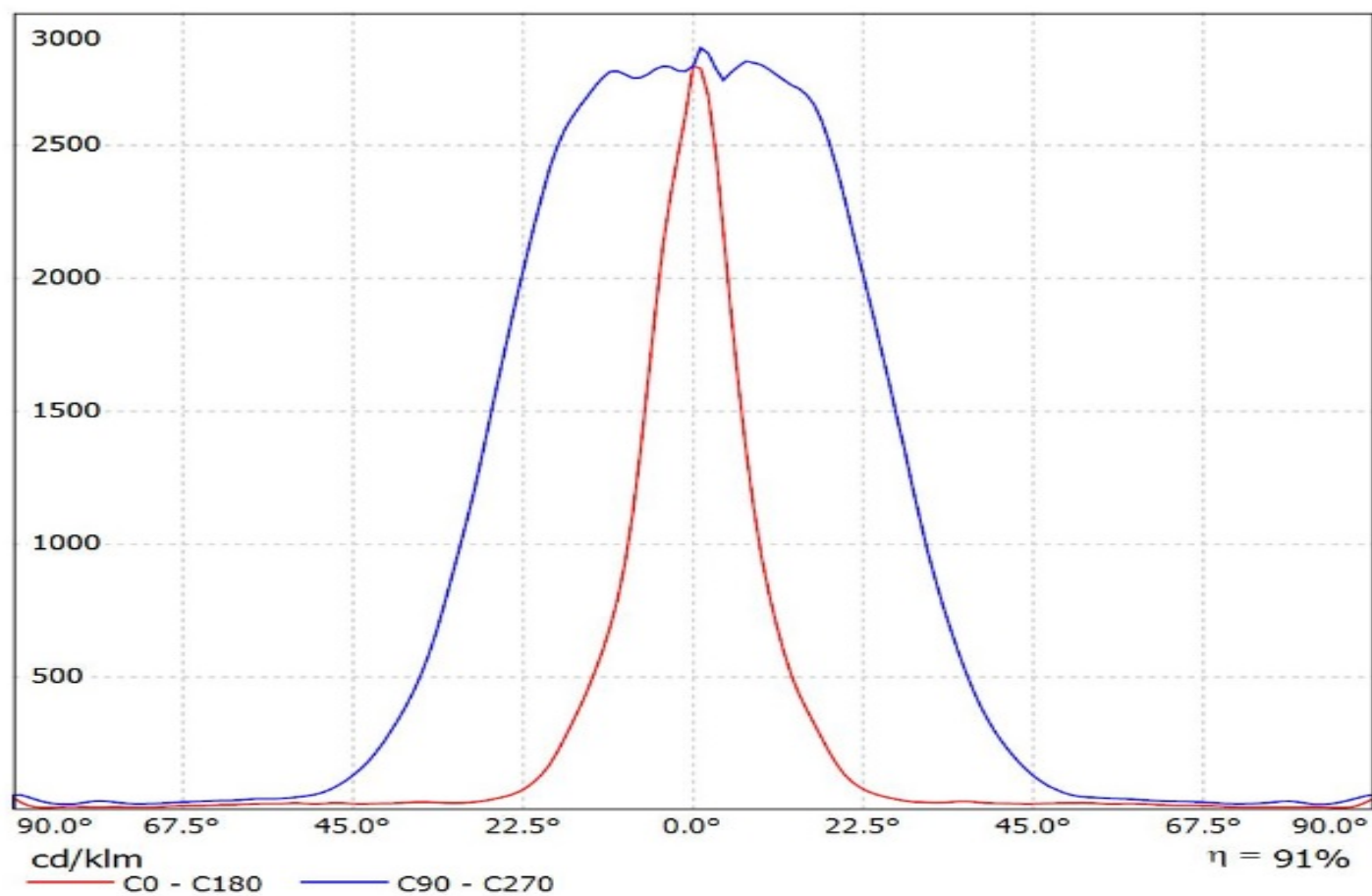

Luminaire: Ledil Oy C13233\_HB-2x2-M (Cree XT-E 390lm @ 250mA) Efficiency=92%  
Lamps: 1 x Cree XT-E 390lm @ 250mA

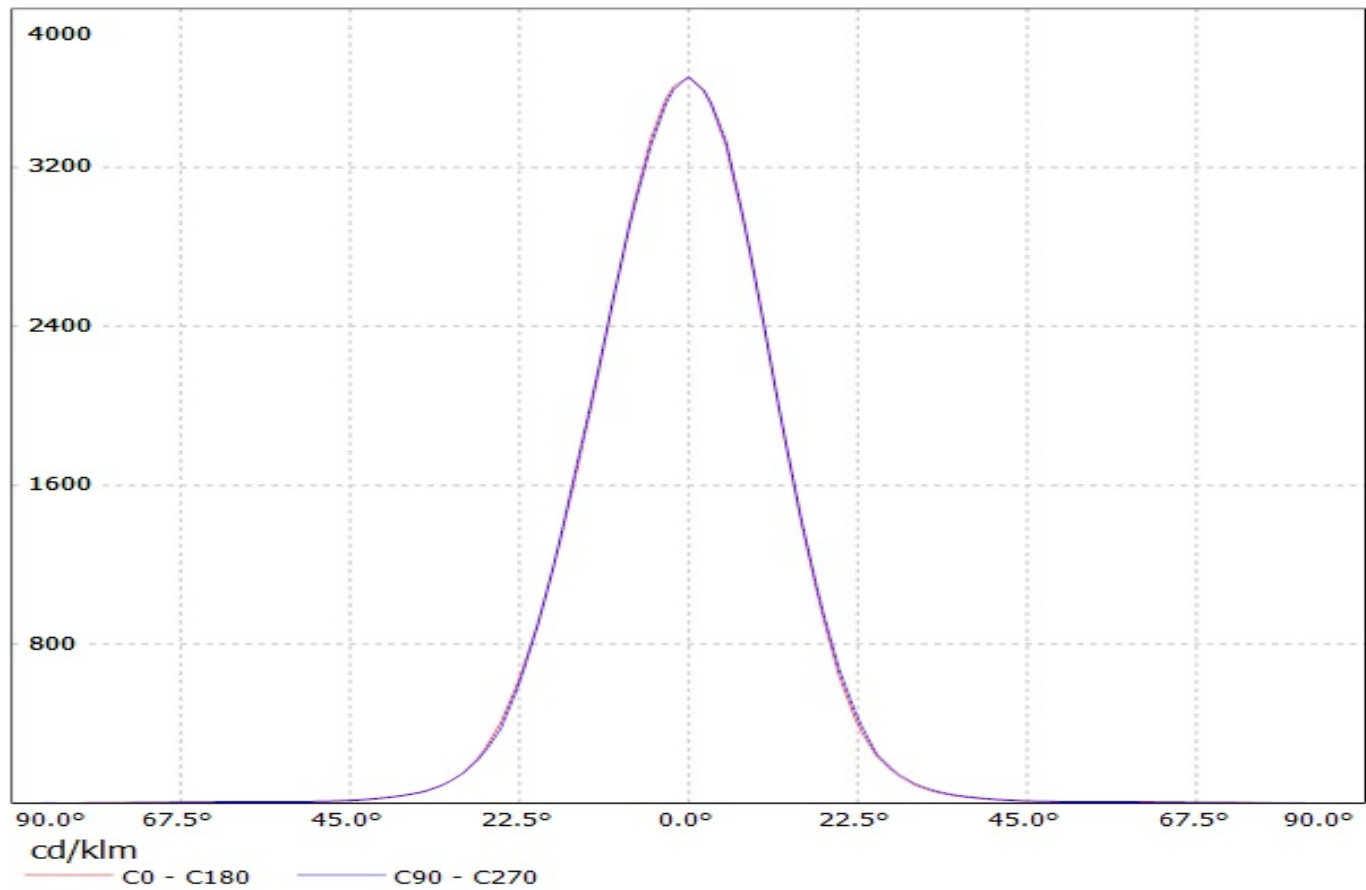



Luminaire: Ledil Oy C13233\_HB-2x2-M (Cree XT-E 390lm @ 250mA) Efficiency=92%  
Lamps: 1 x Cree XT-E 390lm @ 250mA

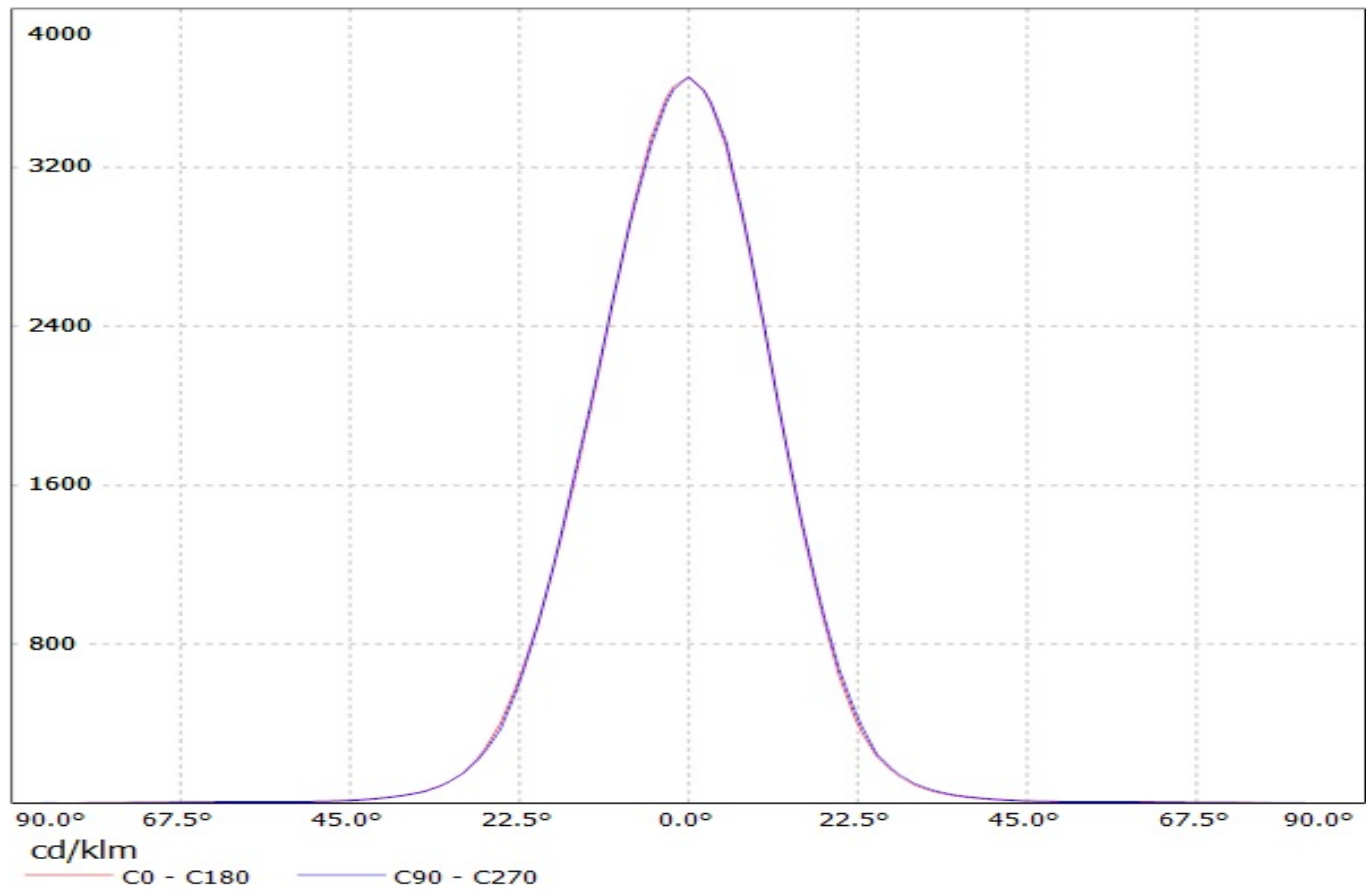

Luminaire: Ledil Oy C13605\_HB-2X2-RW (Cree XT-E 390lm @ 250mA) Efficiency=89%  
Lamps: 1 x Cree XT-E 390lm @ 250mA CCT=5717K P=3W I=250mA

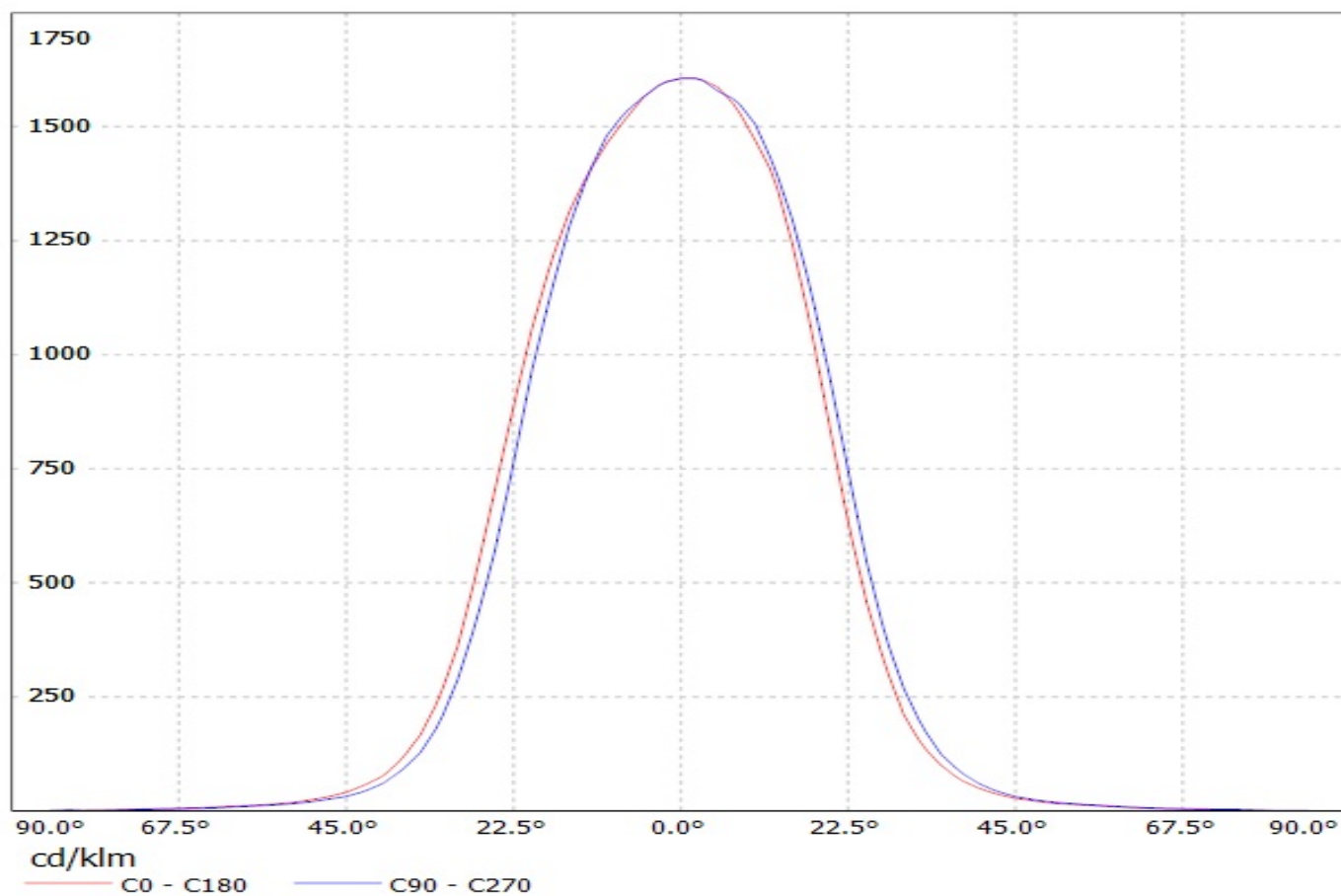

Luminaire: LEDIL OY C12361\_HB-2X2 (XT-E AWT) Efficiency=89%  
Lamps: 1 x Cree XT-E AWT (390lm@250mA)

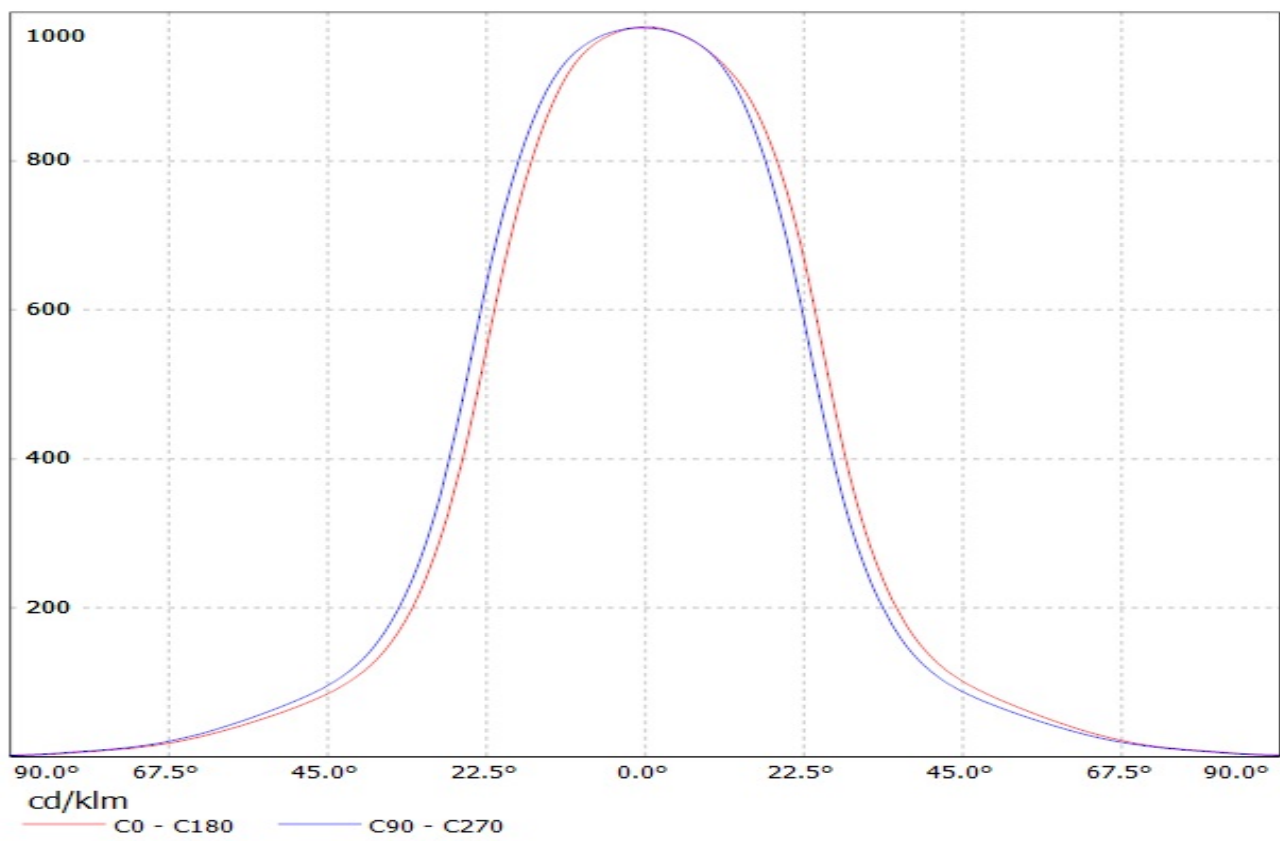

Luminaire: Ledil Oy C13237&C13232\_HB-2X2-WW (Cree XT-E 390lm @ 250mA) Efficiency=91%  
Lamps: 1 x Cree XT-E 390lm @ 250mA

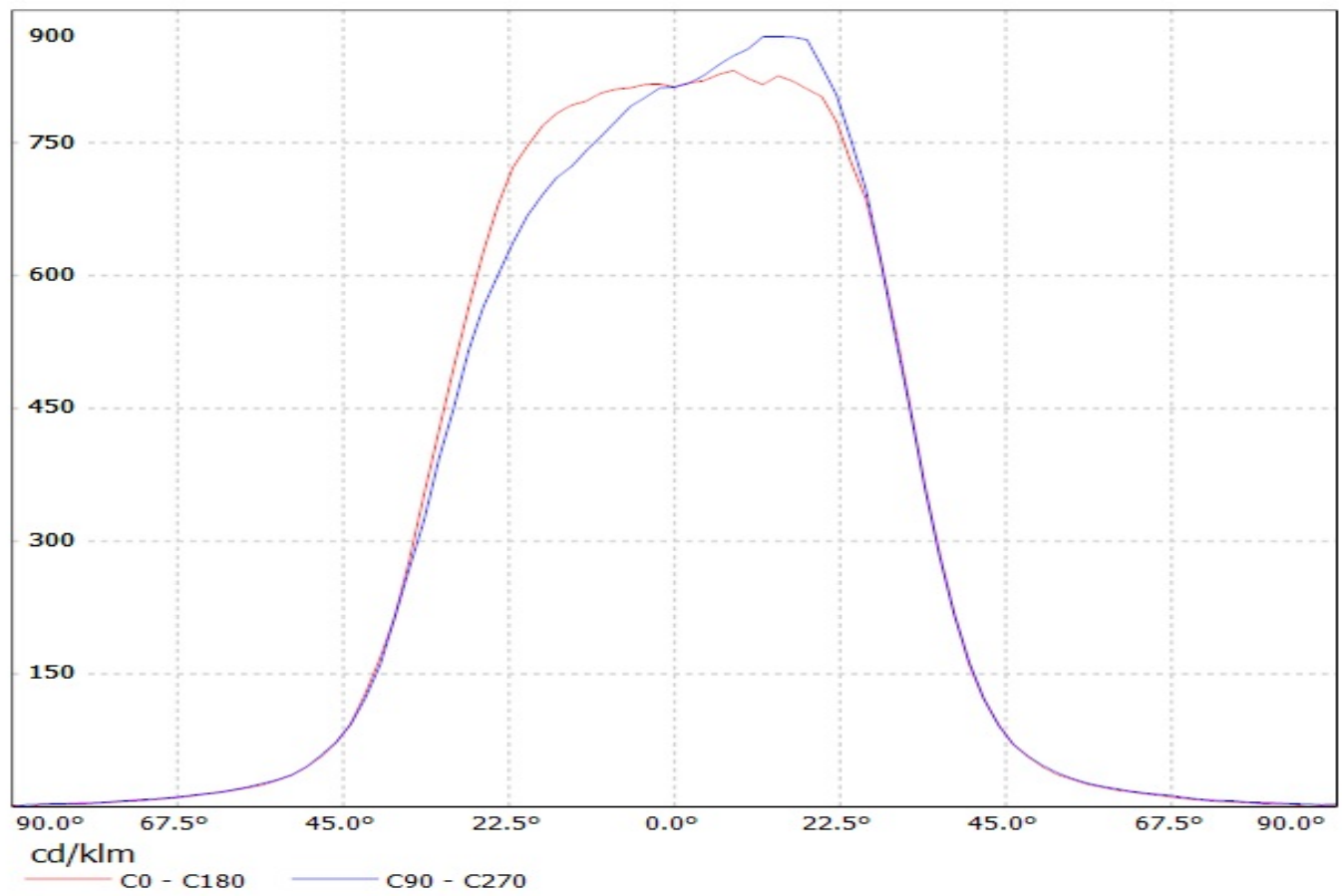

Luminaire: Ledil Oy C13237&C13232\_HB-2X2-WW (Cree XT-E 390lm @ 250mA) Efficiency=91%  
Lamps: 1 x Cree XT-E 390lm @ 250mA

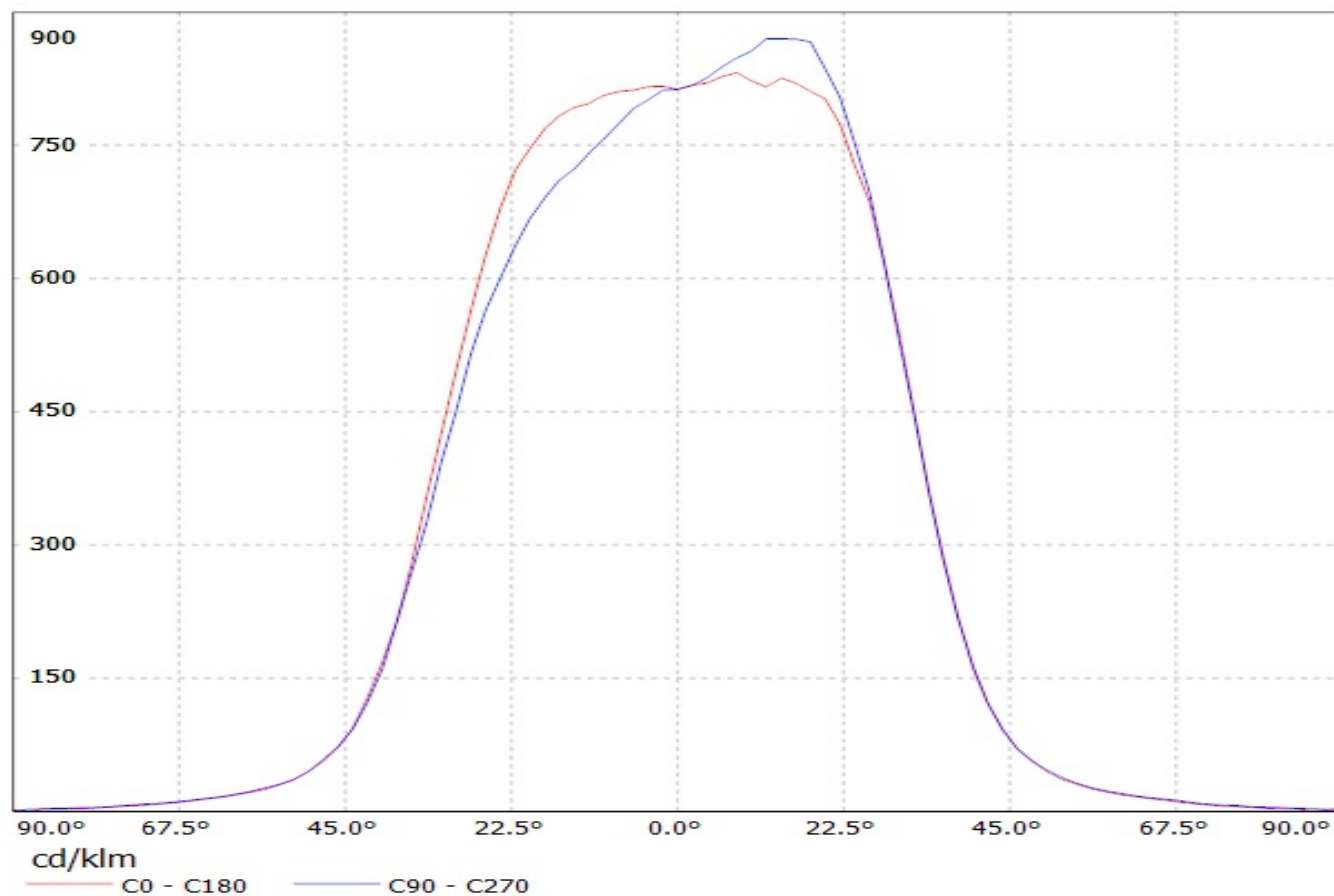

Luminaire: Ledil Oy C14606\_HB-2X2-WW\_(XT-E)\_SIMULATED  
Lamps: 1 x Cree XT-E

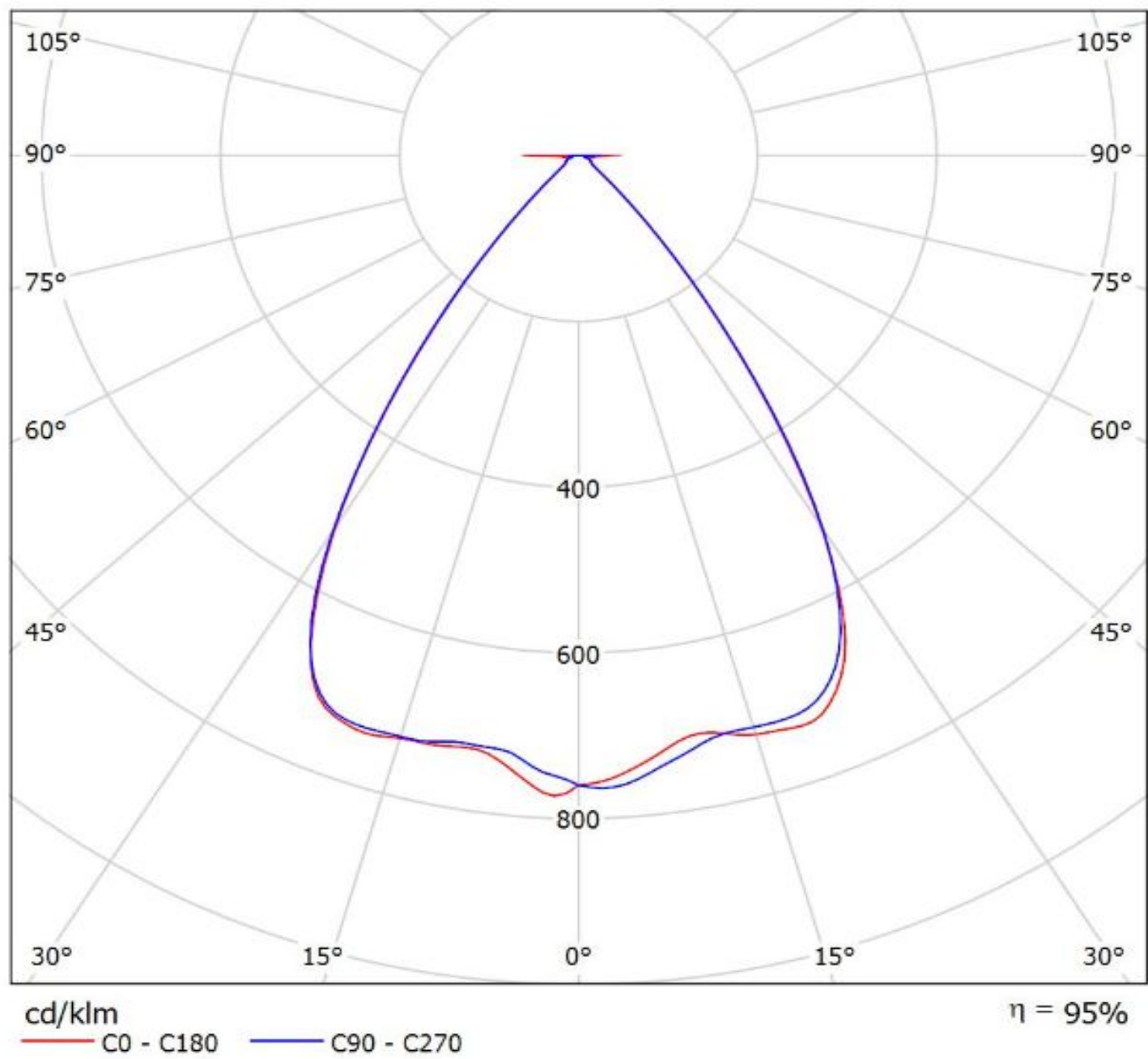

Luminaire: Ledil Oy PRELIMINARY\_C15925\_HB-2X2-ON\_(XT-E)\_SIMULATED  
Lamps: 1 x Cree XT-E

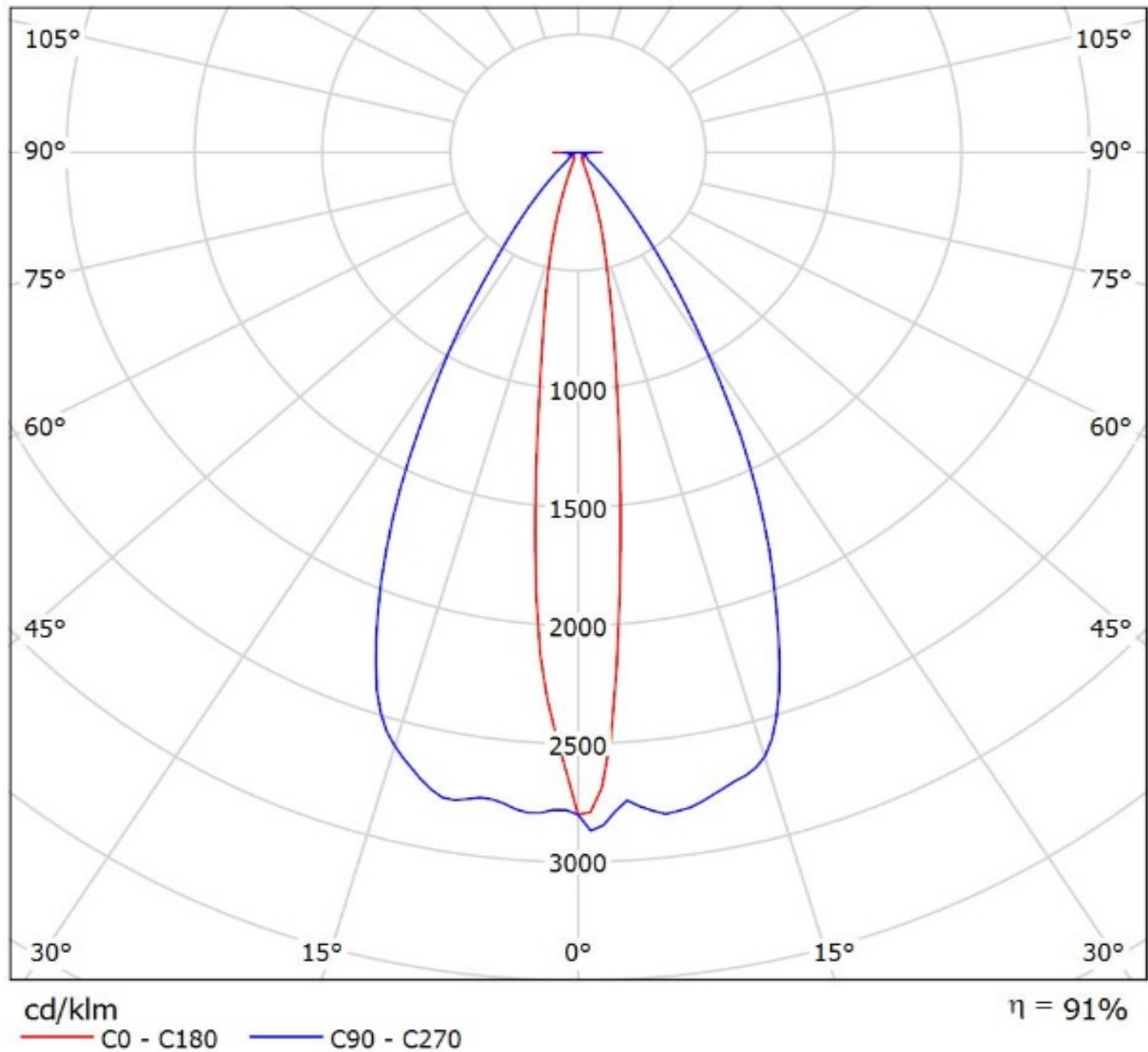

Luminaire: Ledil Oy C13233\_HB-2x2-M (Cree XT-E 390lm @ 250mA) Efficiency=92%  
Lamps: 1 x Cree XT-E 390lm @ 250mA

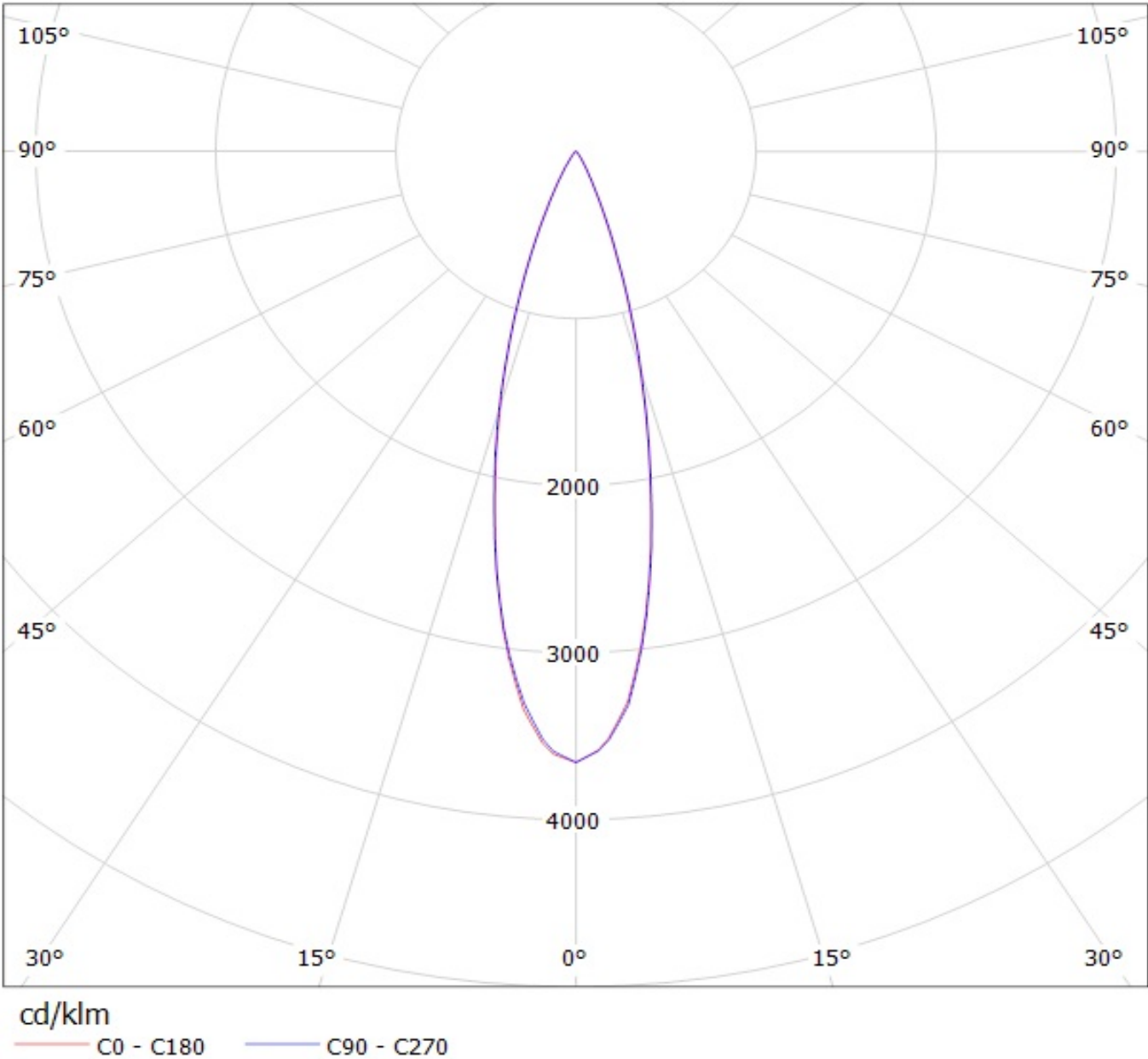



Luminaire: Ledil Oy C13233\_HB-2x2-M (Cree XT-E 390lm @ 250mA) Efficiency=92%  
Lamps: 1 x Cree XT-E 390lm @ 250mA

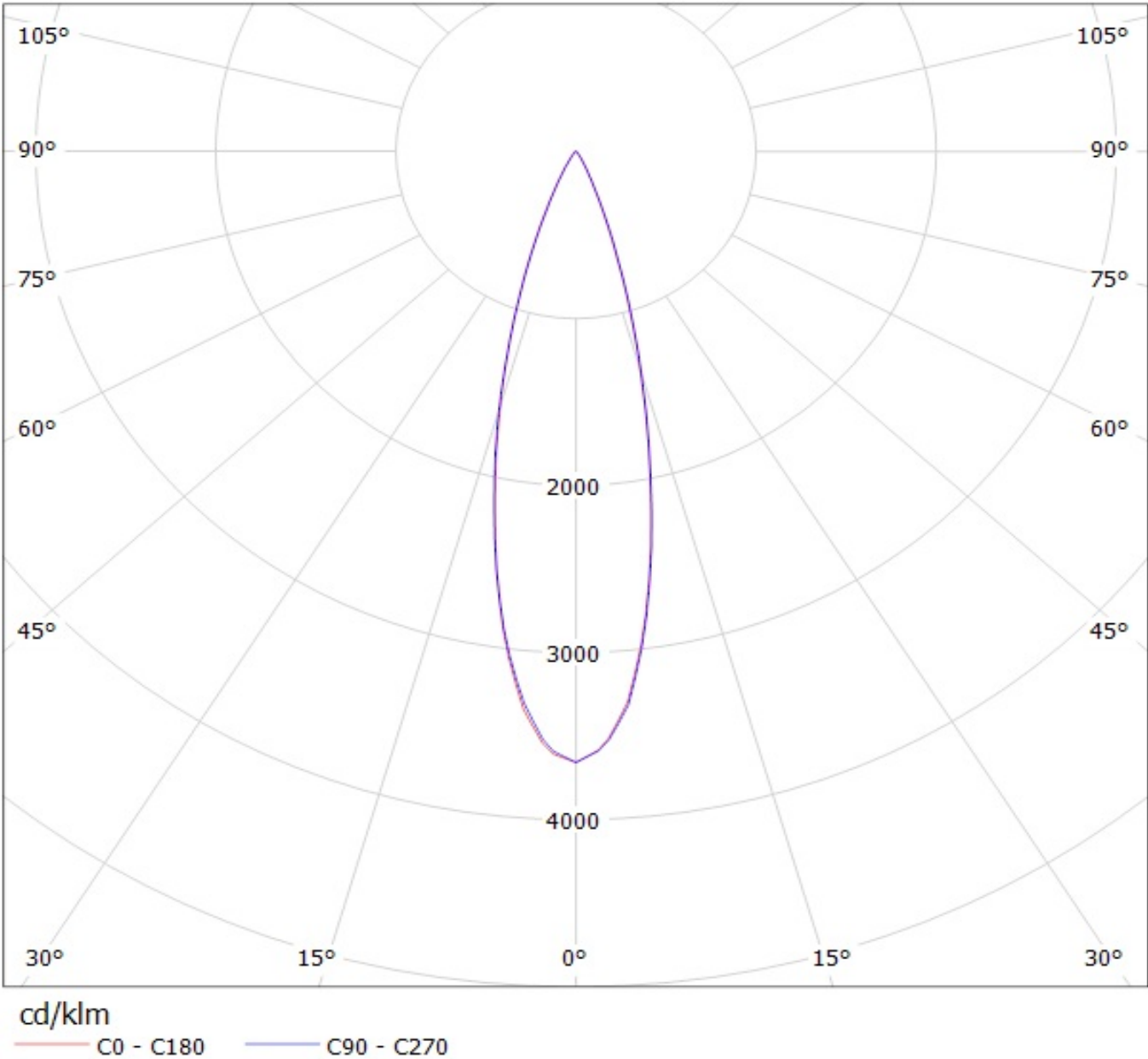

Luminaire: Ledil Oy C13605\_HB-2X2-RW (Cree XT-E 390lm @ 250mA) Efficiency=89%  
Lamps: 1 x Cree XT-E 390lm @ 250mA CCT=5717K P=3W I=250mA

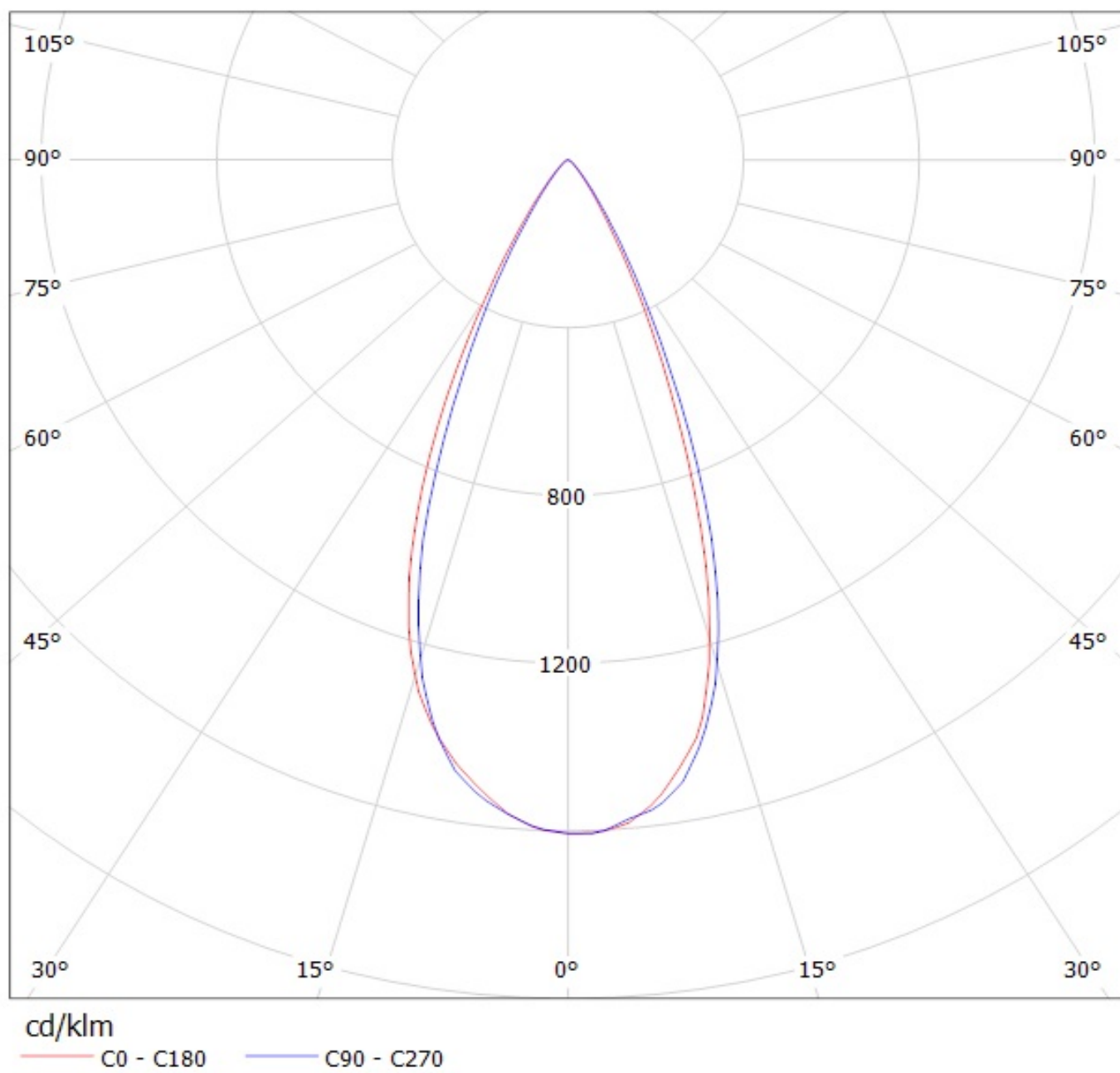

Luminaire: LEDIL OY C12361\_HB-2X2 (XT-E AWT) Efficiency=89%  
Lamps: 1 x Cree XT-E AWT (390lm@250mA)

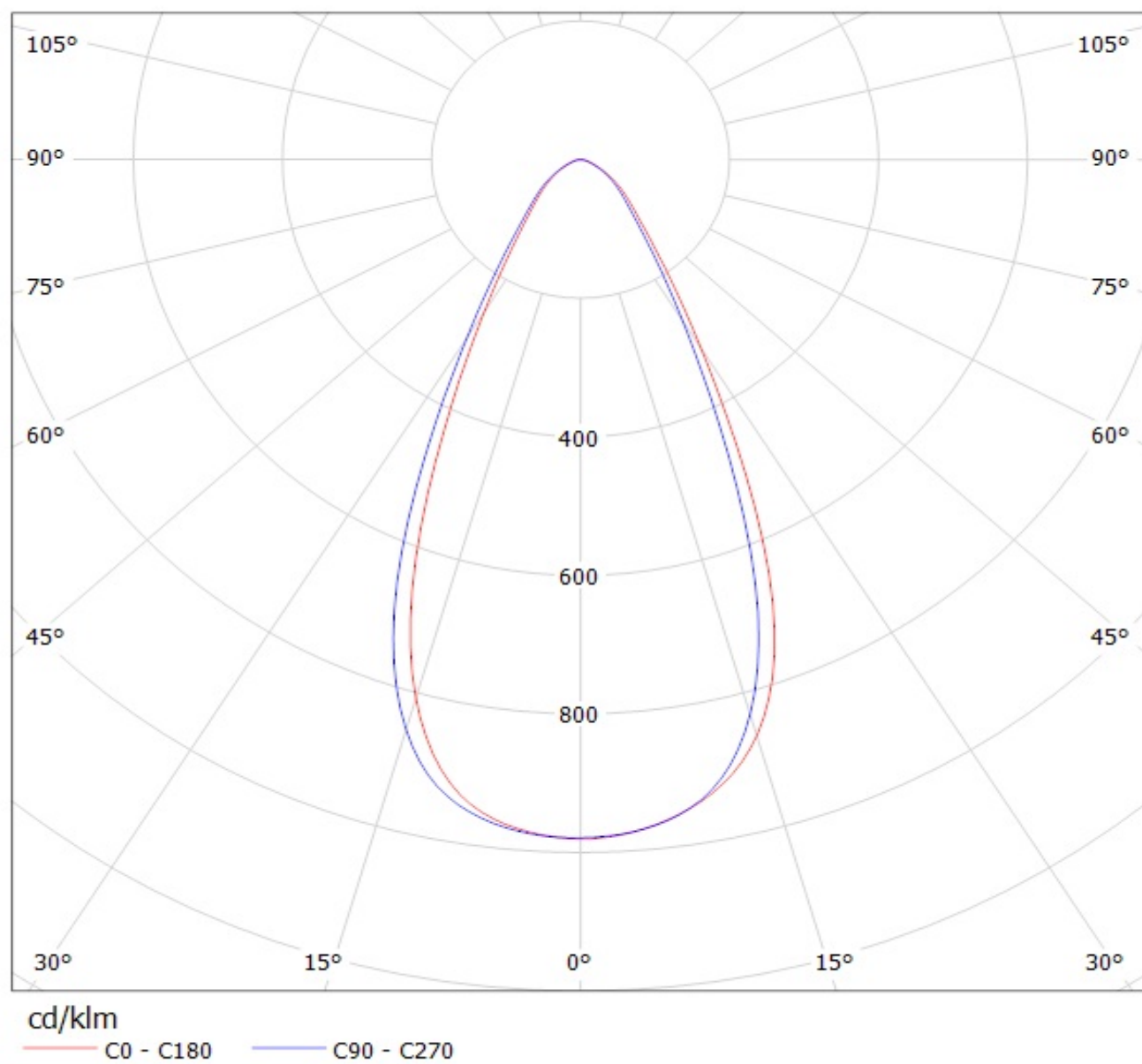

Luminaire: Ledil Oy C13237&C13232\_HB-2X2-WW (Cree XT-E 390lm @ 250mA) Efficiency=91%  
Lamps: 1 x Cree XT-E 390lm @ 250mA

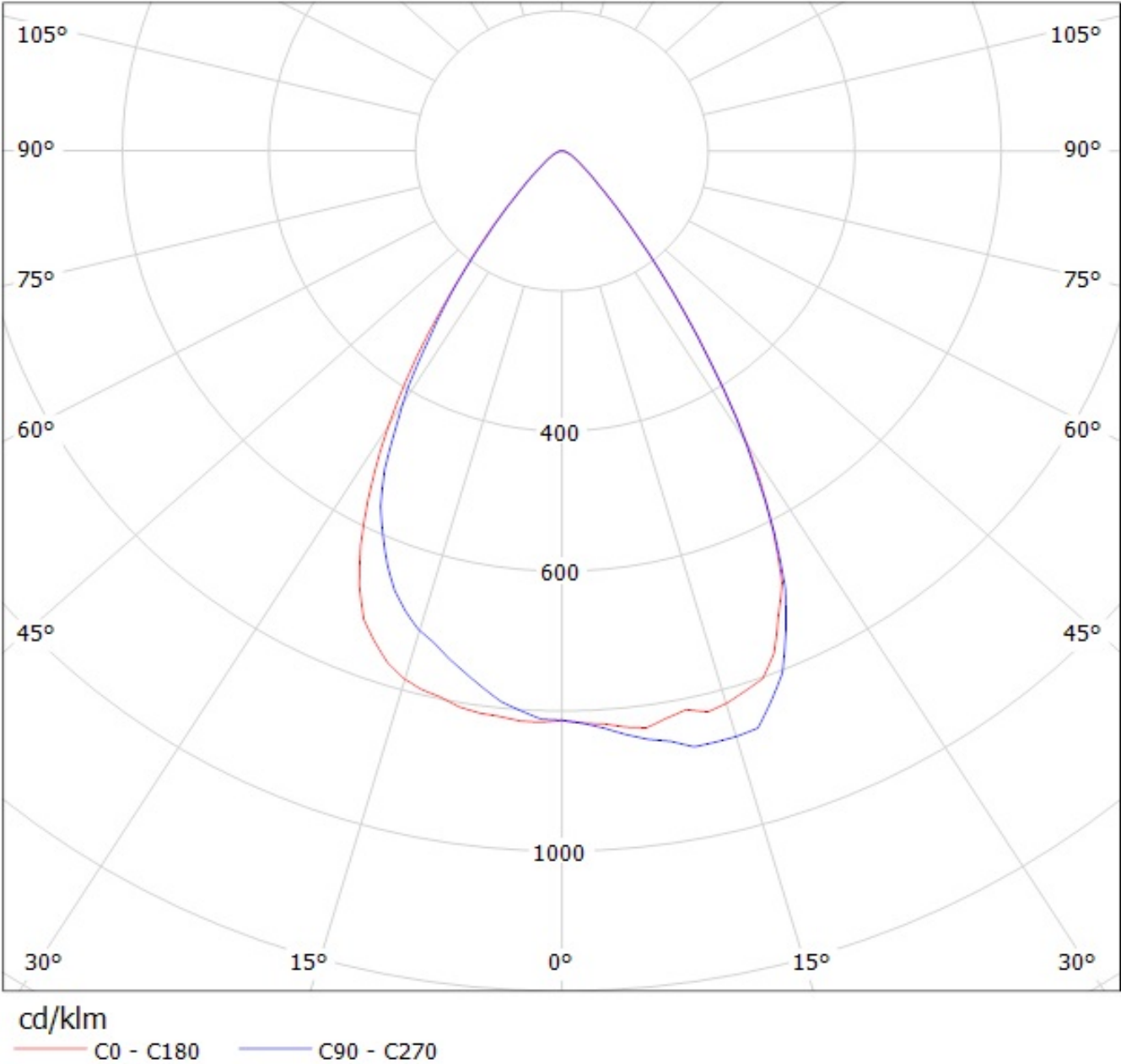

Luminaire: Ledil Oy C13237&C13232\_HB-2X2-WW (Cree XT-E 390lm @ 250mA) Efficiency=91%  
Lamps: 1 x Cree XT-E 390lm @ 250mA

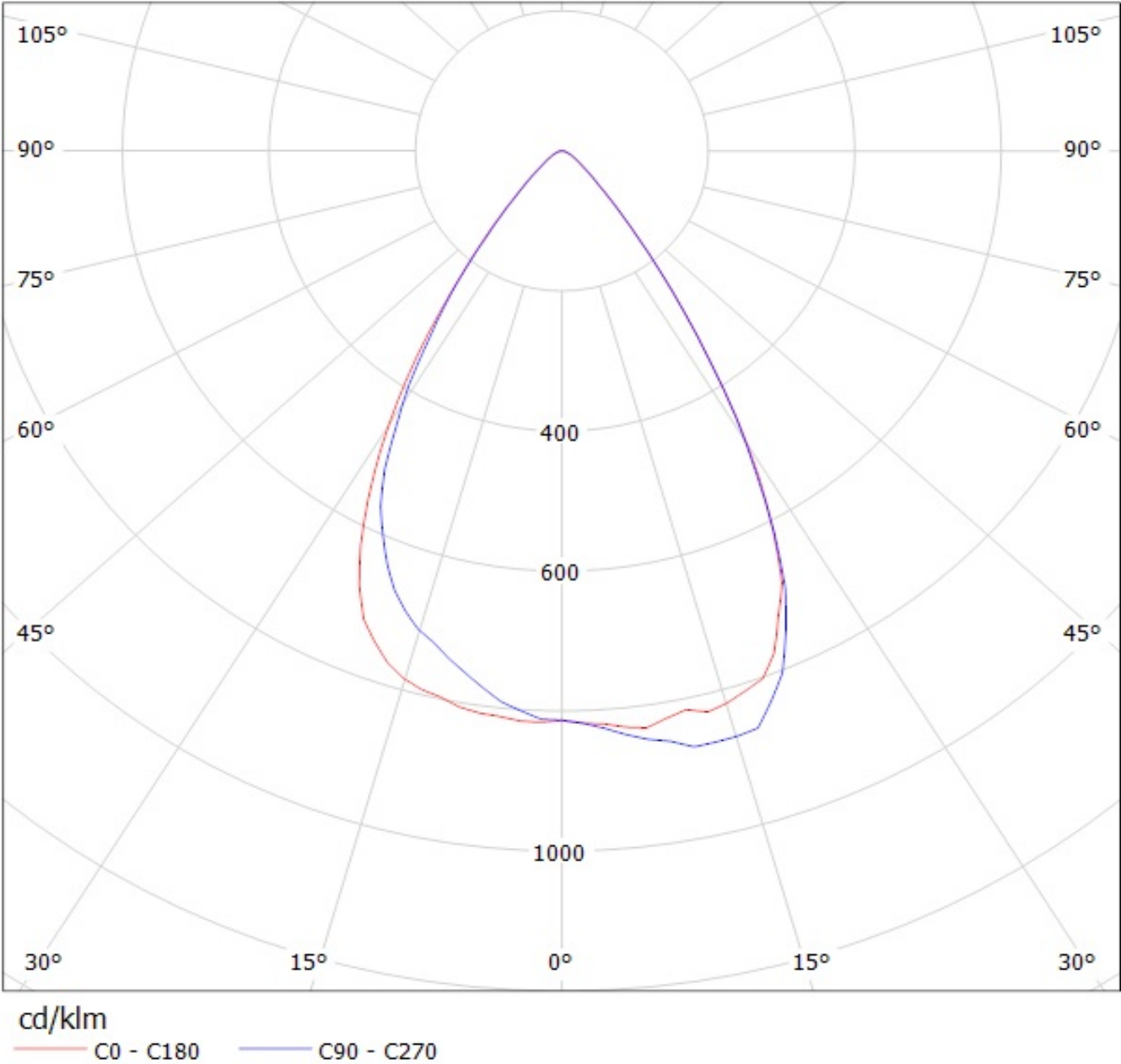

# Mouser Electronics

Authorized Distributor

Click to View Pricing, Inventory, Delivery & Lifecycle Information:

Ledil:

[C13232\\_HB-2X2-WW](#)