

### HOW TO ORDER

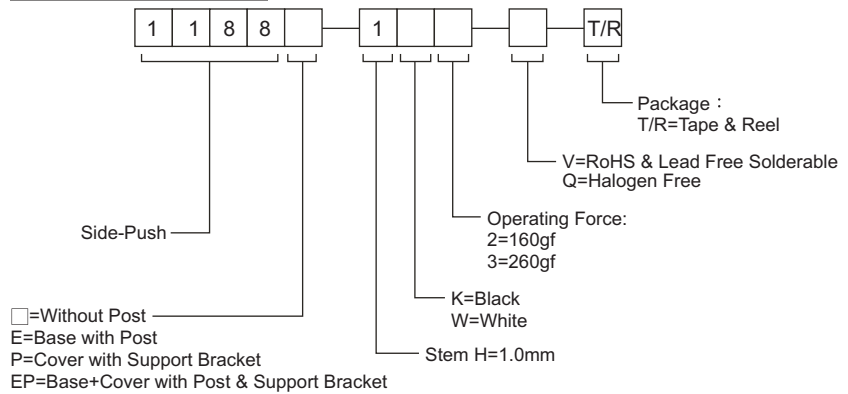

### SPECIFICATION

#### MECHANICAL

Operation Force: 260  $\pm$  50gf  
 160  $\pm$  50gf

Stroke: 0.25  $\pm$  0.1 mm

#### ENVIRONMENTAL

Operation Temperature Range : -25°C to +70°C

Storage Temperature Range : -40°C to +80°C

#### ELECTRICAL

Electrical Life : 50,000 cycles for 160gf.  
 30,000 cycles for 260gf.

Rating : 50mA, 12VDC

#### PACKAGE

Tape and Reel: 2000 pcs/reel

### CIRCUIT

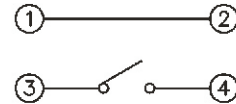

### 1188

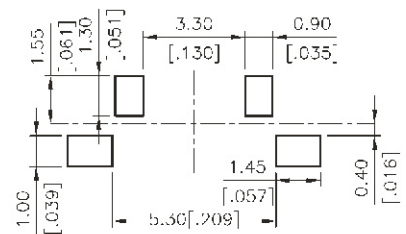
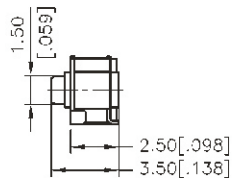
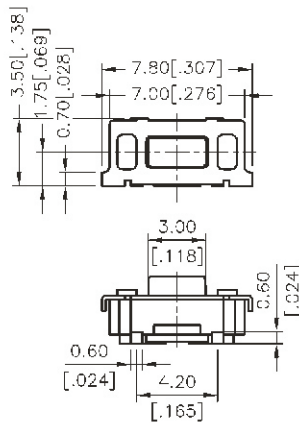

P.C.B. LAYOUT

### 1188E

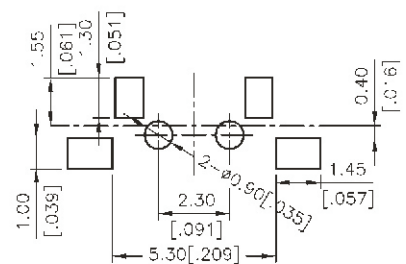
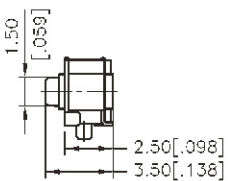
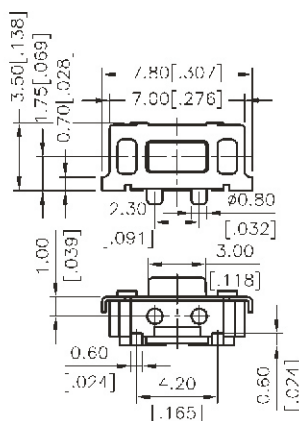

P.C.B. LAYOUT

### 1188P

