

Distributed by:

**JAMECO**<sup>®</sup>  
ELECTRONICS

**www.Jameco.com ♦ 1-800-831-4242**

The content and copyrights of the attached  
material are the property of its owner.

Jameco Part Number 2054029

# Inverse DIN 41612 Boardmount Socket

2 Row Type Q (Rows A & B Filled)

7164 Series



94

## IMPORTANT NOTICE TO PURCHASER

ALL STATEMENTS, TECHNICAL INFORMATION AND RECOMMENDATIONS CONTAINED HEREIN ARE BASED ON TESTS WE BELIEVE TO BE RELIABLE, BUT THE ACCURACY OR COMPLETENESS THEREOF IS NOT GUARANTEED, AND THE FOLLOWING IS MADE IN LIEU OF ALL WARRANTIES, EXPRESSED OR IMPLIED:

SELLER'S AND MANUFACTURER'S ONLY OBLIGATION SHALL BE TO REPLACE SUCH QUANTITY OF THE PRODUCT PROVED TO BE DEFECTIVE. NEITHER SELLER NOR MANUFACTURER SHALL BE LIABLE FOR ANY INJURY, LOSS OR DAMAGE, DIRECT OR CONSEQUENTIAL, ARISING OUT OF THE USE OF OR THE INABILITY TO USE THE PRODUCT. BEFORE USING, USER SHALL DETERMINE THE SUITABILITY OF THE PRODUCT FOR HIS INTENDED USE, AND USER ASSUMES ALL RISK AND LIABILITY WHATSOEVER IN CONNECTION THEREWITH. NO STATEMENT OR RECOMMENDATION NOT CONTAINED HEREIN SHALL HAVE ANY FORCE OR EFFECT UNLESS IN AN AGREEMENT SIGNED BY OFFICERS OR SELLER AND MANUFACTURER.

Date Issued: August 5, 1997

TS-0429-07  
Sheet 1 of 2

## Physical

### Insulation

Material: Glass Filled Polyester (PBT)  
Flammability: UL 94V-0  
Color: Gray

### Contact

Material: Phosphor Bronze  
Plating  
Underplate: 79  $\mu$ " (2.00  $\mu$ m) Nickel — QQ-N-290, Class 2  
Wiping Area: 15  $\mu$ " (0.38  $\mu$ m) Gold — MIL-G-45204, Type II, Grade C  
Solder Tails: 200  $\mu$ " (5.08  $\mu$ m) 60/40 Tin Lead — MIL-P-81728

## Electrical

**Current Rating:** 3 A  
**Insulation Resistance:**  $> 1 \times 10^{12} \Omega$  at 1000 Vdc  
**Withstanding Voltage:** 1000 Vrms at Sea Level  
**Contact Resistance:**  $< 15$  Milliohms

## Environmental

**Temperature Rating:**  $-55^{\circ}\text{C}$  to  $+125^{\circ}\text{C}$

UL File No.: E68080

### 3M Electronic Products Division

6801 River Place Blvd.  
Austin, TX 78726-9000

For technical, sales or ordering information call  
**800-225-5373**

### 2 Row Type Q (Rows A & B Filled)

7164 Series

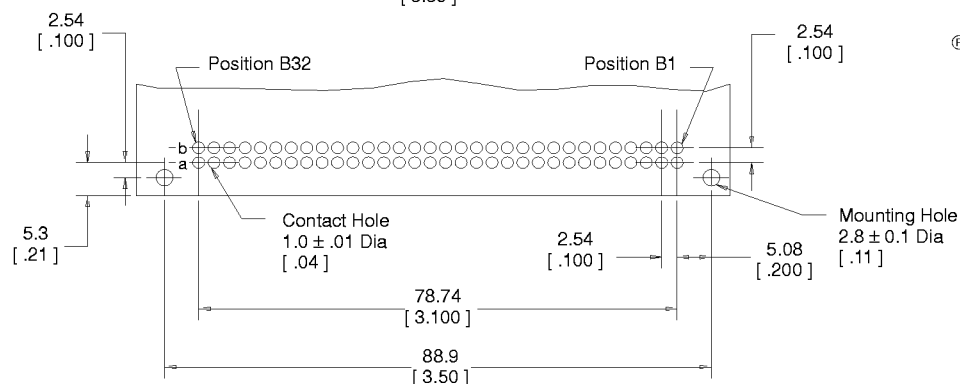
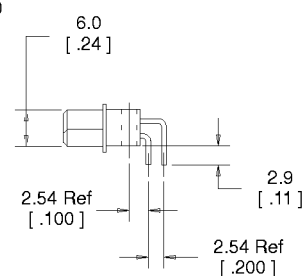
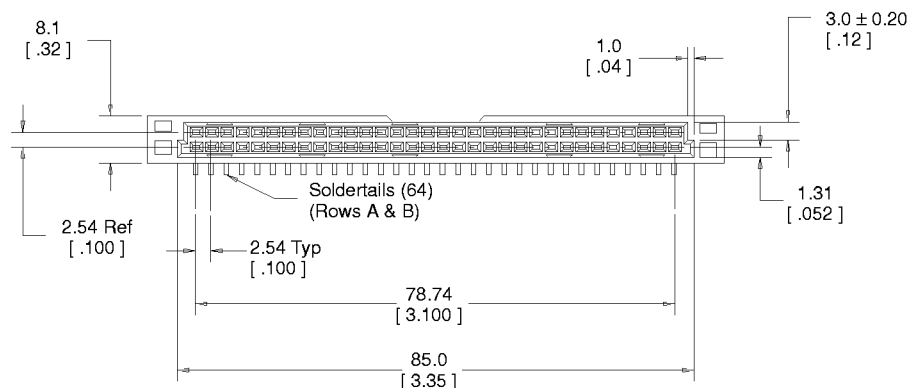
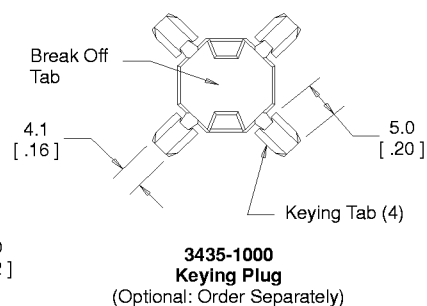
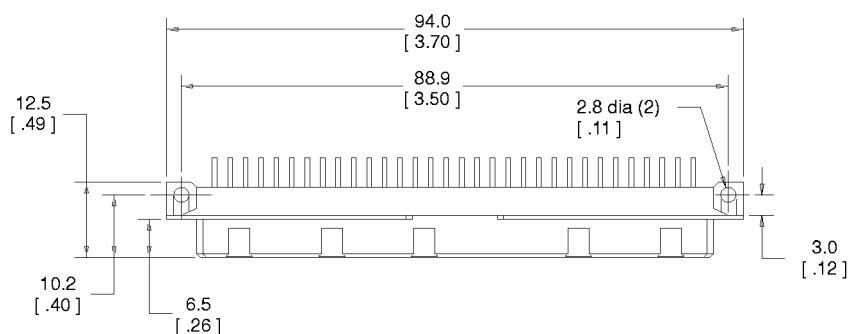

Recommended Hole Pattern  
(Shown for Mounting Side of Board)

mm [Inch]			
Tolerance Unless Noted			
	.0	.00	.000
1mm	± .3	± .13	

[ ] Dimensions for Reference only

## Ordering Information

**Inverse Din 41612**  
Right Angle Boardmount Socket  
**7164-50B2TH**

**Keying Plug**  
(Order Separately)  
**3435-1000**

TS-0429-07  
Sheet 2 of 2

### 3M Electronic Products Division

6801 River Place Blvd.  
Austin, TX 78726-9000

For technical, sales or ordering information call  
**800-225-5373**