



Series 8XXX Collet Elevator Sockets on .200 [5.08] Centers

FEATURES:

- Ideal for elevating devices (displays, switches, etc.) to desired level with .285 to 1.250 [7.24 to 31.75] height extension.

SPECIFICATIONS:

- Standard socket body and spacer are black UL 94V-0 Glass Filled 4/6 Nylon.
- Pin body is Brass Alloy 360 1/2 hard per UNS C36000 ASTM-B16-00.
- Pin body plating either 200μ [5.08μm] min. 93/7 Tin/Lead per ASTM B545 or 200μ [5.08μm] min. Tin per ASTM B545 Type 1 over 100μ [2.54μm] min. Nickel per SAE-AMS-QQ-N-290.
- 4-fingered collet contact is Beryllium Copper Alloy per UNS C17200 ASTM-B194-01.
- Contact plating is 30μ [7.7μm] min. Gold per MIL-G-45204 over 50μ [1.27μm] min. Nickel per SAE-AMS-QQ-N-290.
- Contact current rating=3 Amps.
- Operating temperature=-67°F to 221°F [-55°C to 105°C].
- Insertion Force=180 grams/pin; Withdrawal Force=90 grams/pin; Normal Force=140 grams/pin; based on a .018 [.46] diameter test lead.
- Accepts leads .015-.025 [.38-.64] in diameter, .110-.150 [2.79-3.81] long.

MOUNTING CONSIDERATIONS:

- Suggested PCB hole size=.035 ± .002 [.89 ± .05] dia.

ALL DIMENSIONS: INCHES [MILLIMETERS]

All tolerances ± .005 [.13] unless otherwise specified

"A"=NO. OF PINS PER ROW X .100 [2.54]

"B"=(NO. OF PINS PER ROW - 1) X .100 [2.54]

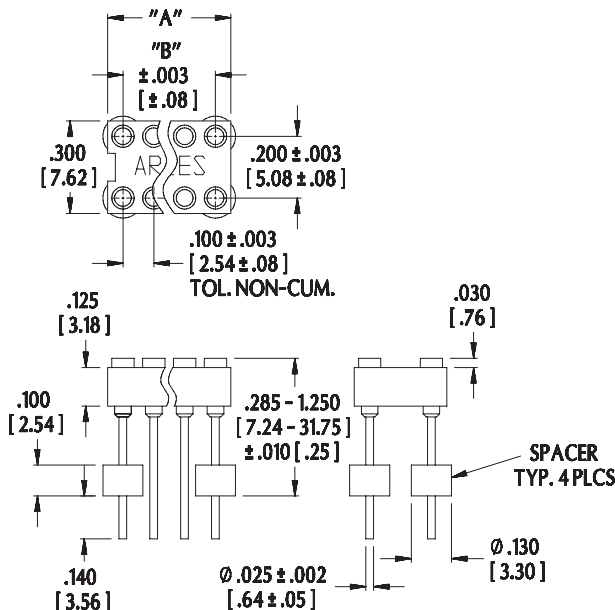

Note: Aries specializes in custom design and production. In addition to the standard products shown on this page, special materials, platings, sizes, and configurations can be furnished, depending on quantities. Aries reserves the right to change product specifications without notice.

ORDERING INFORMATION

XX-8XXXX-210CXX

No. of pins
6, 8, 10

Series

Seating plane height
.285 [7.24] to 1.250 [31.75]

ex: .285 height = "-8285-"
1.250 height = "-81250-"

Optional suffix:
TL=Tin/Lead
plated solder tail
pin

Collet style

Tin plated
solder tail pin
Row-to-row
spacing

Consult Data Sheet No. 13008 for
collet elevator sockets on .300
[7.62] and .600 [15.24] centers.

Consult Data Sheet No. 13006 for
elevator sockets with bifurcated
contacts.

CONTACT DETAIL

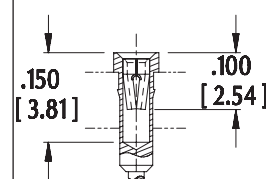

ARIES
ELECTRONICS, INC.
<http://www.arieselec.com> • info@arieselec.com

NORTH AMERICA
Frenchtown, NJ USA
TEL: (908) 996-6841
FAX: (908) 996-3891



EUROPE
TEL: +44 870 240 0249
FAX: +44 871 919 6033
europa@arieselec.com



13007
REV.E