

# SMT High Current Toroid Inductors

## Special Features

- DC/DC converter, EMI filter applications
- Low radiation
- Low core loss
- High current capacity
- Ideal for reflow soldering
- Low cost
- Operating temperature -55 to +105 °C

## Notes

- \* Current to cause 30 °C max. temperature rise

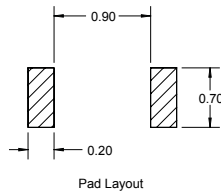
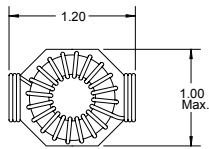

Dimensions: Inches

| PM2120 Series  |                            |             |                              |                    |                   |
|----------------|----------------------------|-------------|------------------------------|--------------------|-------------------|
| Part Number    | L (μH)<br>@ 1 KHz<br>±20 % | Idc*<br>(A) | L (μH)<br>@ Rated I<br>±20 % | DCR<br>(Ω)<br>Max. | Dim.<br>A<br>Max. |
| PM2120-1R0M-RC | 1.0                        | 25.4        | 0.9                          | 0.002              | 0.82              |
| PM2120-1R2M-RC | 1.2                        | 25.4        | 1.1                          | 0.002              | 0.82              |
| PM2120-1R5M-RC | 1.5                        | 22.0        | 1.3                          | 0.003              | 0.82              |
| PM2120-1R8M-RC | 1.8                        | 22.0        | 1.5                          | 0.003              | 0.82              |
| PM2120-2R2M-RC | 2.2                        | 19.7        | 1.8                          | 0.003              | 0.82              |
| PM2120-2R7M-RC | 2.7                        | 19.7        | 2.2                          | 0.003              | 0.82              |
| PM2120-3R3M-RC | 3.3                        | 18.0        | 2.6                          | 0.004              | 0.82              |
| PM2120-3R9M-RC | 3.9                        | 18.0        | 3.1                          | 0.004              | 0.82              |
| PM2120-4R7M-RC | 4.7                        | 16.6        | 3.7                          | 0.005              | 0.82              |
| PM2120-5R6M-RC | 5.6                        | 15.6        | 4.2                          | 0.005              | 0.82              |
| PM2120-6R8M-RC | 6.8                        | 14.7        | 5.0                          | 0.006              | 0.82              |
| PM2120-8R2M-RC | 8.2                        | 14.7        | 6.1                          | 0.006              | 0.82              |
|                | ±10 %                      |             | ±10 %                        |                    |                   |
| PM2120-100K-RC | 10                         | 13.9        | 7.2                          | 0.007              | 0.82              |
| PM2120-120K-RC | 12                         | 12.7        | 8.3                          | 0.008              | 0.82              |
| PM2120-150K-RC | 15                         | 12.2        | 10.2                         | 0.009              | 0.82              |
| PM2120-180K-RC | 18                         | 11.8        | 12.0                         | 0.009              | 0.82              |
| PM2120-220K-RC | 22                         | 11.0        | 14.2                         | 0.011              | 0.82              |
| PM2120-270K-RC | 27                         | 10.4        | 16.9                         | 0.012              | 0.82              |
| PM2120-330K-RC | 33                         | 10.1        | 20.3                         | 0.013              | 0.82              |
| PM2120-390K-RC | 39                         | 9.6         | 23.3                         | 0.014              | 0.82              |
| PM2120-470K-RC | 47                         | 8.2         | 29.2                         | 0.019              | 0.79              |
| PM2120-560K-RC | 56                         | 7.9         | 33.9                         | 0.021              | 0.79              |
| PM2120-680K-RC | 68                         | 6.7         | 42.2                         | 0.029              | 0.77              |
| PM2120-820K-RC | 82                         | 6.4         | 49.5                         | 0.032              | 0.87              |
| PM2120-101K-RC | 100                        | 6.1         | 58.7                         | 0.035              | 0.87              |
| PM2120-121K-RC | 120                        | 5.8         | 68.1                         | 0.039              | 0.87              |
| PM2120-151K-RC | 150                        | 5.5         | 82.5                         | 0.043              | 0.87              |
| PM2120-181K-RC | 180                        | 5.3         | 96.2                         | 0.047              | 0.83              |
| PM2120-221K-RC | 220                        | 5.0         | 113.7                        | 0.052              | 0.83              |
| PM2120-271K-RC | 270                        | 4.2         | 144.5                        | 0.072              | 0.80              |
| PM2120-331K-RC | 330                        | 3.6         | 183.4                        | 0.100              | 0.78              |
| PM2120-391K-RC | 390                        | 3.5         | 211.6                        | 0.108              | 0.78              |
| PM2120-471K-RC | 470                        | 3.3         | 247.1                        | 0.119              | 0.85              |
| PM2120-561K-RC | 560                        | 3.2         | 285.8                        | 0.130              | 0.85              |
| PM2120-681K-RC | 680                        | 3.0         | 336.3                        | 0.142              | 0.85              |
| PM2120-821K-RC | 820                        | 2.9         | 392.5                        | 0.157              | 0.85              |
| PM2120-102K-RC | 1000                       | 2.5         | 499.7                        | 0.215              | 0.82              |

Available only as RoHS compliant beginning July 2007.

When ordering non-RoHS compliant versions before July 2007, do not include the -RC suffix in the part number.

**BOURNS®**

Tel. (877) 426-8767 • Fax (951) 781-5006

www.bourns.com