



Features

- Formerly *JW.Miller* model
- Available in E12 series
- Small design of only 7.8 mm maximum diameter
- RoHS compliant*

Applications

- Input/output of DC/DC converters
- Power supplies for:
 - Portable communication equipment
 - Camcorders
 - LCD TVs
 - Car radios

PM75 Series - SMD Power Inductor

Electrical Specifications

| Bourns Part No. | Inductance 1 kHz | | Q Ref. | Test Frequency (MHz) | SRF Min. (MHz) | RDC (Ω) | I rms Max. (A) | I sat Typ. (A) |
|-----------------|------------------|----------|--------|----------------------|----------------|------------------|----------------|----------------|
| | (μ H) | Tol. % | | | | | | |
| PM75-100K-RC | 10 | ± 10 | 25 | 2.52 | 22 | 0.07 | 2.30 | 3.20 |
| PM75-120K-RC | 12 | ± 10 | 25 | 2.52 | 20 | 0.08 | 2.00 | 3.00 |
| PM75-150K-RC | 15 | ± 10 | 25 | 2.52 | 16 | 0.09 | 1.80 | 2.70 |
| PM75-180K-RC | 18 | ± 10 | 20 | 2.52 | 15 | 0.10 | 1.60 | 2.60 |
| PM75-220K-RC | 22 | ± 10 | 20 | 2.52 | 13 | 0.11 | 1.50 | 2.30 |
| PM75-270K-RC | 27 | ± 10 | 20 | 2.52 | 12 | 0.12 | 1.30 | 2.10 |
| PM75-330K-RC | 33 | ± 10 | 15 | 2.52 | 10 | 0.14 | 1.20 | 1.90 |
| PM75-390K-RC | 39 | ± 10 | 15 | 2.52 | 10 | 0.16 | 1.10 | 1.70 |
| PM75-470K-RC | 47 | ± 10 | 15 | 2.52 | 9 | 0.20 | 1.00 | 1.60 |
| PM75-560K-RC | 56 | ± 10 | 15 | 2.52 | 9 | 0.24 | 0.94 | 1.50 |
| PM75-680K-RC | 68 | ± 10 | 15 | 2.52 | 8 | 0.30 | 0.85 | 1.30 |
| PM75-820K-RC | 82 | ± 10 | 12 | 2.52 | 7 | 0.37 | 0.78 | 1.20 |
| PM75-101K-RC | 100 | ± 10 | 12 | 0.796 | 7 | 0.45 | 0.72 | 1.10 |
| PM75-121K-RC | 120 | ± 10 | 12 | 0.796 | 7 | 0.48 | 0.68 | 1.00 |
| PM75-151K-RC | 150 | ± 10 | 12 | 0.796 | 6 | 0.68 | 0.58 | 0.85 |
| PM75-181K-RC | 180 | ± 10 | 12 | 0.796 | 6 | 0.77 | 0.51 | 0.80 |
| PM75-221K-RC | 220 | ± 10 | 12 | 0.796 | 5 | 0.96 | 0.49 | 0.80 |
| PM75-271K-RC | 270 | ± 10 | 12 | 0.796 | 5 | 1.11 | 0.42 | 0.66 |
| PM75-331K-RC | 330 | ± 10 | 12 | 0.796 | 5 | 1.26 | 0.40 | 0.58 |
| PM75-391K-RC | 390 | ± 10 | 12 | 0.796 | 4 | 1.77 | 0.36 | 0.55 |
| PM75-471K-RC | 470 | ± 10 | 12 | 0.796 | 4 | 1.96 | 0.34 | 0.50 |

Typical Part Marking

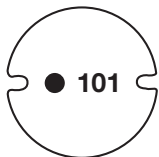

Electrical Schematic

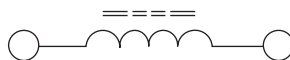

General Specifications

Test Frequency 1 KHz
 Test Voltage 1 V
 Reflow Soldering .. 230 °C, 50 sec. max.
 Operating Temperature
 -40 °C to +125 °C
 (Temperature rise included)
 Storage Temperature .. -40 °C to +125 °C
 Resistance to Soldering Heat
 260 °C for 5 sec.

Materials

Core Ferrite DR core
 Wire Enameled copper wire
 Terminal Ag/Ni/Sn
 Rated Current
 Ind. drop 10 % typ. at Isat
 Temperature Rise
 40°C max. at rated Irms
 Packaging 500 pcs. per reel

Product Dimensions

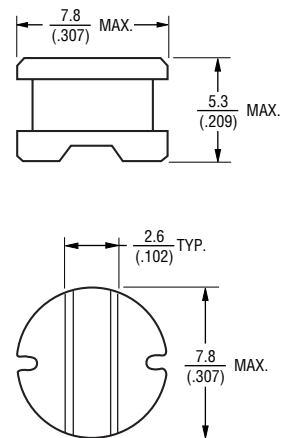

Recommended Layout

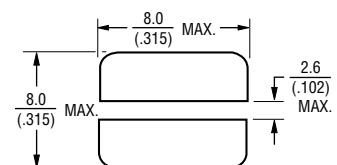

DIMENSIONS: $\frac{\text{MM}}{\text{(INCHES)}}$

*RoHS Directive 2002/95/EC Jan. 27, 2003 including annex and RoHS Recast 2011/65/EU June 8, 2011. Specifications are subject to change without notice. Customers should verify actual device performance in their specific applications.

PM75 Series - SMD Power Inductor

BOURNS®

Packaging Specifications

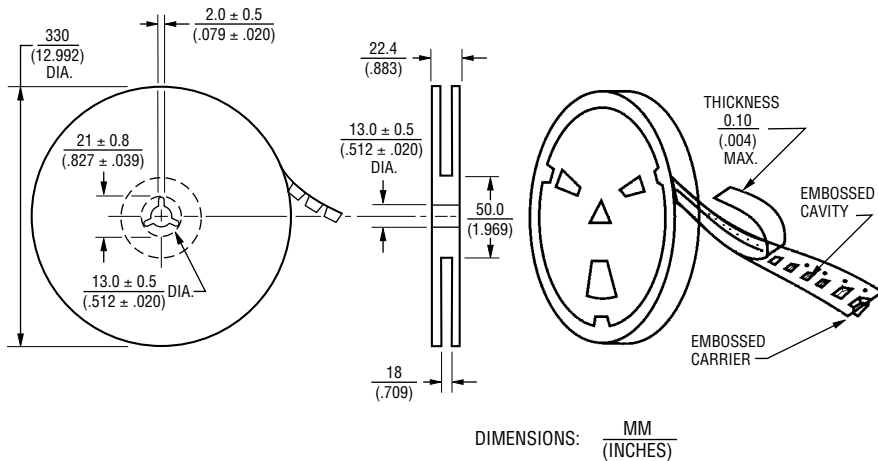

Materials

Paper
Plastics

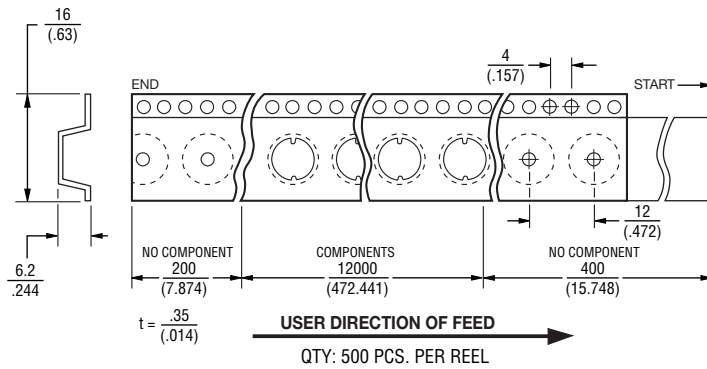

Strength of Cover Tape

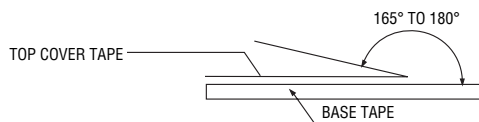

The force for tearing off cover tape is 10 to 130 grams in the arrow direction.

REV. 05/12

Specifications are subject to change without notice.
Customers should verify actual device performance in their specific applications.