

Radial Lead RF Chokes

Special Features

- High current capacity
- Ferrite bobbin core
- Low core loss at frequency
- High reliability, efficiency
- Small package size
- Fixed lead spacing
- Operating temperature -30 to +100°C
- Current to cause maximum 10% of inductance drop, or 40°C temperature rise

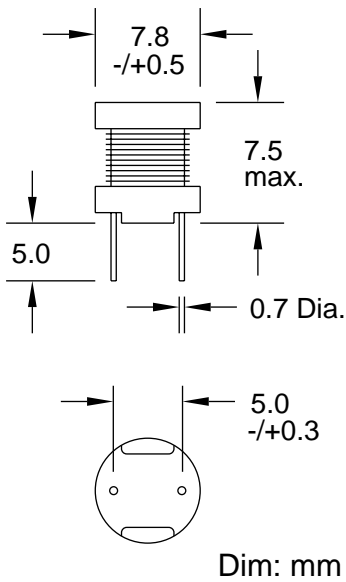

| RL875 Series | | | | |
|--------------|----------------------|------------|--------------------------|----------------------|
| Part Number | L (uH) $\pm 20\%$ | Test Freq. | DCR (Ω) Max. | I _{DC} (mA) |
| RL875-100M | 10 | 2.52 MHz | 0.05 | 2900 |
| RL875-120M | 12 | 2.52 MHz | 0.06 | 2500 |
| | $\pm 10\%$ | | | |
| RL875-150K | 15 | 2.52 MHz | 0.07 | 2200 |
| RL875-180K | 18 | 2.52 MHz | 0.08 | 1900 |
| RL875-220K | 22 | 2.52 MHz | 0.09 | 1800 |
| RL875-270K | 27 | 2.52 MHz | 0.11 | 1700 |
| RL875-330K | 33 | 2.52 MHz | 0.13 | 1500 |
| RL875-390K | 39 | 2.52 MHz | 0.14 | 1300 |
| RL875-470K | 47 | 2.52 MHz | 0.15 | 1300 |
| RL875-560K | 56 | 2.52 MHz | 0.18 | 1200 |
| RL875-680K | 68 | 2.52 MHz | 0.20 | 1100 |
| RL875-820K | 82 | 2.52 MHz | 0.24 | 1000 |
| RL875-101K | 100 | 1 KHz | 0.28 | 890 |
| RL875-120K | 120 | 1 KHz | 0.36 | 810 |
| RL875-151K | 150 | 1 KHz | 0.42 | 720 |
| RL875-181K | 180 | 1 KHz | 0.57 | 660 |
| RL875-221K | 220 | 1 KHz | 0.63 | 570 |
| RL875-271K | 270 | 1 KHz | 0.88 | 510 |
| RL875-331K | 330 | 1 KHz | 1.05 | 460 |
| RL875-391K | 390 | 1 KHz | 1.17 | 440 |
| RL875-471K | 470 | 1 KHz | 1.34 | 410 |
| RL875-561K | 560 | 1 KHz | 1.72 | 360 |
| RL875-681K | 680 | 1 KHz | 1.96 | 330 |
| RL875-821K | 820 | 1 KHz | 2.56 | 300 |
| RL875-102K | 1000 | 1 KHz | 2.94 | 270 |
| RL875-122K | 1200 | 1 KHz | 4.04 | 240 |
| RL875-152K | 1500 | 1 KHz | 4.70 | 220 |
| RL875-182K | 1800 | 1 KHz | 5.05 | 200 |
| RL875-222K | 2200 | 1 KHz | 6.25 | 180 |
| RL875-272K | 2700 | 1 KHz | 8.72 | 160 |
| RL875-332K | 3300 | 1 KHz | 10.6 | 150 |
| RL875-392K | 3900 | 1 KHz | 14.2 | 140 |
| RL875-472K | 4700 | 1 KHz | 16.7 | 120 |
| RL875-562K | 5600 | 1 KHz | 18.7 | 110 |
| RL875-682K | 6800 | 1 KHz | 21.8 | 100 |
| RL875-822K | 8200 | 1 KHz | 28.7 | 93 |
| RL875-103K | 10,000 | 1 KHz | 33.0 | 84 |

J.W. Miller
M A G N E T I C S

306 E. Alondra Blvd., Gardena, CA 90247-1059 • (310) 515-1720 • FAX (310) 515-1962

www.jwmiller.com