

SMT High Current Toroid Inductors

Special Features

- DC/DC converter, EMI filter applications
- Low radiation
- Low core loss
- High current capacity
- Ideal for reflow soldering
- Low cost
- Operating temperature -55 to +105 °C

Notes

* Current to cause 30 °C max. temperature rise

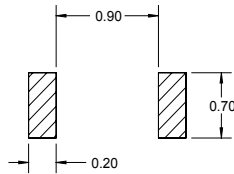
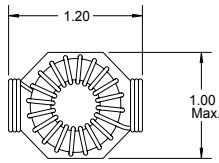

Pad Layout



Dimensions: Inches

PM2110 Series					
Part Number	L (μH) @ 1 KHz ±20 %	Idc* (A)	L (μH) @ Rated I ±20 %	DCR (Ω) Max.	Dim. A Max.
PM2110-1R0M-RC	1.0	22.7	0.8	0.002	0.57
PM2110-1R2M-RC	1.2	20.3	1.0	0.002	0.57
PM2110-1R5M-RC	1.5	20.3	1.2	0.002	0.57
PM2110-1R8M-RC	1.8	18.5	1.4	0.003	0.57
PM2110-2R2M-RC	2.2	17.2	1.7	0.003	0.57
PM2110-2R7M-RC	2.7	16.0	2.0	0.004	0.57
PM2110-3R3M-RC	3.3	16.0	2.5	0.004	0.57
PM2110-3R9M-RC	3.9	15.1	2.8	0.004	0.57
PM2110-4R7M-RC	4.7	14.4	3.4	0.004	0.57
PM2110-5R6M-RC	5.6	13.7	3.9	0.005	0.57
PM2110-6R8M-RC	6.8	13.1	4.6	0.005	0.57
PM2110-8R2M-RC	8.2	12.6	5.5	0.006	0.57
	±10 %		±10 %		
PM2110-100K-RC	10	11.7	6.5	0.007	0.57
PM2110-120K-RC	12	11.3	7.6	0.007	0.57
PM2110-150K-RC	15	10.7	9.2	0.008	0.57
PM2110-180K-RC	18	10.2	10.7	0.009	0.57
PM2110-220K-RC	22	9.7	12.7	0.010	0.57
PM2110-270K-RC	27	8.2	16.0	0.014	0.54
PM2110-330K-RC	33	7.0	20.1	0.019	0.52
PM2110-390K-RC	39	6.8	23.2	0.020	0.62
PM2110-470K-RC	47	6.5	27.2	0.022	0.62
PM2110-560K-RC	56	6.2	31.6	0.024	0.62
PM2110-680K-RC	68	5.9	37.1	0.027	0.62
PM2110-820K-RC	82	5.6	43.4	0.029	0.62
PM2110-101K-RC	100	5.4	51.4	0.032	0.62
PM2110-121K-RC	120	5.1	59.6	0.035	0.62
PM2110-151K-RC	150	4.3	77.3	0.049	0.59
PM2110-181K-RC	180	3.7	96.3	0.066	0.53
PM2110-221K-RC	220	3.5	113.8	0.074	0.60
PM2110-271K-RC	270	3.4	134.9	0.082	0.60
PM2110-331K-RC	330	3.2	159.5	0.090	0.60
PM2110-391K-RC	390	3.1	182.9	0.098	0.60
PM2110-471K-RC	470	2.6	230.4	0.133	0.57
PM2110-561K-RC	560	2.5	266.0	0.146	0.57
PM2110-681K-RC	680	2.1	337.1	0.202	0.54
PM2110-821K-RC	820	2.0	394.1	0.221	0.60
PM2110-102K-RC	1000	1.9	463.7	0.244	0.60

Available only as RoHS compliant beginning July 2007.

When ordering non-RoHS compliant versions before July 2007, do not include the -RC suffix in the part number.