

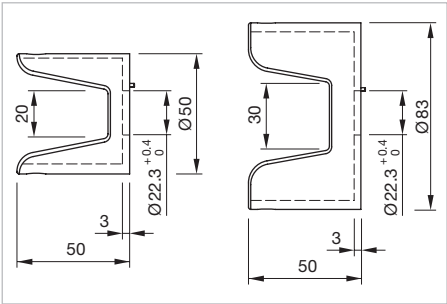

E-stop protective shroud, IP65

- Additional Information**
- Use only for Part No. 704.064.2 und 704.066.2
 - The protection shroud is not suitable for a proper use of emergency-stop. It can obstruct a spontaneous operation of the emergency-stop



Dimensions [mm]

Dimension	Material	Colour	Standard	Part No.	Weight
 E-stop protective shroud					
Ø 50 mm	Plastic	yellow		704.927.8	0.052 kg
 E-stop protective shroud					
Ø 83 mm	Plastic	yellow	SEMI S2-93/12.4.c	704.927.9	0.067 kg