

TOP VIEW

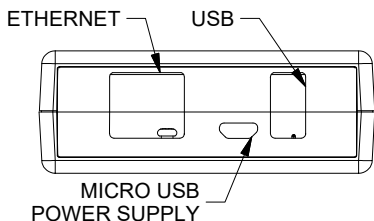

YUN FRONT VIEW

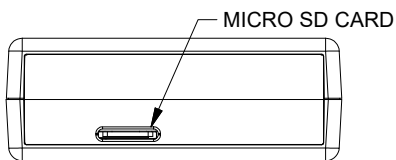

YUN BACK VIEW

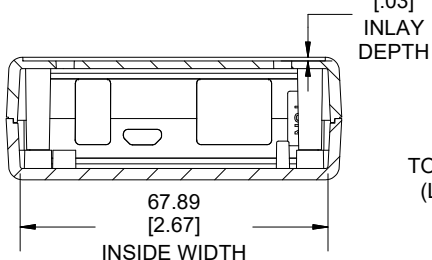

SECTION B-B

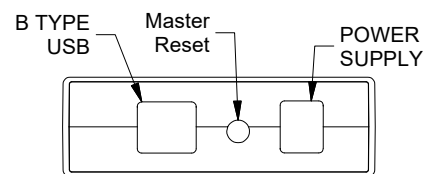

UNO/101 PANEL

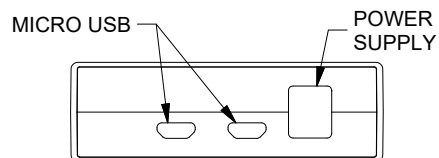

**LEONARDO /
M0 PRO
PANEL**

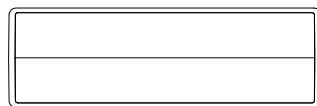

**BACK COVER
PANEL**

NOTE:
PANELS CAN BE SWAPPED OUT
TO ACCOMMODATE ARDUINO BOARDS
(LEONARDO, YUN, UNO, M0 PRO, 101)

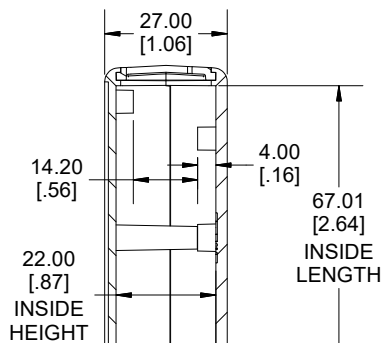

SECTION A-A

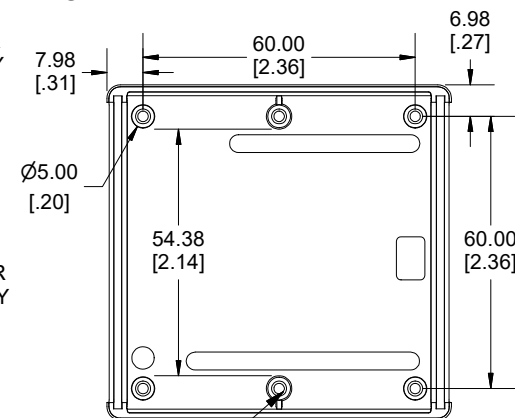

INSIDE TOP

ACCEPTS #4
SELF-TAPPING
SCREW

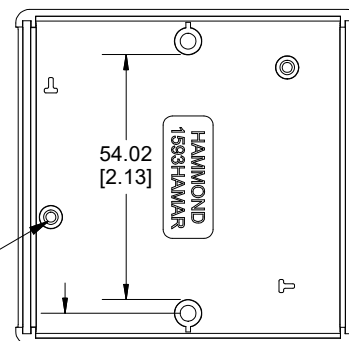

INSIDE BOTTOM

ACCEPTS M2.6
SELF-TAPPING
SCREW

Dimensions:
mm
[inches]

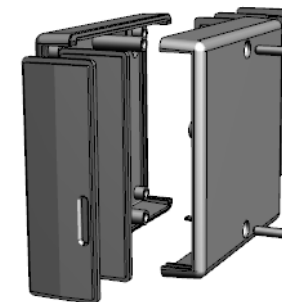

Enclosures can be Factory Modified (Milling, Drilling, Printing etc.)
Contact Factory (modshop@hammondmfg.com) for quotes
Solid models of this enclosure available in .stp or .x_t
(Part number and text placement/orientation on our products are subject to change,
we do not recommend using them as a locating reference for modification purposes)

NOTE

Purchased assembly includes top and bottom cover, 3 front panels (works with Arduino YUN, UNO/101, Leonardo / M0 PRO), 2 rear Panels (one blank and one that works with YUN micro SD card), 2 cover screws, 2 screws to secure Arduino board and 4 rubber feet.

Recommended Cover Screw Torque - 57lbf-in (40cN-m)

PART NUMBERS

1593HAMAR2		
Translucent Blue Enclosure		1593HAMAR2TBU
ACCESSORIES		
Cover Screws #4 X 1/2" Self-Tapping (100 Pkg)		1591TS100
		1591TS100BK (Black)
P.C. Board Screws M2.6 X 6mm Self-Tapping		SC519-50 (Pkg 50)
Clear Rubber Feet (Pkg 24)		1421T6CL
1593AR STD FLAT PANEL (SINGLE PANEL)	Translucent Blue	1593ARL1TBU-B
1593AR STD CONTOURED PANEL (SINGLE PANEL)	Translucent Blue	1593ARL2TBU-B
1593HAMAR UNO PANEL KIT (FRONT & REAR PANEL)	Translucent Blue	1593ARL3TBU-B
1593HAMAR YUN PANEL KIT (FRONT & REAR PANEL)	Translucent Blue	1593ARL4TBU-B
1593HAMAR LEO/M0 PRO PANEL KIT (FRONT & REAR PANEL)	Translucent Blue	1593ARL6TBU-B
1593HAMAR 101 PANEL KIT (FRONT & REAR PANEL)	Translucent Blue	1593ARL7TBU-B

**HAMMOND
MANUFACTURING**
1593HAMAR2
www.hammondmfg.com