

# FUSE CLIPS & HOLDERS

## 9/32 FUSE CLIP

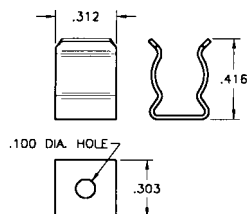

.020 Brass, Nickel Plate  
Current Rating: 15 Amps



CAT. NO. 3565

## 13/32 PC FUSE CLIP



.028 Brass, Tin Plate  
Current Rating: 30 Amps

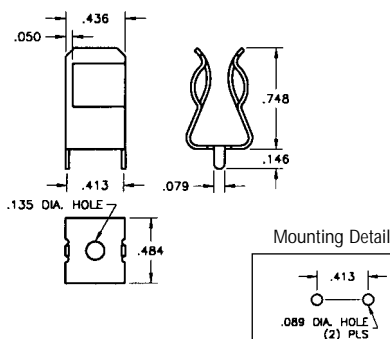

CAT. NO. 3566

## CUSTOM FUSE CLIPS & HOLDERS

Keystone is fully integrated  
to meet your total design  
& production needs.

Manufacturing custom designs  
& modifications of standard  
items is our specialty.

Quotations on special  
**fuse clips & holders**  
furnished promptly  
upon receipt of sample,  
sketch, print or CAD drawings.

## PC 5mm FUSE HOLDERS

### SLIM LINE & (OPTIONAL) COVER

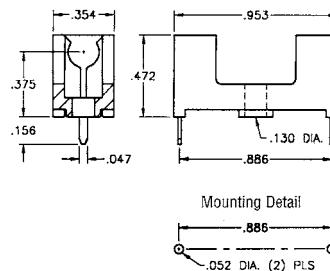
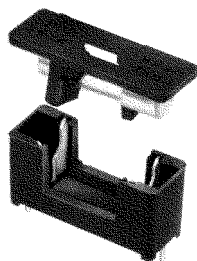

- Optional cover with window protects and insulates fuse

CAT. NO. 4628 – Holder  
CAT. NO. 4628C – Cover only (with window)

### SPECIFICATIONS

Base & Cover: Nylon, UL94V-0  
Contacts: Brass, Tin Plate  
Rated: 5 Amp @ 250V

### LOW PROFILE & (OPTIONAL) COVER

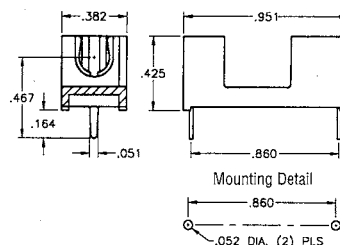
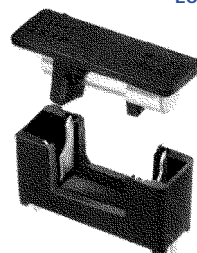

- Low profile, space saving design
- Optional cover protects and insulates fuse

CAT. NO. 4527 – Holder  
CAT. NO. 4527C – Cover only

### SPECIFICATIONS

Base & Cover: Nylon, UL94V-0  
Contacts: Brass, Tin Plate  
Rated: 5 Amp @ 250V

### PC SNAP-IN FUSE HOLDER

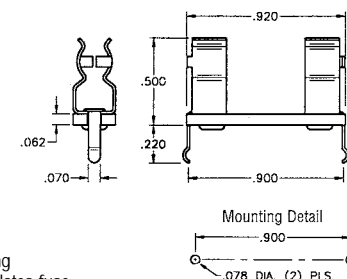

- Low profile, space saving design
- Snap-in design for wave soldering
- Optional cover protects and insulates fuse

CAT. NO. 3527 – Holder  
CAT. NO. 3527C – Vinyl cover only

### SPECIFICATIONS

Base: .062 G-10, UL Rated 94V-0  
Clips: Brass, Tin Plate  
Rated: 6.3 Amps @ 250V

## 5mm & 3AG FUSE COVERS



Vinyl

5mm

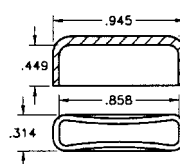

CAT. NO. 3527C

3AG

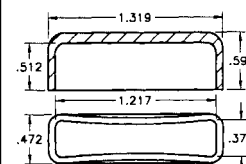

CAT. NO. 4245C

# 2AG & 5mm FUSE CLIPS

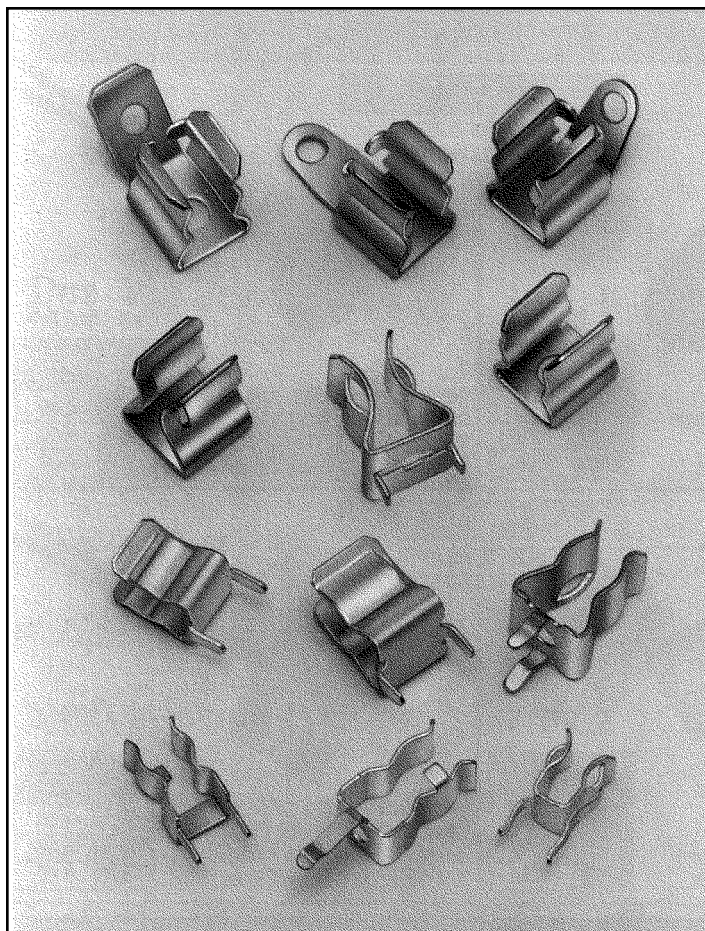

- PC thru mount and rivet types for 2AG, 5mm, 3AG, 9/32 & 13/32 fuse sizes
- Low contact resistance
- Withstands shock and vibration
- Rated 6.3 to 30 Amps
- Custom designs and modifications available to your specifications

## PC THRU MOUNT TYPES

- Available for 2AG, 5mm, 3AG & 13/32 sizes
- Low profile, space saving
- Snap-fit design enhances assembly and PC retention for wave soldering
- Available with orientation legs to assure proper PC installation
- Available with or without end stops

## RIVET TYPES

- Available for 3AG & 9/32 sizes
- Available with straight or 45° solder lugs
- Available with .187, .205 or .250 or quick fit tabs
- Low profile, space saving
- Available with or without end stops

## 5mm/3AG PC MULTI-FUSE CLIP



.016 Phosphor Bronze,  
Tin Plate  
Current Rating: 15 Amps

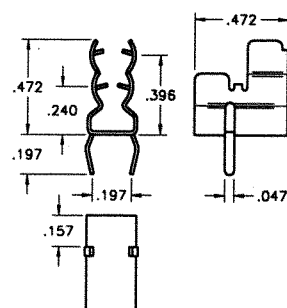

Mounting Detail



**CAT. NO. 3562**

## 5mm PC CLIP

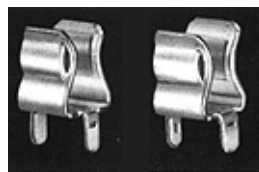

.020 Brass, Tin Plate  
Current Rating: 15 Amps

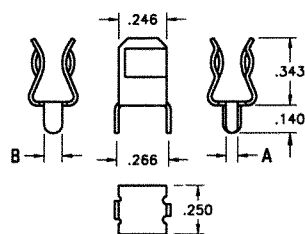

With or Without Orientation Legs

CAT. NO.	"A"	"B"
3517	.060	.060
3518P	.060	.093

**CAT. NO. 3520**

## 2AG/5mm THM/SMT FUSE CLIP

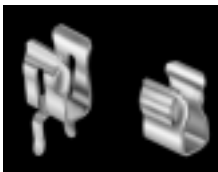

.016 Brass, Tin Plate  
Current Rating: 10 Amps

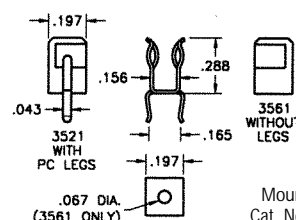

Mounting Detail  
Cat. No. 3521 Only



**CAT. NO. 3521** (THM with PC legs)

**CAT. NO. 3561** (SMT with Hole)

## 5mm PC CLIP



.016 Brass, Tin Plate  
Current Rating: 6.3 Amps

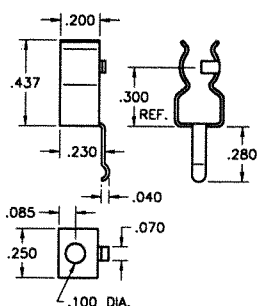

**CAT. NO. 3520**

## 5mm PC CLIP

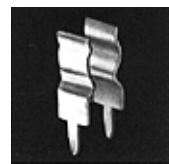

.016 Brass, Tin Plate  
Current Rating: 10 Amps

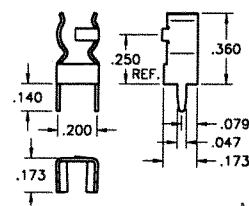

Mounting Detail



**CAT. NO. 3519**

# 3AG (.250") FUSE CLIPS

Designers' Choice



- Snap-In and Press-In design for wave soldering
- Low profile, space saving
- Available with orientation legs
- Available with and without end stops
- Low contact resistance
- Rated 15 Amps
- Economical and easy to assemble

## 3AG PC CLIP



.020 Brass, Tin Plate.  
For 1/4" dia. fuses

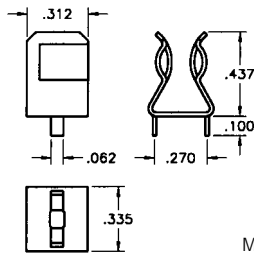

Mounting Detail

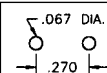

CAT. NO. 3530

## 3AG CLIP WITH SOLDER LUG



3533 3535

.020 Brass, Nickel Plate.  
For 1/4" dia. fuses

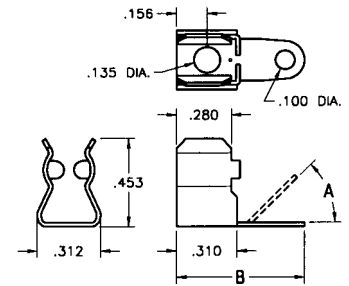

CAT. NO.	A	B
3533	Flat	.656
3535	45°	.562

## 3AG SNAP-IN PC CLIP

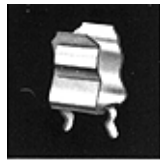

.020 Brass, Tin Plate.  
For 1/4" dia. fuses.

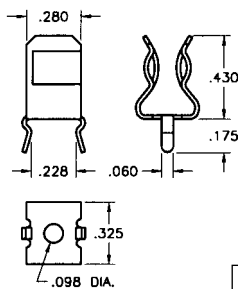

Mounting Detail

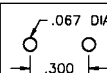

CAT. NO. 3513

## 3AG CLIPS WITH QUICK-FIT TAB



.020 Brass, Nickel Plate  
For 1/4" dia. fuses

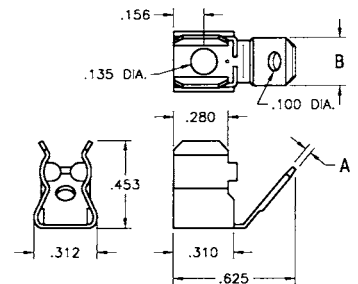

CAT. NO.	A	B
4244	.032	.250
4246	.020	.187
4247	.020	.205

## 3AG PC CLIPS



.020 Brass, Tin Plate. For 1/4" dia. fuses.

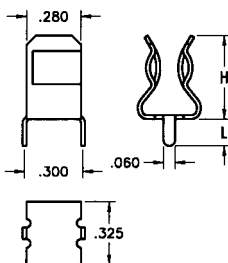

Mounting Detail

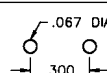

CAT. NO.	H	L	END STOPS
3510	.421	.140	NO
3529	.421	.140	YES
3511	.430	.250	NO
3514	.450	.250	YES

## 3AG FUSE CLIP



.020 Brass, Nickel Plate  
For 1/4" dia. fuses

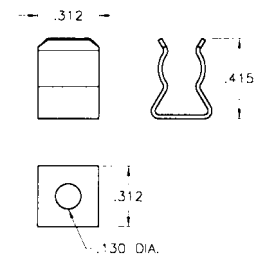

CAT. NO. 3531 – Without End Stops

## 3AG SNAP-IN PC CLIP

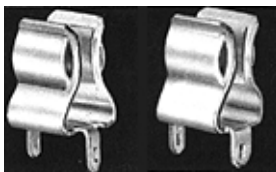

.020 Brass, Tin Plate. For 1/4" dia. fuses.

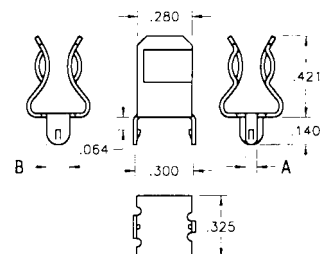

With or Without Orientation Legs

CAT. NO.	A	B
3515	.060	.060
3515P	.060	.093
3516P	.060	.120

## 3AG FUSE CLIP

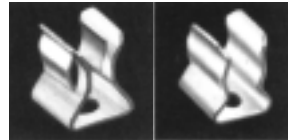

.020 Brass, Nickel Plate  
For 1/4" dia. fuses

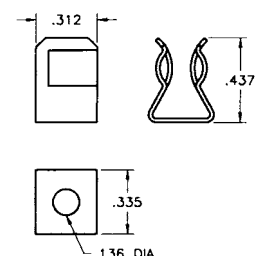

CAT. NO.	END STOPS
3532	YES
3567	NO