

P.C. MOUNTING

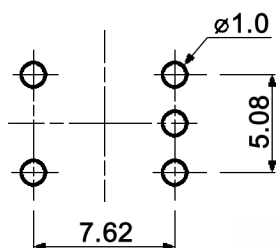

x	Switch function
D	on - on
E	on - off - on
F	mom - on
G	mom - off - mom
H	mom - off - on

Lever position:

For code F and H: "mom" is on the right side when looking at the marking side.

The closed contacts are opposite to the lever position.

Specifications:

Contact rating:	max.: 0.4VA, 48V AC/DC / max. 50mA min.: 1μA, 20mV AC/DC
Contact resistance:	50mOhm max.
Insulation resistance:	500MOhm min. at 250V DC
Dielectric strength:	50V, 50Hz for duration of 1 minute
Operating temperature:	-20°C to +85°C
Mechanical life:	min. 60 000 cycles
Soldering conditions:	auto-soldering: max.: 260 +/-5°C, 5 +/-1.0sec.
Mounting:	on pc-board
Contacts:	phosphor bronze gold plated over nickel barrier
Terminals:	PC terminals, crimped
Material:	Case: PBT, meets UL94V-0, washable Metal parts: nickel plated brass
UL file number:	E140532



Tolerances:			Date	Name	ATE 1 x-RA
			08/09	dr	
			knitter-switch		20 25 54
Modifications			Date	Name	Page
					1/1