



# PRODUCT DATASHEET

## Angelette series

last update 25/10/2016

### DETAILS

Product Number	F15176_ANGELETTE-LENS
Family	Angelette
Type	Sublens
Color	clear
Diameter	105,9 mm
Height	4,7 mm
Style	round
Optic Material	PMMA
Holder Material	
Fastening	clips
Status	production ready
ROHS Comliant	Yes
Date Updated	25/10/2016



### OPTICAL PROPERTIES

	Viewing	Light	Effi-		
LED	Angle	Beam	ciency	cd/lm	Connector
-	N/A deg		-	sim: 0.000	-

NOTE: Please ensure that the gate cutting area is not aligned with any of the reflectors retaining clips when assembling the lens in place.

ANGELETTE-LENS can be used together with all ANGELETTE family products where product order code is not ending with '-PLAIN'

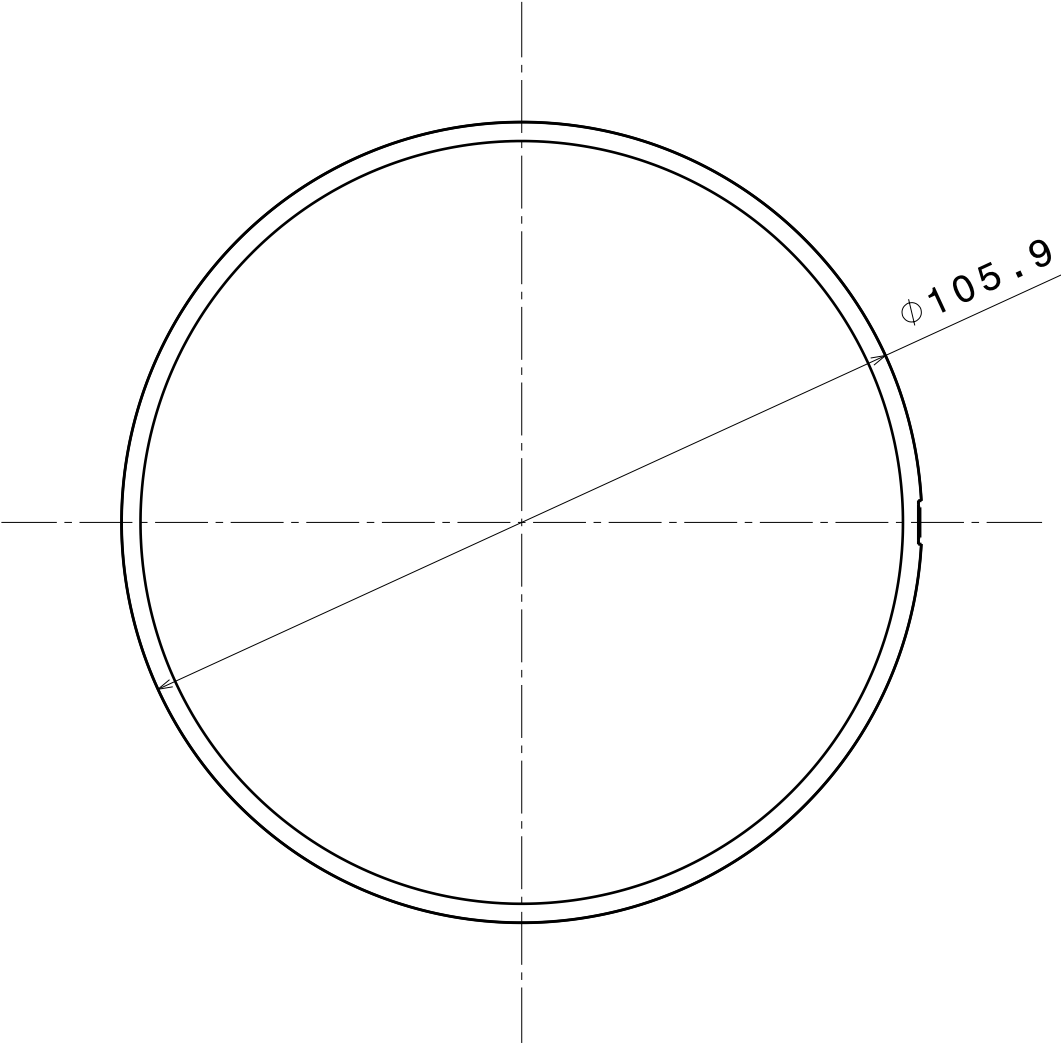

Front view  
Scale: 1:1

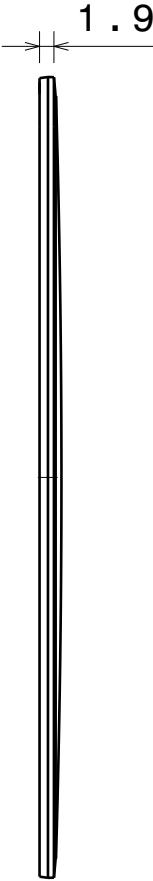

Left view  
Scale: 1:1

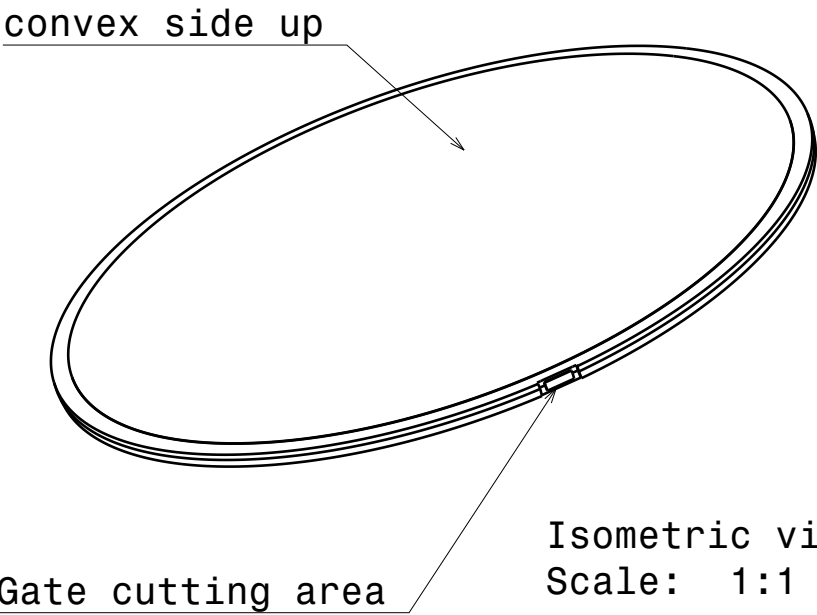

Isometric view  
Scale: 1:1

Tolerances if not otherwise shown  
According to DIN ISO 2768-1  
Linear measures:  
Up to 30mm class M, otherwise class C.  
According to DIN ISO 2768-2  
Form and position: class L

THIRD ANGLE PROJECTION:

This drawing is the property  
of LEDiL Oy. It may not be  
reproduced, copied or  
communicated without a written  
agreement with LEDiL Oy.

LEDiL		LediL Oy Salorankatu 10 FIN 24240 SALO Finland	
DRAWING TITLE DATASHEET_ANGELETTE - LENS			
SIZE A3	PART NUMBER F15176		
SCALE 1:1	WEIGHT		SHEET 1/1

**NOTE: The typical divergence will be changed by different color, chip size and chip position tolerance. The typical total divergence is the full angle measured where the luminous intensity is half of the peak value.**