

**Ordering number FCN10804_LED1_LR1-RS**

Family	Leila	FWHM	8 degrees
Type	-	Efficiency	96 %
LED	LUXEON Rebel	cd/lm	-
Color	White	Gerber File	Available
Diameter	21.6 mm		
Height	14.3 mm		
Style	Round		
Optic Material	PMMA		
Holder Material	PC		
Fastening	Glue		
Status	Ready		

**Ordering number FCN11738_LED1_LR1-RS2**

Family	Leila	FWHM	10 degrees
Type	-	Efficiency	93 %
LED	LUXEON Rebel	cd/lm	16.000
Color	White	Gerber File	Available
Diameter	21.6 mm		
Height	14.3 mm		
Style	Round		
Optic Material	PMMA		
Holder Material	PC		
Fastening	Glue		
Status	Ready		

**Ordering number FCN10806_LED1_LR1-D**

Family	Leila	FWHM	11 degrees
Type	-	Efficiency	96 %
LED	LUXEON Rebel	cd/lm	-
Color	White	Gerber File	Available
Diameter	21.6 mm		
Height	14.3 mm		
Style	Round		
Optic Material	PMMA		
Holder Material	PC		
Fastening	Glue		
Status	Ready		

**Ordering number FCN10803_LED1_LR1-M**

Family	Leila	FWHM	22 degrees
Type	-	Efficiency	91 %
LED	LUXEON Rebel	cd/lm	-
Color	White	Gerber File	Available
Diameter	21.6 mm		
Height	14.3 mm		
Style	Round		
Optic Material	PMMA		
Holder Material	PC		
Fastening	Glue		
Status	Ready		

**Ordering number FCN11458_LR1-M2**

Family	Leila	FWHM	30 degrees
Type	-	Efficiency	90 %
LED	LUXEON Rebel	cd/lm	-
Color	White	Gerber File	Available
Diameter	21.6 mm		
Height	14.3 mm		
Style	Round		
Optic Material	PMMA		
Holder Material	PC		
Fastening	Glue		
Status	Ready		

**Ordering number FCN10805_LR1-REC**

Family	Leila	FWHM	36+20 degrees
Type	-	Efficiency	92 %
LED	LUXEON Rebel	cd/lm	-
Color	White	Gerber File	Available
Diameter	21.6 mm		
Height	14.3 mm		
Style	Round		
Optic Material	PMMA		
Holder Material	PC		
Fastening	Glue		
Status	Ready		

**Ordering number FCN11106_LR1-O-90**

Family	Leila	FWHM	38+15.5 degrees
Type	-	Efficiency	96 %
LED	LUXEON Rebel	cd/lm	-
Color	White	Gerber File	Available
Diameter	21.6 mm		
Height	14.3 mm		
Style	Round		
Optic Material	PMMA		
Holder Material	PC		
Fastening	Glue		
Status	Ready		

**Ordering number FCN10890_LR1-W**

Family	Leila	FWHM	48 degrees
Type	-	Efficiency	94 %
LED	LUXEON Rebel	cd/lm	-
Color	White	Gerber File	Available
Diameter	21.6 mm		
Height	14.3 mm		
Style	Round		
Optic Material	PMMA		
Holder Material	PC		
Fastening	Glue		
Status	Ready		



PRODUCT DATASHEET

Leila series

last update 12/6/2013

PHILIPS
LUMILEDS

NOTE: The typical divergence will be changed by different color, chip size and chip position tolerance. The typical total divergence is the full angle measured where the luminous intensity is half of the peak value.



PRODUCT DATASHEET

Leila series

last update 12/6/2013

PHILIPS
LUMILEDS

GENERAL INFORMATION

- Product series especially designed & optimized for LUXEON Rebel series of LEDs.
- Special care taken to make light distribution as uniform as possible.
- Lens material optical grade PMMA with high UV and temperature resistance (105 degrees of Celcius / 220 degrees of Fahrenheit). Allows use of high current and temperature conditions.

Please find more information about used material from below:

http://ledil.fi/sites/default/files/Documents/Technical/Material/PMMA%20N%20UL94_Yellow%20Card.pdf

<http://ledil.fi/sites/default/files/Documents/Technical/Material/PMMA%20N%20PLEXIGLAS-Datasheet.pdf>

- Optic holder molded by high quality PC material (120 dergees of Celcius / 248 degrees of Fahrenheit).

- Fastening to PCB with appropriate adhesive. By clicking link below you can find Ledil recommended glue options.

http://www.ledil.com/datasheets/DataSheet_GLUES.pdf

NOTE 1: We advise customer to ensure the suitability and sufficiency of the bond in the end product. For example, mechanical stress, vibration and holes on the surface of the circuit board weaken the strength of the glue.

NOTE 2: All surfaces where glue is applied must be clean, dry and free from grease and dirt. If cleaning of PCB surfaces is needed, please follow strictly the cleaning instructions of your LED manufacturer -this is important as cleaning shall under no circumstances damage LEDs or other electronics components on the PCB.

Further note that optical components shall not be cleaned with any chemicals - only micro fiber cloth may be used to remove fingerprints or other traces from handling.

D

C

B

A

4

4

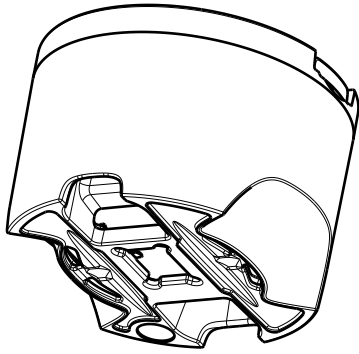

Isometric view

Oval beam direction

0-90 beam direction

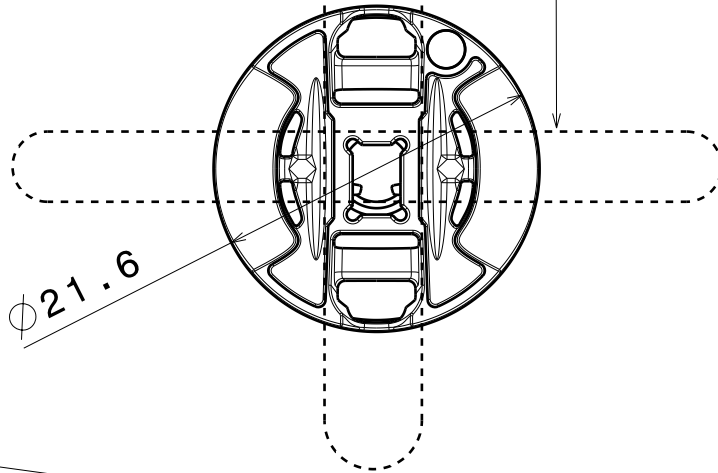

Bottom view

∅21.6

Lens

Holder LR-LH1

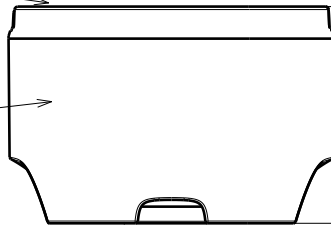

14.3

Front view

3

3

2

2

Material:
 Lens PMMA
 Holder PC

This drawing is our property.
 It can't be reproduced
 or communicated without
 our written agreement.



Ledil Oy
 Salorankatu 10
 FIN-24100 SALO
 Finland

DRAWING TITLE

Datasheet LR1 Assy

DRAWN BY

ah

DATE

20.12.2011

CHECKED BY

pv

DATE

20.12.2011

SIZE

A4

DRAWING NUMBER

REV

2

DESIGNED BY

pv

DATE

31.12.2009

SCALE

2:1

WEIGHT (g)

SHEET

1/1

D

A

1

1

Luminaire: Ledil Oy FA10804_LR1-RS FA10804_LR1-RS
Lamps: 1 x LUXEON REBEL

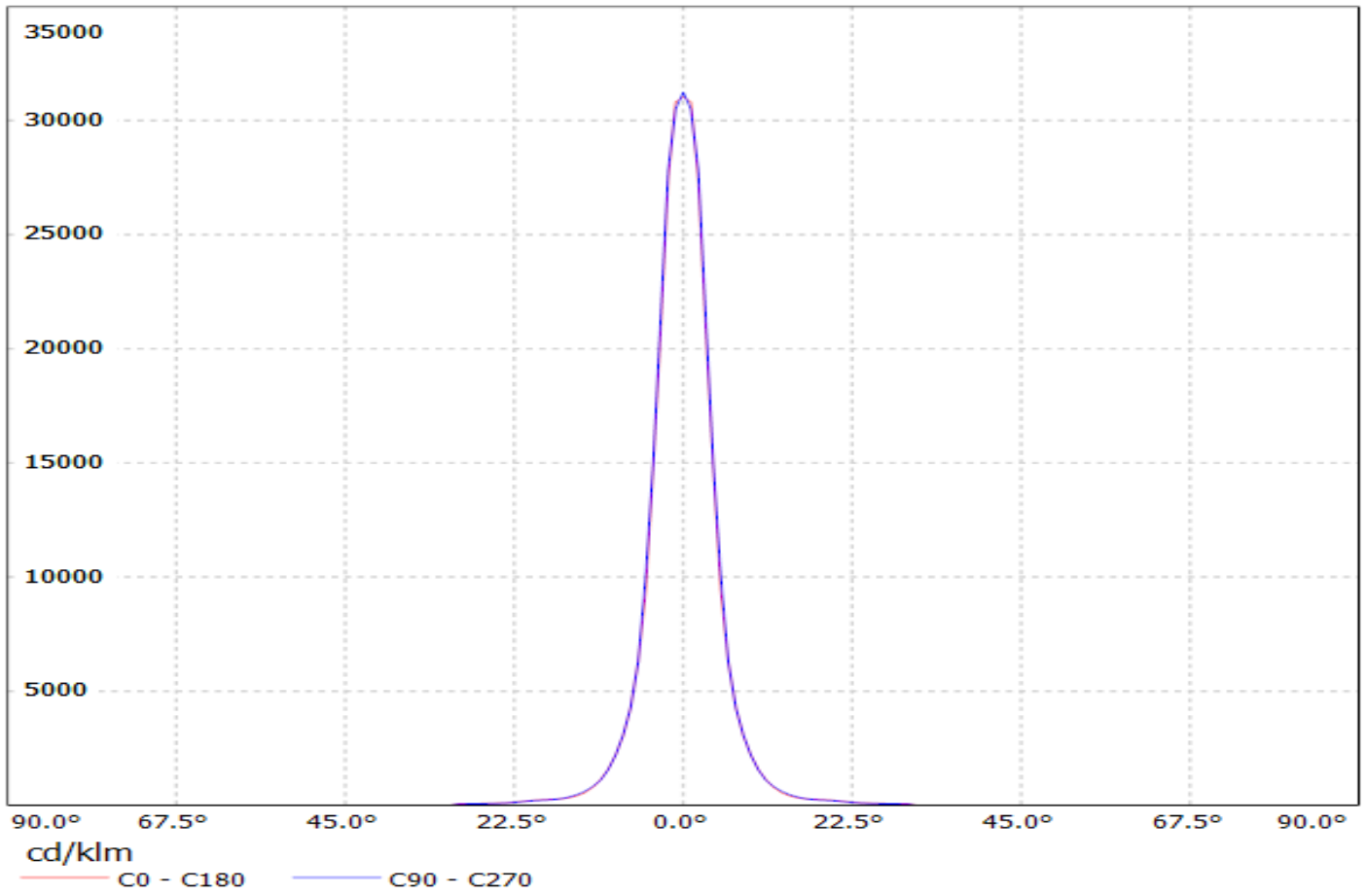

Luminaire: Ledil OY FCN11738_LR1-RS2-RE LOR=93%
Lamps: 1 x Luxeon Rebel 250mA 78lm

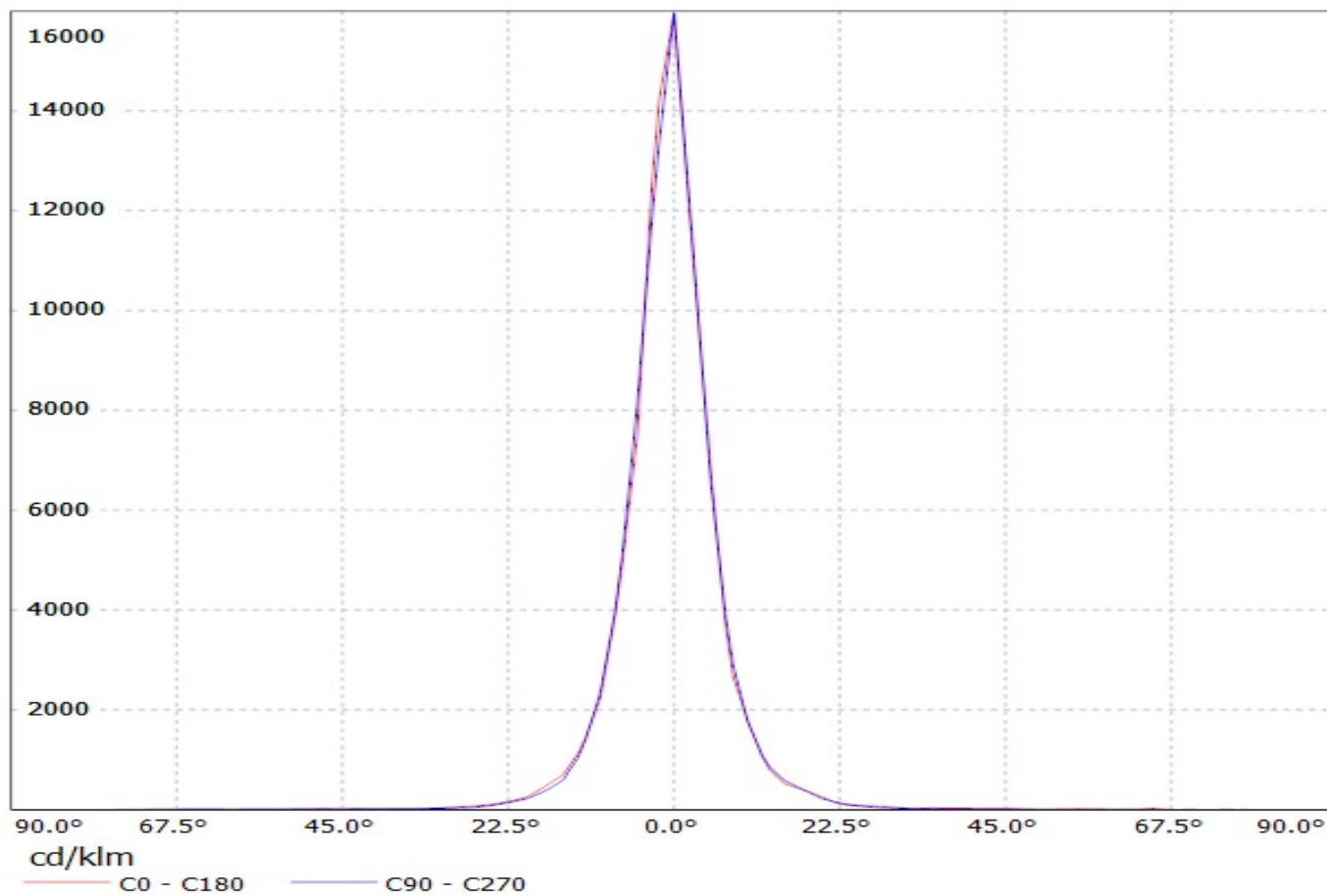

Luminaire: Ledil Oy FA10803_LR1-M FA10803_LR1-M
Lamps: 1 x Luxeon Rebel

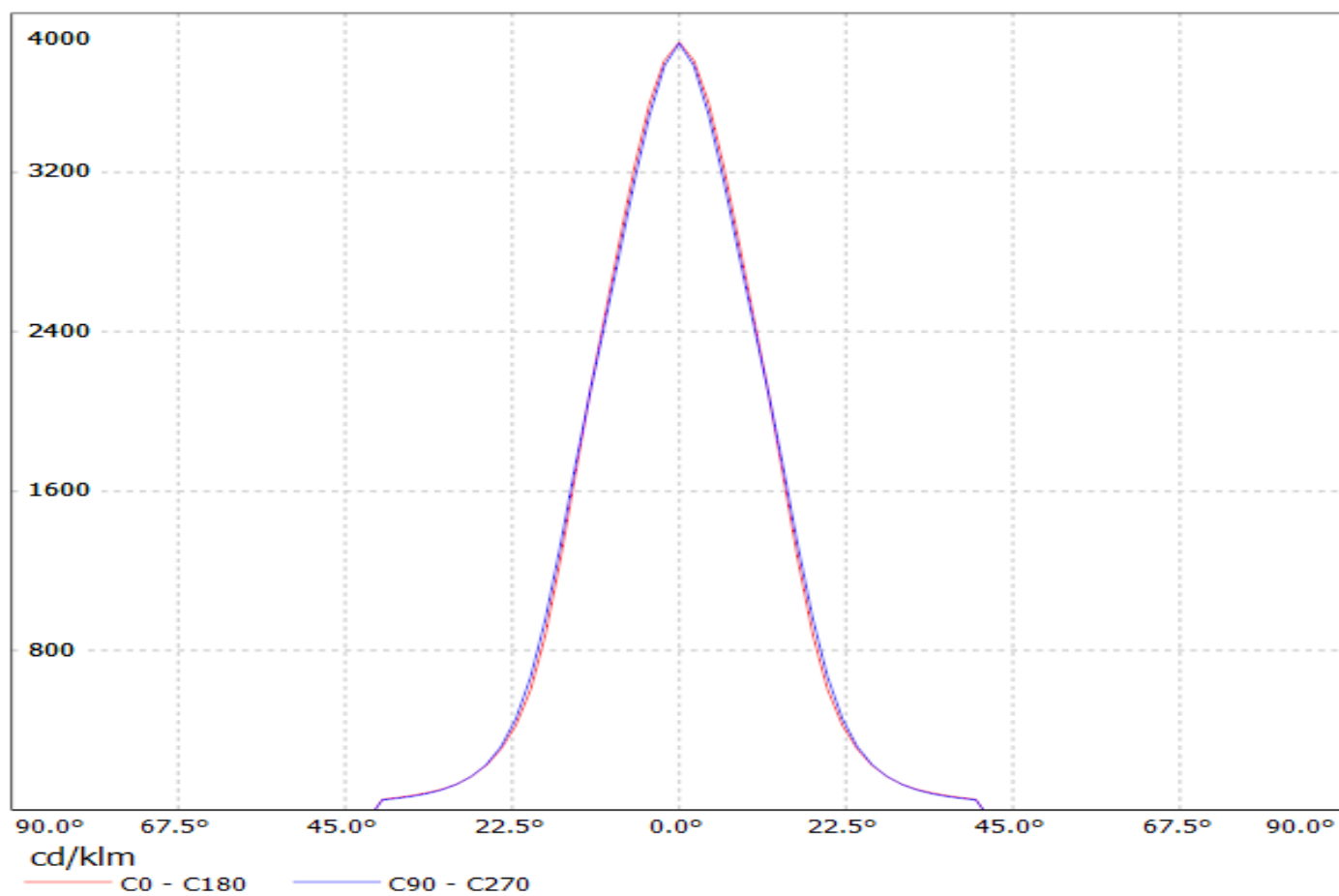

Luminaire: Ledil Oy FA10805_LR1-REC FA10805_LR1-REC
Lamps: 1 x Luxeon Rebel (white)

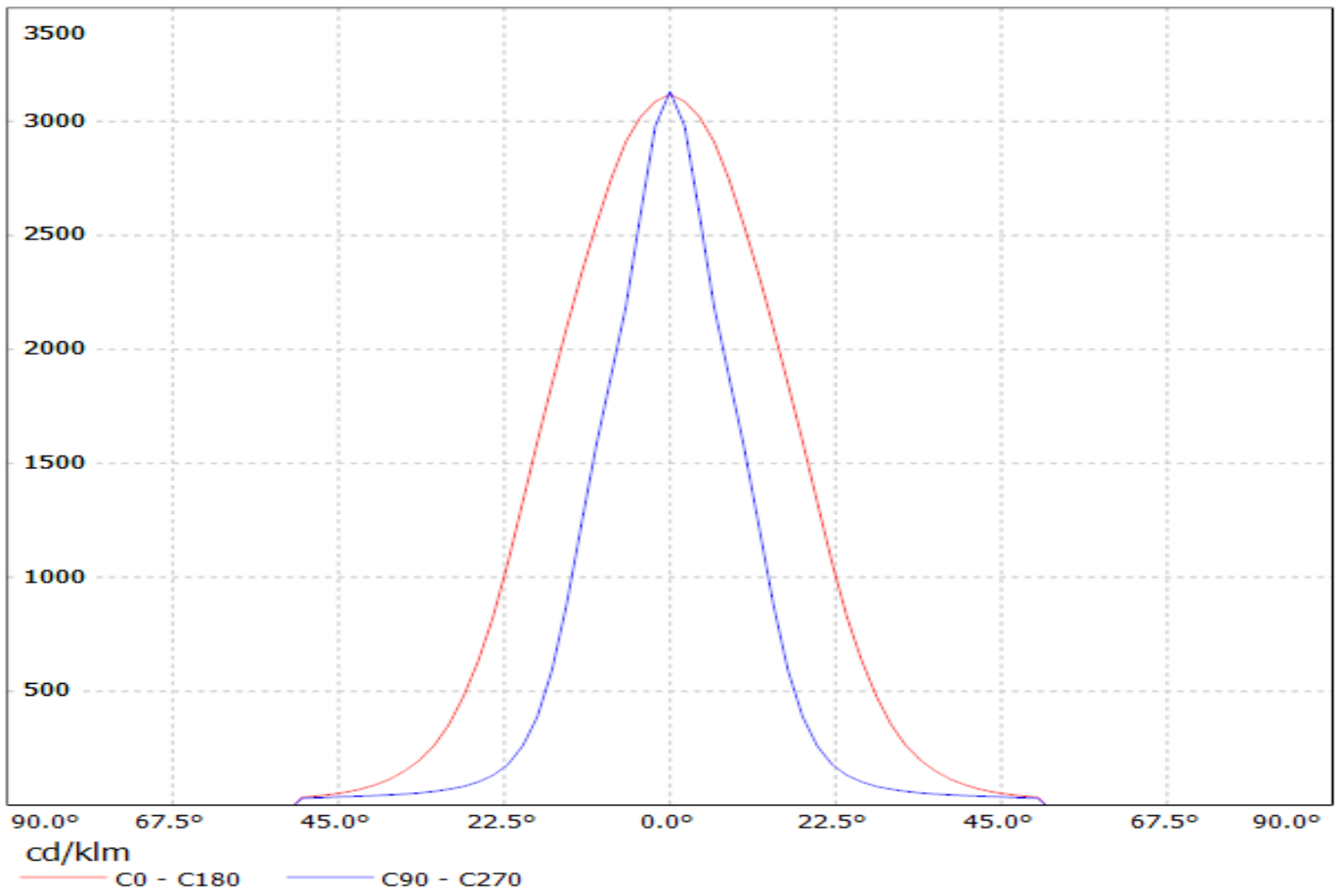

Luminaire: Ledil Oy FA10890_LR1-W FA10890_LR1-W
Lamps: 1 x Luxeon Rebel (white)

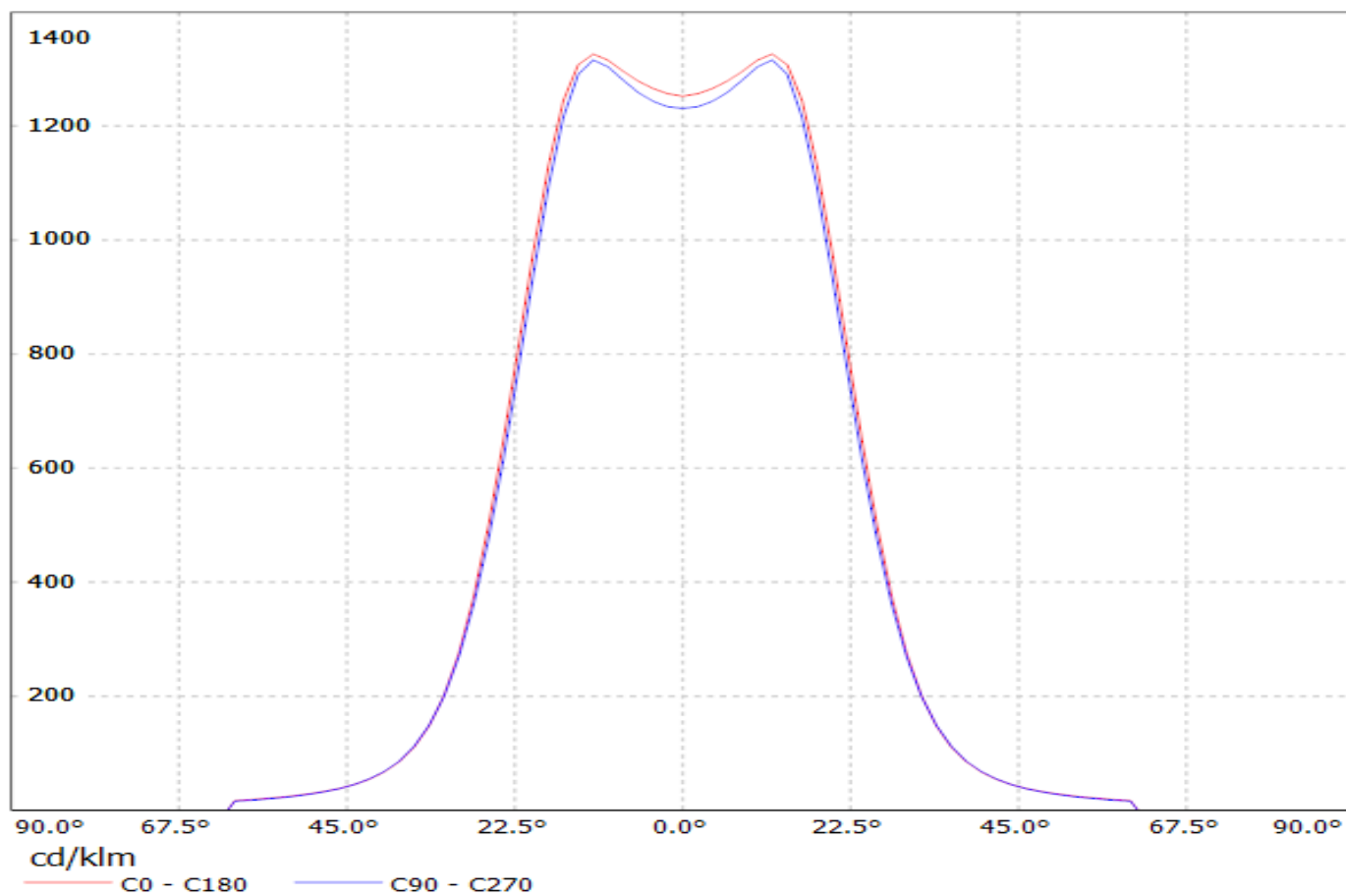

Luminaire: Ledil Oy FA10804_LR1-RS FA10804_LR1-RS
Lamps: 1 x LUXEON REBEL

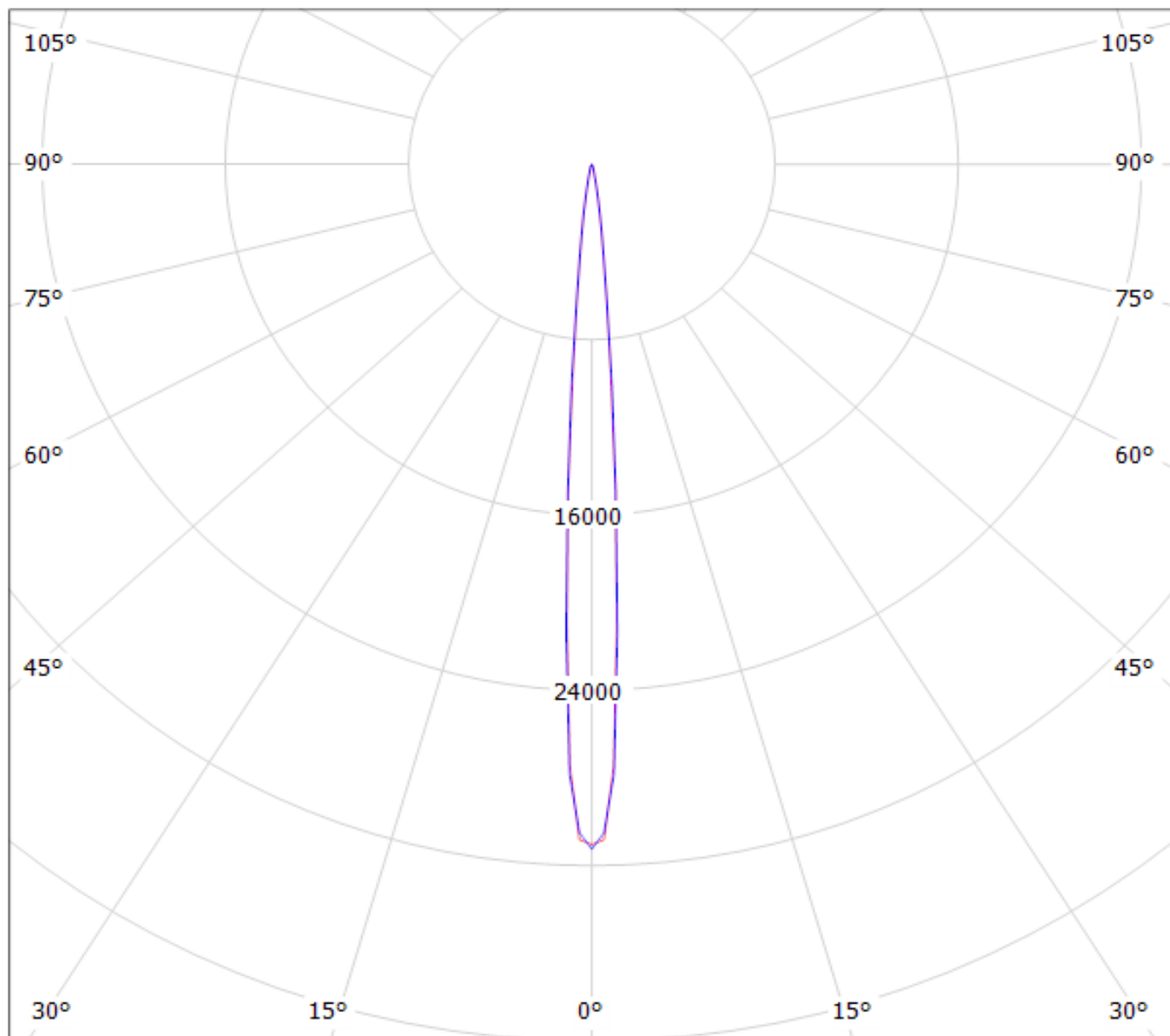

cd/klm

— C0 - C180

— C90 - C270

Luminaire: Ledil OY FCN11738_LR1-RS2-RE LOR=93%
Lamps: 1 x Luxeon Rebel 250mA 78lm

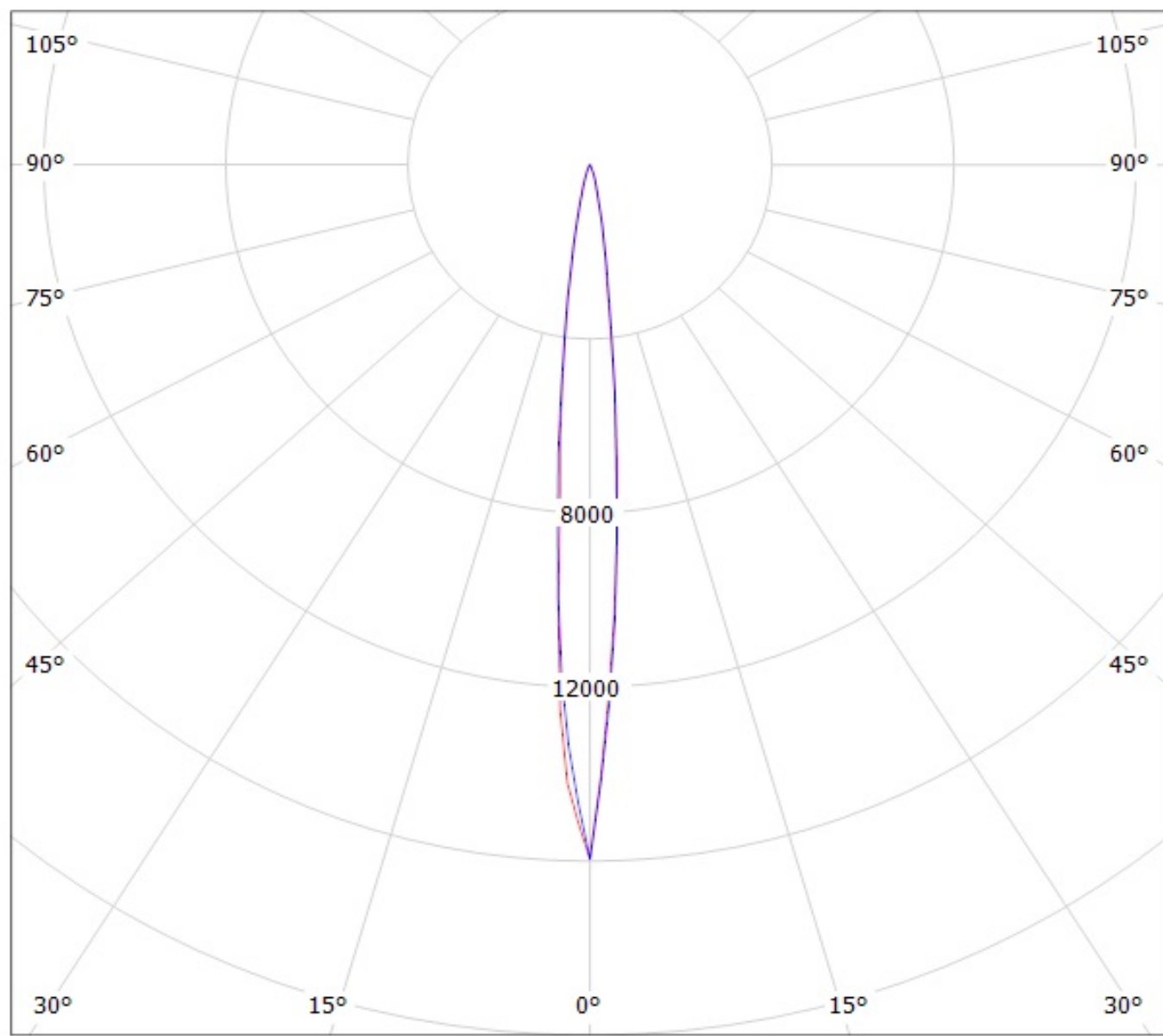

cd/klm

— C0 - C180

— C90 - C270

Luminaire: Ledil Oy FA10803_LR1-M FA10803_LR1-M
Lamps: 1 x Luxeon Rebel

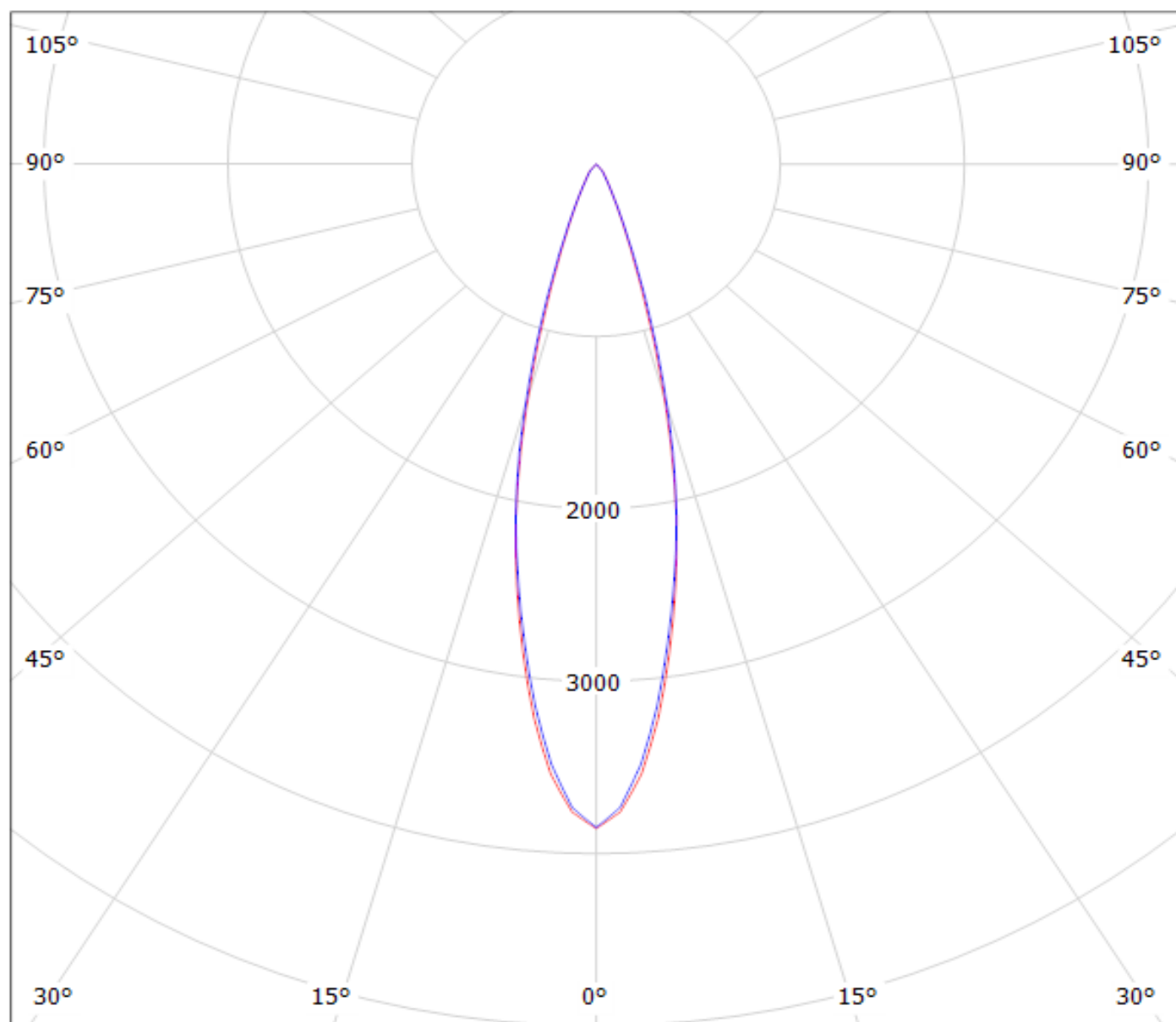

cd/klm

— C0 - C180

— C90 - C270

Luminaire: Ledil Oy FA10805_LR1-REC FA10805_LR1-REC
Lamps: 1 x Luxeon Rebel (white)

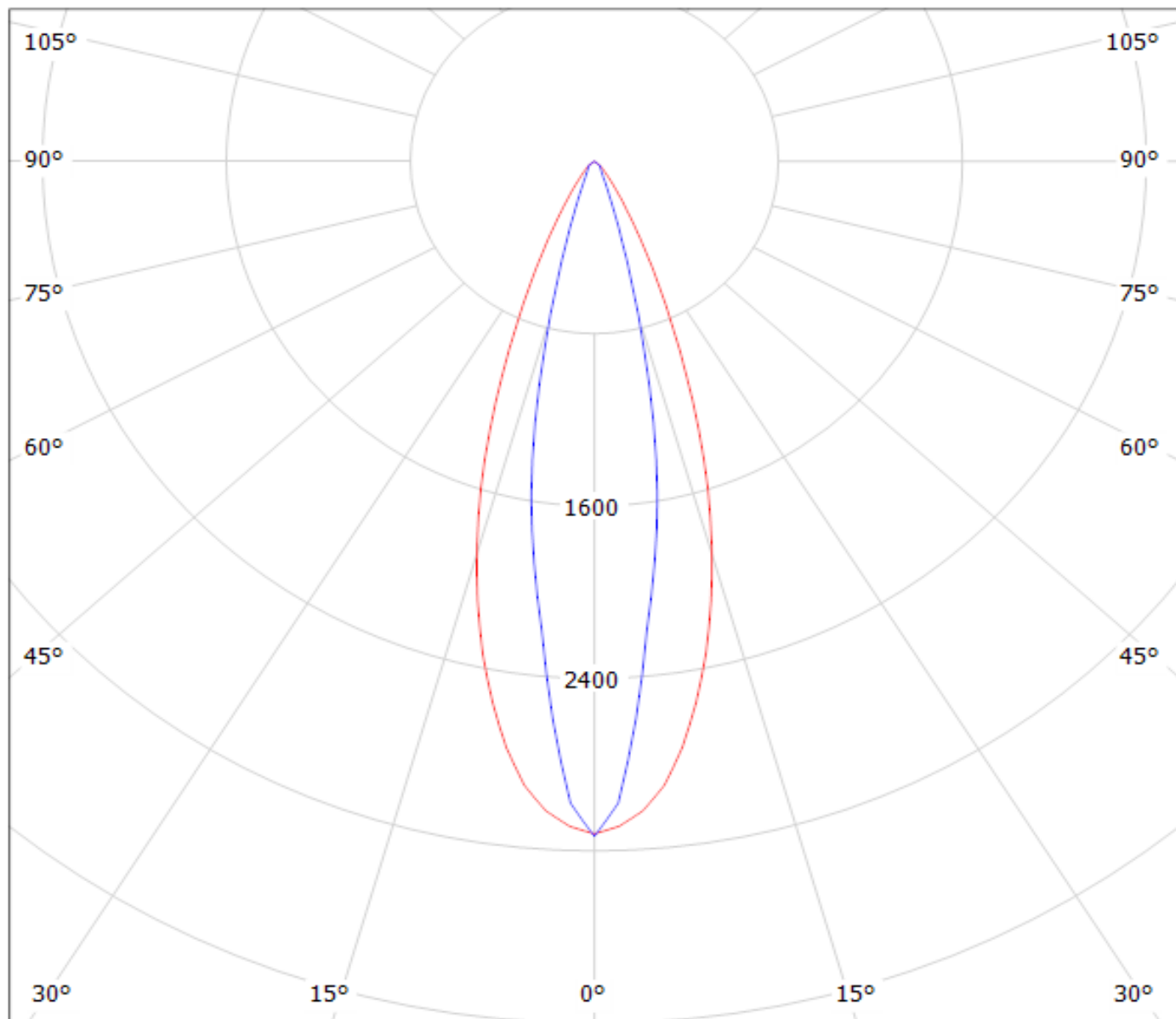

cd/klm

— C0 - C180

— C90 - C270

Luminaire: Ledil Oy FA10890_LR1-W FA10890_LR1-W
Lamps: 1 x Luxeon Rebel (white)

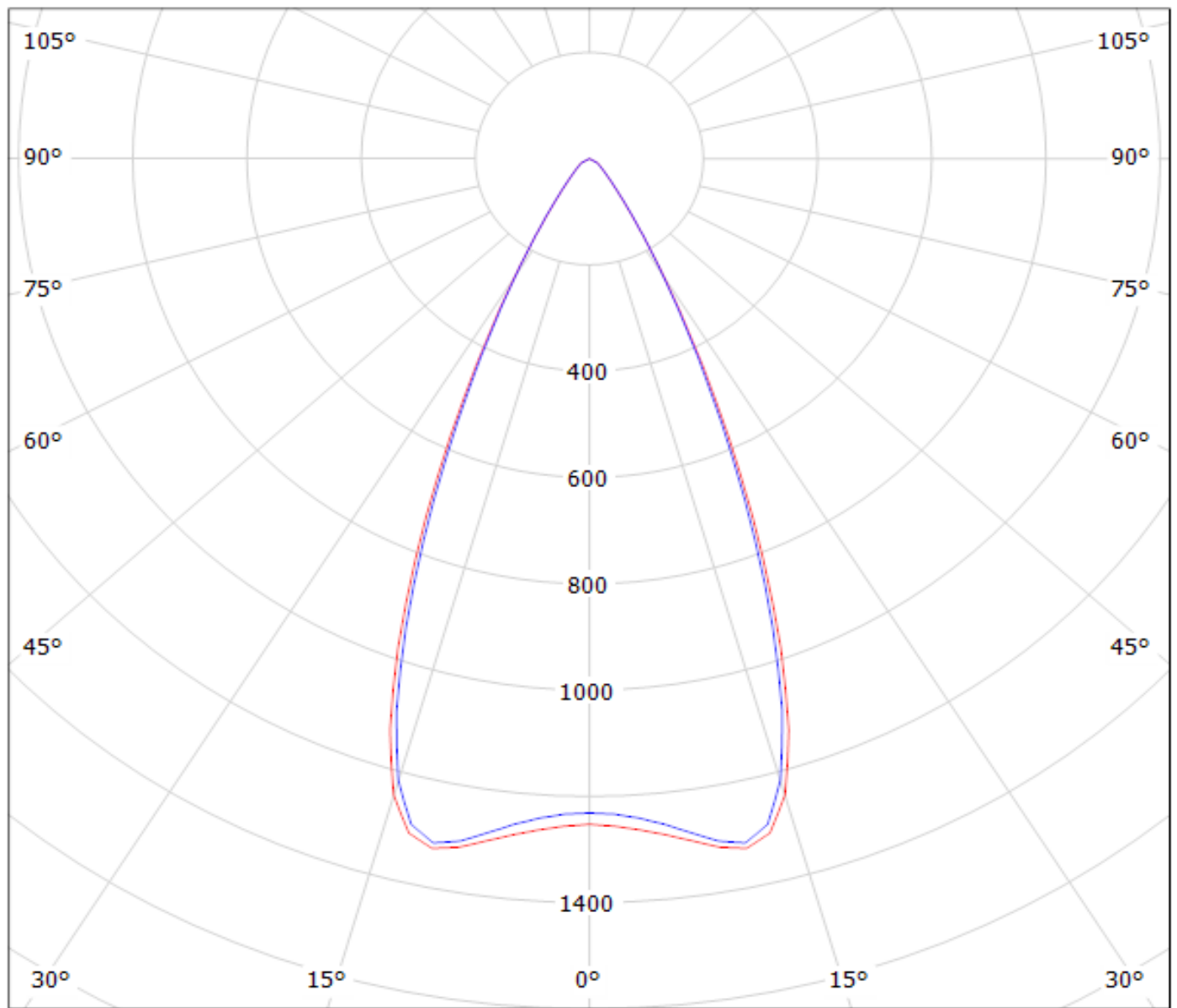

cd/klm

— C0 - C180 — C90 - C270