



PRODUCT DATASHEET

Leila series

last update 17/9/2015

DETAILS

Product Number	FCN10806_LR1-D
Family	Leila
Type	Pack
Color	white
Diameter	21,6 mm
Height	14,3 mm
Style	round
Optic Material	PMMA
Holder Material	PC
Fastening	glue
Status	production ready
ROHS Compliant	Yes
Date Updated	17/09/2015

OPTICAL PROPERTIES

	Viewing	Light	Effi-		
LED	Angle	Beam	ciency	cd/lm	Connector
LUXEON Rebel	11 deg	Diffuser	96 %	sim: 0.000	-



H G F E D C B A

4

4

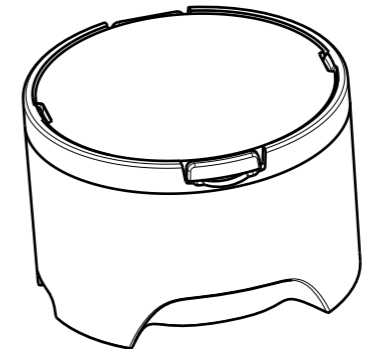
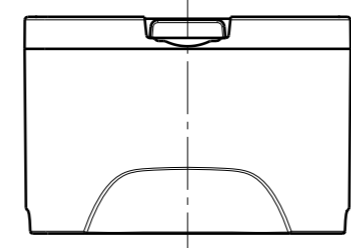
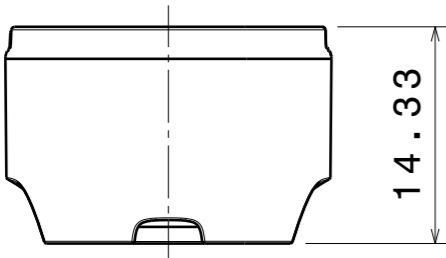
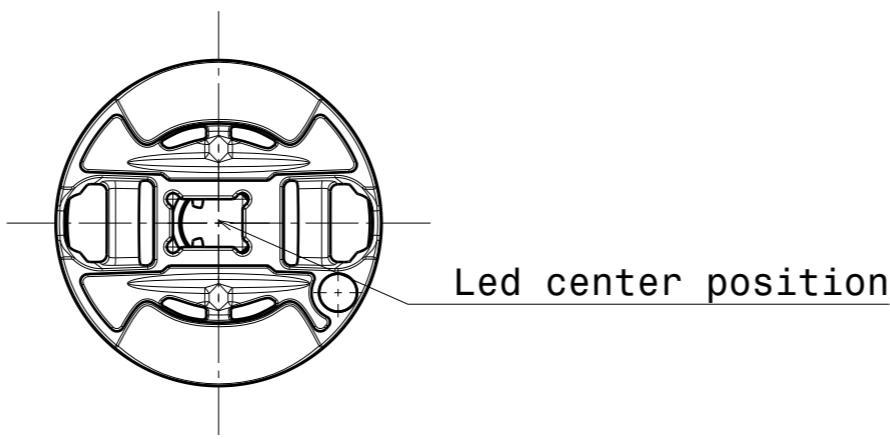

3

3

2

2

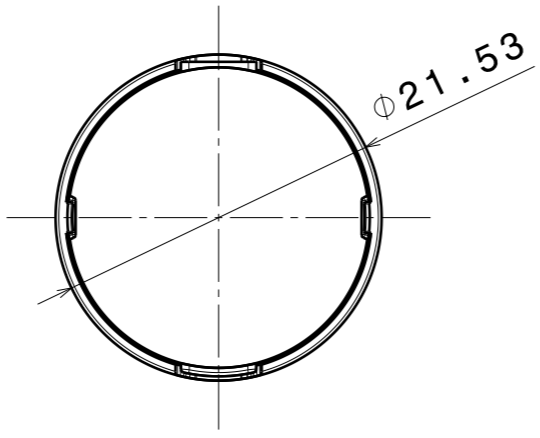

INDEX	PART NO	DESCRIPTION	MATERIAL	COLOUR
1	C10445	LR-LH1	PC	white
2	F10628	LR1-D	PMMA	

Tolerances if not otherwise shown
 According to DIN ISO 2768-1
 Linear measures:
 up to 30mm class M, otherwise class C
 According to DIN ISO 2768-2
 Form and position: class L

LEDiL LediL Oy
 Salorankatu 10
 FIN 24240 SALO
 Finland

THIRD ANGLE PROJECTION:

DRAWING TITLE
FCN10806_LR1-D Mechanical model

This drawing is the property
 of LEDiL Oy. It may not be
 reproduced, copied or
 communicated without a written
 agreement with LEDiL Oy.

SIZE	PART NUMBER
A3	FCN10806

SCALE	2:1	WEIGHT	4,48 g	SHEET	1/1
-------	-----	--------	--------	-------	-----

H G B A

1

1

NOTE: The typical divergence will be changed by different color, chip size and chip position tolerance. The typical total divergence is the full angle measured where the luminous intensity is half of the peak value.

GENERAL INFORMATION

- Product series especially designed & optimized for series of LEDs.
- Special care taken to make light distribution as uniform as possible.
- Fastening to PCB with appropriate adhesive. By clicking link below you can find Ledil recommended glue options.
http://www.ledil.com/datasheets/DataSheet_GLUES.pdf

NOTE 1: We advise customer to ensure the suitability and sufficiency of the bond in the end product. For example, mechanical stress, vibration and holes on the surface of the circuit board weaken the strength of the glue.

NOTE 2: All surfaces where glue is applied must be clean, dry and free from grease and dirt. If cleaning of PCB surfaces is needed, please follow strictly the cleaning instructions of your LED manufacturer -this is important as cleaning shall under no circumstances damage LEDs or other electronics components on the PCB.

Further note that optical components shall not be cleaned with any chemicals - only micro fiber cloth may be used to remove fingerprints or other traces from handling.