

# Product Search

Your Search for "nl8" returned 6 Match(es):



**Speakon® Lockable Loudspeaker Connector**



**Cable Connectors**



**NL8FC**  
8 pole cable connector with latch lock. Cable sleeve for cables 8 - 20 mm diameter. 30 A continuous per contact.  
[Specs](#) [PDF](#) [DXF](#)



**Chassis Connectors**



**NL8MD-V**  
8 pole chassis connector with nickel metal flange. Vertical PCB mounting version of NL8MP.  
[Specs](#) [PDF](#) [DXF](#)



**NL8MD-V-BAG**  
8 pole chassis connector with black chrome metal flange. Vertical PCB mounting version of NL8MP.  
[Specs](#) [PDF](#) [DXF](#)



**NL8MPR**  
8 pole chassis connector with nickel metal flange.  
[Specs](#) [PDF](#) [DXF](#)



**NL8MPR-BAG**  
8 pole chassis connector with black chrome metal flange.  
[Specs](#) [PDF](#) [DXF](#)



**Adapter**



**NL8MM**  
8 pole coupler.  
[Specs](#) [PDF](#) [DXF](#)



[Specs](#)

[PDF](#)

[DXF](#)



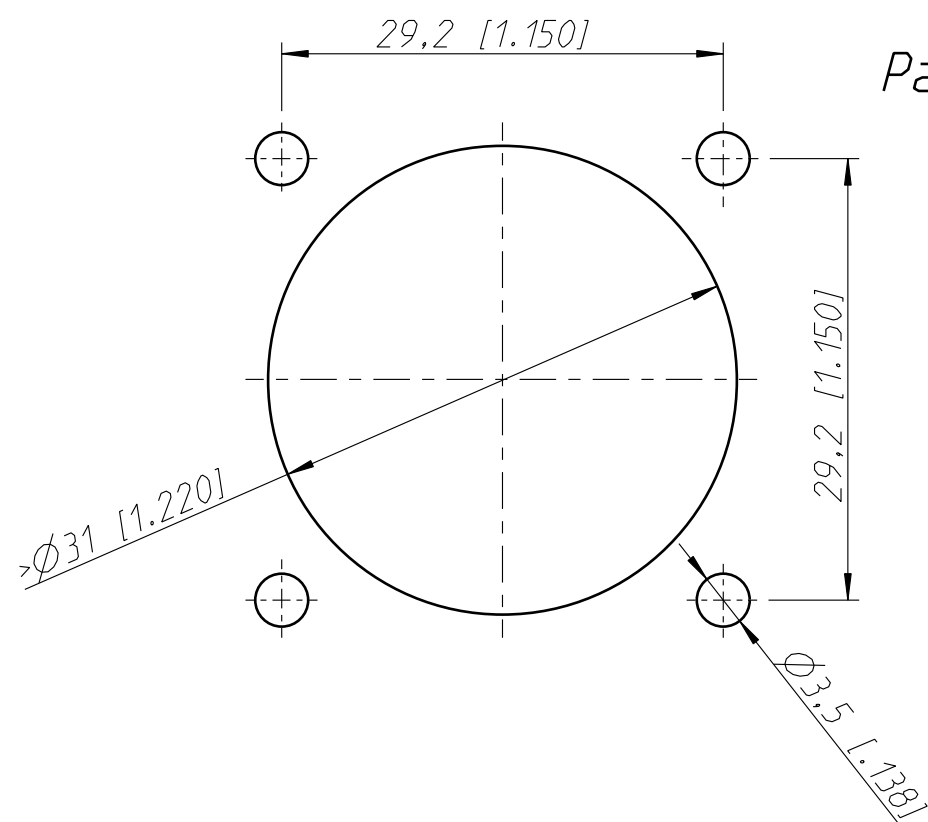
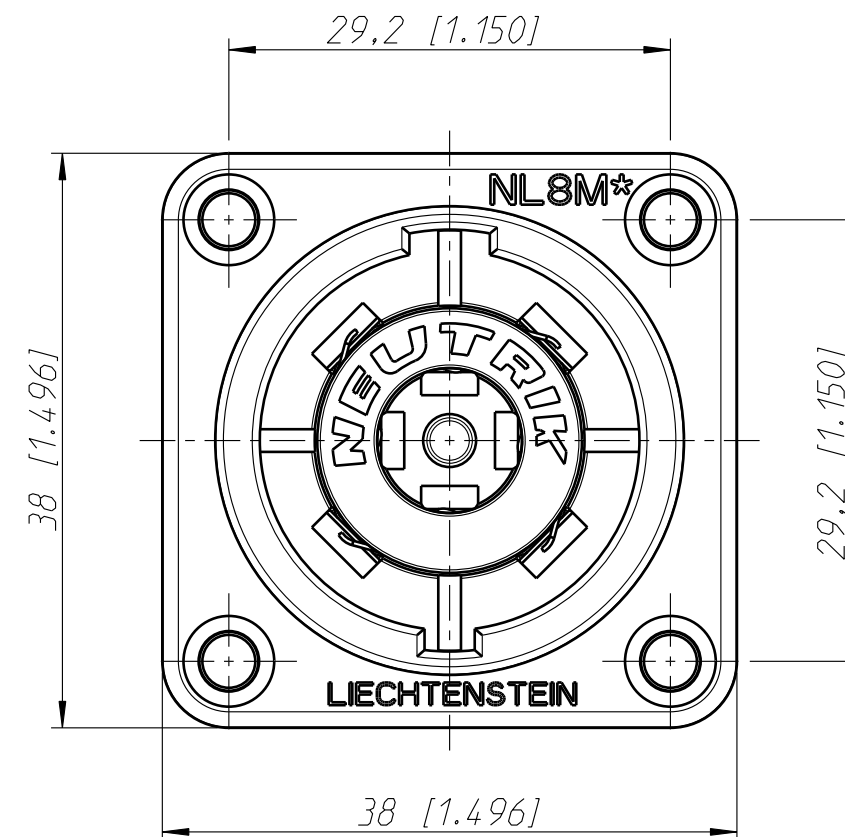
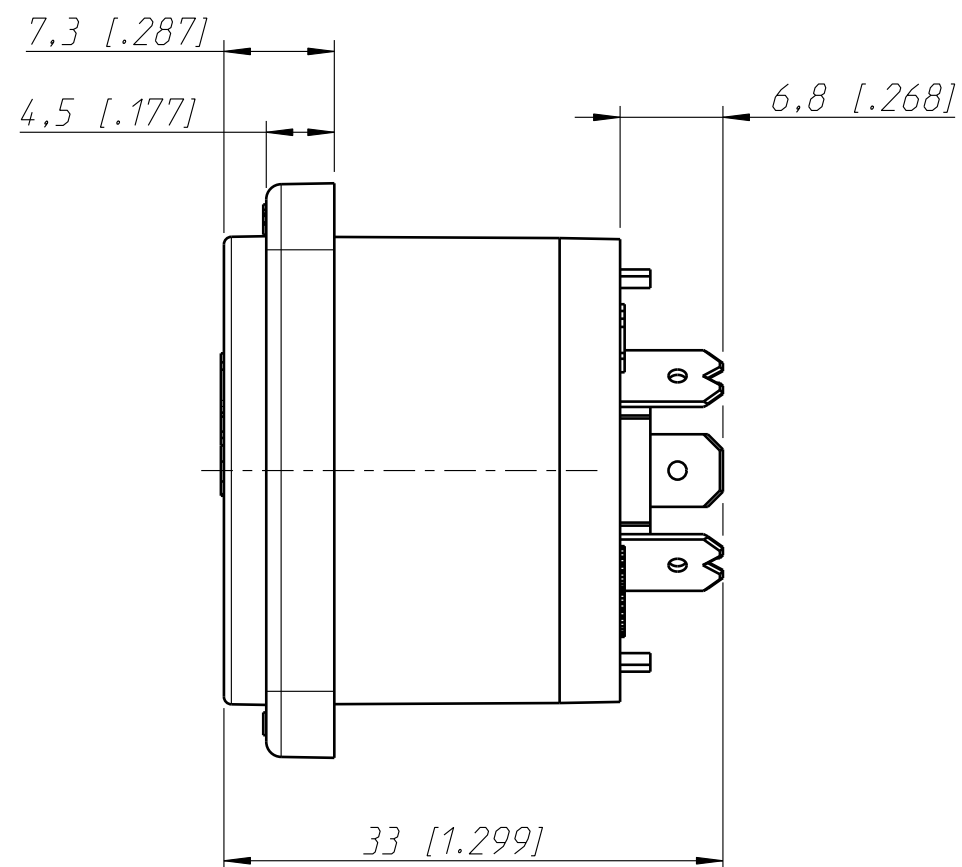

Allgemeintoleranzen ISO 2768-m	Werkstoff  KEIN_MAT  -	Massstab:  2:1  (A3)		Datum	Name
			Gezeichnet	07.10.03	Hofmann Th.
Freigegeben			-	-	
Geändert			-	-	
Zeichnung urheberrechtlich geschuetzt (DIN 34) (C)			Aend.-Nr.		Aend.-Index
Benennung  NL 8MPR  NL 8MPR			-		-
			Ersatz fuer:		Blatt 1 von 1 Bl.
NEUTRIK AG FL-9494 SCHAAN			Zeichn. Nr. ST-NL 8MPR		