

THIS COPY IS PROVIDED ON A RESTRICTED BASIS AND IS NOT TO BE USED IN ANY WAY DETRIMENTAL TO THE INTERESTS OF PANDUIT CORP.

PANDUIT P/N	WEIGHT
CSC**-X	.02 LB/10 PCS (89 G/10 PCS)

NOTES:

1. SEE CURRENT CATALOG FOR ADDITIONAL PART NUMBER SUFFIXES TO INDICATE COLOR AND OR PACKAGE QUANTITY.
2. SCREW COVER HAS A TEXTURED SURFACE AND BLENDS IN WITH THE FACEPLATES FOR IMPROVED AESTHETICS. FOR OUTLET IDENTIFICATION, ADHESIVE LABELS CAN BE APPLIED TO THE INSIDE OF THE SCREW COVER.
3. CAN BE USED WITH SELECT PANDUIT FACEPLATES.
4. DIMENSIONS IN PARENTHESIS ARE IN METRIC.

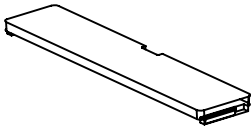
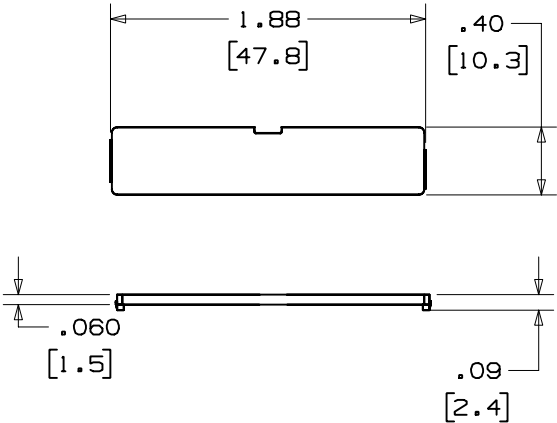

										CAD FILENAME/LAYERS		D35544BX_CSC_C_00B.PRT			
												PANDUIT CORP. TINLEY PARK, ILLINOIS			
												FACEPLATE AND SURFACE BOX SCREW COVER (CSC**-X) CUSTOMER DRAWING			
												UNLESS OTHERWISE SPECIFIED, DIMENSIONAL TOLERANCES ARE: (.X) ± (.XXX) ± .010(.3) (.XX) ± .03(.8) ANGLES ±			
												UNLESS OTHERWISE SPECIFIED, ALL DIMENSIONS ARE GIVEN IN INCHES, THIRD ANGLE PROJECTION.			
1	11-12-99	JsP		A. REVISED NOTE 3.			35544-22					DRAWN BY JBA	MAT'L: ABS	SCALE NONE	
R	10-21-96	JBA	CEF	RELEASED TO PRODUCTION.			35544-22	CEF				DATE 10-21-96		DRAWING NO. 35544-22	DWG A
REV	DATE	BY	CHK	DESCRIPTION			ECN	CHK	CUST	SUP		CHECKED BY CEF		SIZE	