

DIMENSIONS RSS, RSM, RSL ROCKER SWITCHES-LATCHING ACTION

CONSTRUCTION

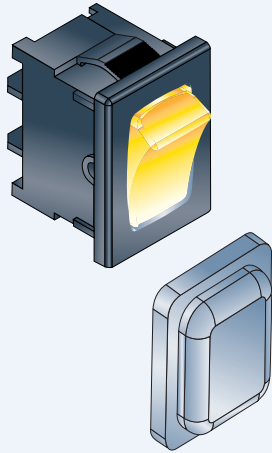

RSS 1 pole

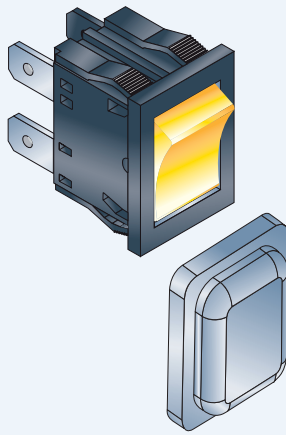

RSS 2 pole

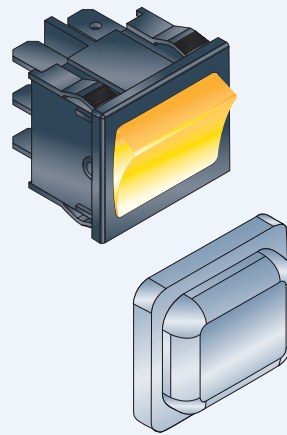

RSM

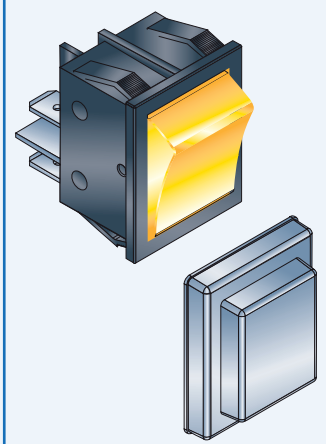

RSL

DIMENSIONS

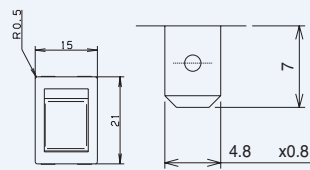
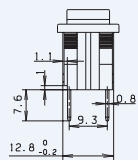
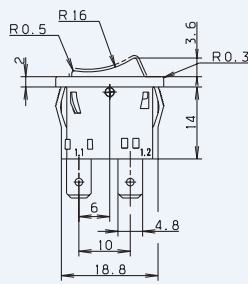
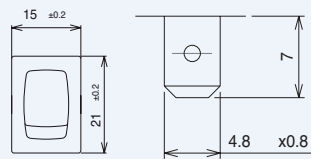
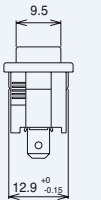
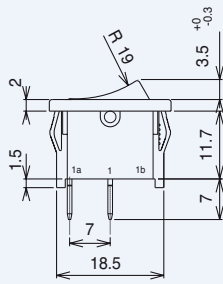

non-illuminated

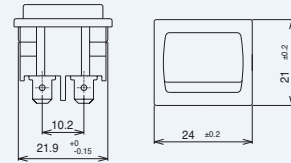
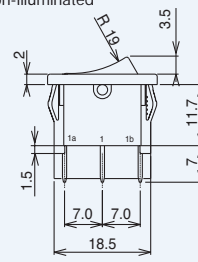

illuminated

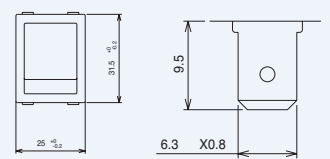
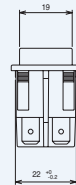
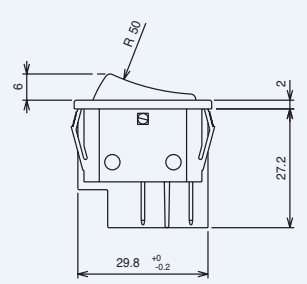
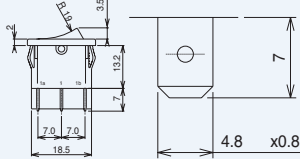
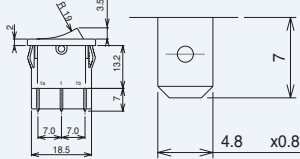

MOUNTING

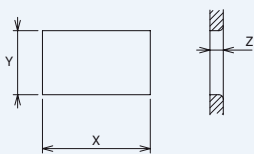

Z	Y	X
0.75-1.25	13.0 ± 0.1	19.0 $\begin{smallmatrix} +0.2 \\ 0 \end{smallmatrix}$
1.25-2	13.0 ± 0.1	19.3 $\begin{smallmatrix} +0.2 \\ 0 \end{smallmatrix}$
2-3	13.0 ± 0.1	19.6 $\begin{smallmatrix} +0.2 \\ 0 \end{smallmatrix}$

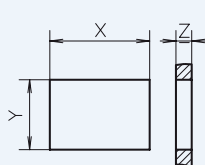

Z	Y	X
0.7...1.25	13.0 ± 0.1	19.1 ± 0.1
1.25...2.0	13.0 ± 0.1	19.4 ± 0.1
2.0...3.0	13.0 ± 0.1	19.7 ± 0.1

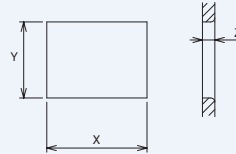

Z	Y	X
0.75-1.25	22.0 ± 0.1	19.0 $\begin{smallmatrix} +0.2 \\ 0 \end{smallmatrix}$
1.25-2	22.0 ± 0.1	19.3 $\begin{smallmatrix} +0.2 \\ 0 \end{smallmatrix}$
2-3	22.0 ± 0.1	19.6 $\begin{smallmatrix} +0.2 \\ 0 \end{smallmatrix}$

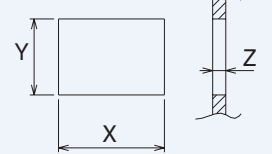

Z	Y	X
0.75-1.25	22.0 $\begin{smallmatrix} +0.2 \\ 0 \end{smallmatrix}$	30.0 $\begin{smallmatrix} 0 \\ -0.1 \end{smallmatrix}$
1.25-2	22.0 $\begin{smallmatrix} +0.2 \\ 0 \end{smallmatrix}$	30.2 $\begin{smallmatrix} 0 \\ -0.1 \end{smallmatrix}$
2-3	22.0 $\begin{smallmatrix} +0.2 \\ 0 \end{smallmatrix}$	30.6 $\begin{smallmatrix} 0 \\ -0.2 \end{smallmatrix}$
3-4	22.0 $\begin{smallmatrix} +0.2 \\ 0 \end{smallmatrix}$	30.8 $\begin{smallmatrix} 0 \\ -0.2 \end{smallmatrix}$

OVERVIEW RSS, RSM, RSL ROCKER SWITCHES-LATCHING ACTION



All types are lettered to describe the switch state (see product photo).	RSS	RSM	RSL
--	-----	-----	-----

FEATURES

Terminals	Quick-connect terminals 4.8mm x 0.8mm	Quick-connect terminals 4.8mm x 0.8mm	Quick-connect terminals 6.3mm x 0.8mm
PART NUMBER			
1 pole non-illuminated			
Actuator colour: black	1301.9206		
red	1301.9208		
2 pole non-illuminated			
Actuator colour: black	1301.9213	1301.9202	1301.9222
red			1301.9221
2 pole illuminated			
Actuator colour: red		1301.9201	1301.9224
green	1301.9211	1301.9212	1301.9215
Cover, transparent			
Degree of protection IP 65			1301.9214
Degree of protection IP 44	* 1301.9209	* 1301.9210	

Dimensions:	RSS 1 pole:	RSS 2 pole:	RSM:	RSL:

* Degree of protection IP 65 on request