

Surface Mount Fuse with Holder, 12 x 5.2 mm, Quick-Acting F, 125 VAC, 125 VDC



UL 248-14 · 125VAC · 125VDC · Quick-Acting F



### Description

- Directly solderable on printed circuit boards
- OMK 125 = OMF 125 + OMH 125

### Standards

- UL 248-14
- CSA C22.2 no. 248.14

### References

[Packaging Details](#)

### Weblinks

[pdf-datasheet](#), [html-datasheet](#), [General Product Information](#), [Approvals](#), [CE declaration of conformity](#), [RoHS](#), [CHINA-RoHS](#), [REACH](#), [e-Shop](#), [SCHURTER-Stock-Check](#), [Distributor-Stock-Check](#), [Detailed request for product](#)

### Technical Data

Rated Voltage	125 VAC, 125 VDC
Rated current	0.063 - 5 A
Breaking Capacity	100 A
Characteristic	Quick-Acting F
Mounting	PCB,SMT
Admissible Ambient Air Temp.	-40 °C to 85 °C
Climatic Category	40/085/21 acc. to IEC 60068-1
Material: Housing	Thermoplastic, UL 94V-0
Material: Terminals	Tin-Plated Copper
Unit Weight	0.47 g
Storage Conditions	0 °C to 60 °C, max. 70% r.h.
Product Marking	 , Type, Current, Approvals

Soldering Methods	Reflow
Solderability	245 °C / 3 sec acc. to IEC 60068-2-58, Test Td
Resistance to Soldering Heat	260 °C / 10 sec acc. to IEC 60068-2-58, Test Td

### Dimension

 12 mm

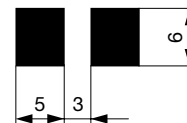
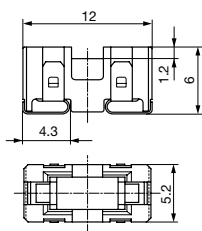

Soldering pads

### Pre-Arcing Time

Rated Current  $I_n$     1.0 x  $I_n$  min.    2.0 x  $I_n$  max.    4.0 x  $I_n$  max.

0.063 A - 5 A	4 h	1 s	10 ms
---------------	-----	-----	-------

## Time-Current-Curves

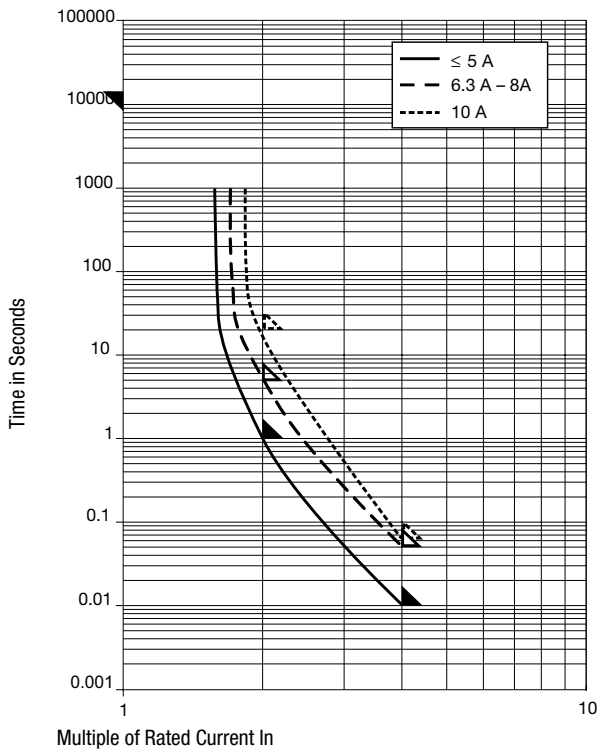

## All Variants

Fuse	Holder	Rated Current [A]	Rated Voltage [VAC]	Rated Voltage [VDC]	Breaking Capacity	Voltage Drop 1.0 I <sub>n</sub> typ. [mV]	Power Dissipation 1.0 I <sub>n</sub> typ. [mW]	Melting I <sup>2</sup> t 4.0 I <sub>n</sub> typ. [A <sup>2</sup> s]	Order Number
●	●	0.063	125	125	1)	2550	160	0.00011	3404.2303.xx
●	●	0.1	125	125	1)	1770	180	0.00067	3404.2304.xx
●	●	0.125	125	125	1)	1770	220	0.0011	3404.2349.xx
●	●	0.16	125	125	1)	1700	270	0.0018	3404.2305.xx
●	●	0.25	125	125	1)	990	250	0.0058	3404.2306.xx
●	●	0.35	125	125	1)	990	350	0.0076	3404.2343.xx
●	●	0.375	125	125	1)	990	370	0.013	3404.2344.xx
●	●	0.4	125	125	1)	960	380	0.016	3404.2307.xx
●	●	0.5	125	125	1)	350	150	0.01	3404.2345.xx
●	●	0.63	125	125	1)	290	180	0.02	3404.2308.xx
●	●	0.75	125	125	1)	260	200	0.031	3404.2346.xx
●	●	1	125	125	1)	220	220	0.078	3404.2309.xx
●	●	1.25	125	125	1)	220	280	0.14	3404.2310.xx
●	●	1.5	125	125	1)	200	300	0.24	3404.2347.xx
●	●	1.6	125	125	1)	200	320	0.27	3404.2311.xx
●	●	2	125	125	1)	200	400	0.44	3404.2312.xx
●	●	2.5	125	125	1)	190	480	0.97	3404.2313.xx
●	●	3	125	125	1)	190	570	1.3	3404.2314.xx
●	●	3.15	125	125	1)	190	600	1.2	3404.2348.xx
●	●	3.5	125	125	1)	140	490	1.6	3404.2315.xx
●	●	4	125	125	1)	140	560	2.1	3404.2316.xx
●	●	5	125	125	1)	140	700	2.9	3404.2317.xx

Availability for all products can be searched real-time: <http://www.schurter.com/en/Stock-Check/Stock-Check-SCHURTER>

1) 100 A @ 125 VAC/DC

---

<b>Packaging Unit</b>	.xx = .11 Plastic Bag (100 pcs.)
	.xx = .22 Blister Tape 18 cm Reel (750 pcs.)
	.xx = .23 Blister Tape 33 cm Reel (1500 pcs.)

---