

- NOTES:
- PLACE (1) ONE OF EACH KIT, IN A BAG WITH INSTRUCTION SHEET AND SEAL.
  - LABEL WITH CONXALL, PART NUMBER, DATE CODE, AND PART NUMBER BARCODE IS PLACED ON BAG.

**SF3282-2PG-5XX**  
FACE VIEW  
2 POSITION  
POS 1, 2, 3, 5, 6, 7, 8, 10, 11 & 12 MOLDED HALF CLOSED

**SF3282-3PG-5XX**  
FACE VIEW  
3 POSITION  
POS 2, 4, 5, 6, 7, 8, 9, 10 & 11 MOLDED HALF CLOSED

**SF3282-4PG-5XX**  
FACE VIEW  
4 POSITION  
POS 2, 4, 6, 7, 9, 10, 11 & 12 MOLDED HALF CLOSED

**SF3282-5PG-5XX**  
FACE VIEW  
5 POSITION  
POS 1, 3, 5, 8, 10, 11 & 12 MOLDED HALF CLOSED

**SF3282-6PG-5XX**  
FACE VIEW  
6 POSITION  
POS 3, 6, 9, 10, 11 & 12 MOLDED HALF CLOSED

**SF3282-7PG-5XX**  
FACE VIEW  
7 POSITION  
POS 5, 8,10, 11 & 12 MOLDED HALF CLOSED

**SF3282-8PG-5XX**  
FACE VIEW  
8 POSITION  
POS 2,10, 11 & 12 MOLDED HALF CLOSED

**SF3282-9PG-5XX**  
FACE VIEW  
9 POSITION  
POS 10, 11 & 12 MOLDED HALF CLOSED

**SF3282-10PG-5XX**  
FACE VIEW  
10 POSITION  
POS 11 & 12 MOLDED HALF CLOSED

**SF3282-11PG-5XX**  
FACE VIEW  
11 POSITION  
POS 12 MOLDED HALF CLOSED

**SF3282-12PG-5XX**  
FACE VIEW  
12 POSITION

2-12 POSITION INSERT KIT

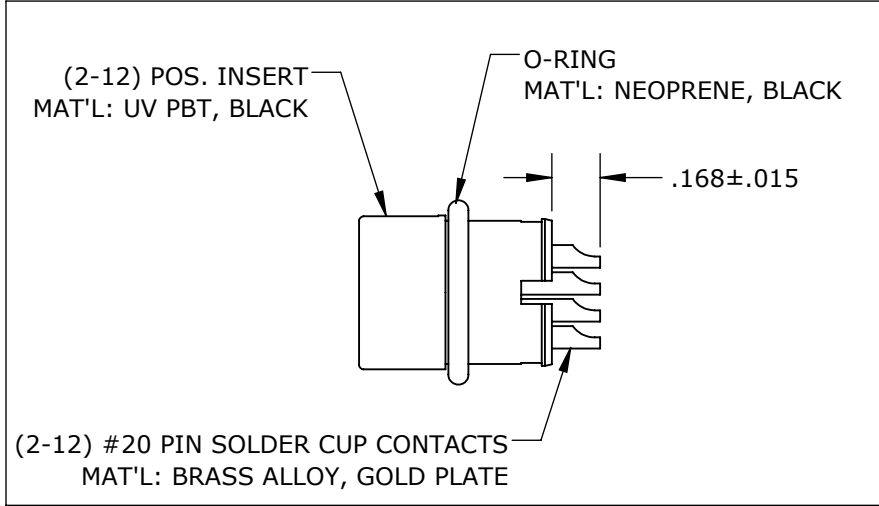

HOUSING KIT

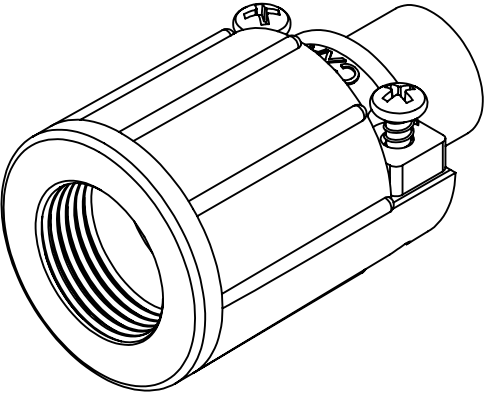
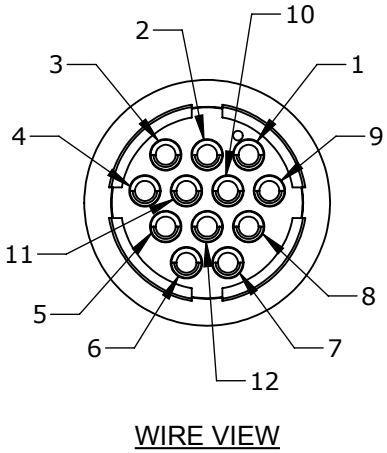
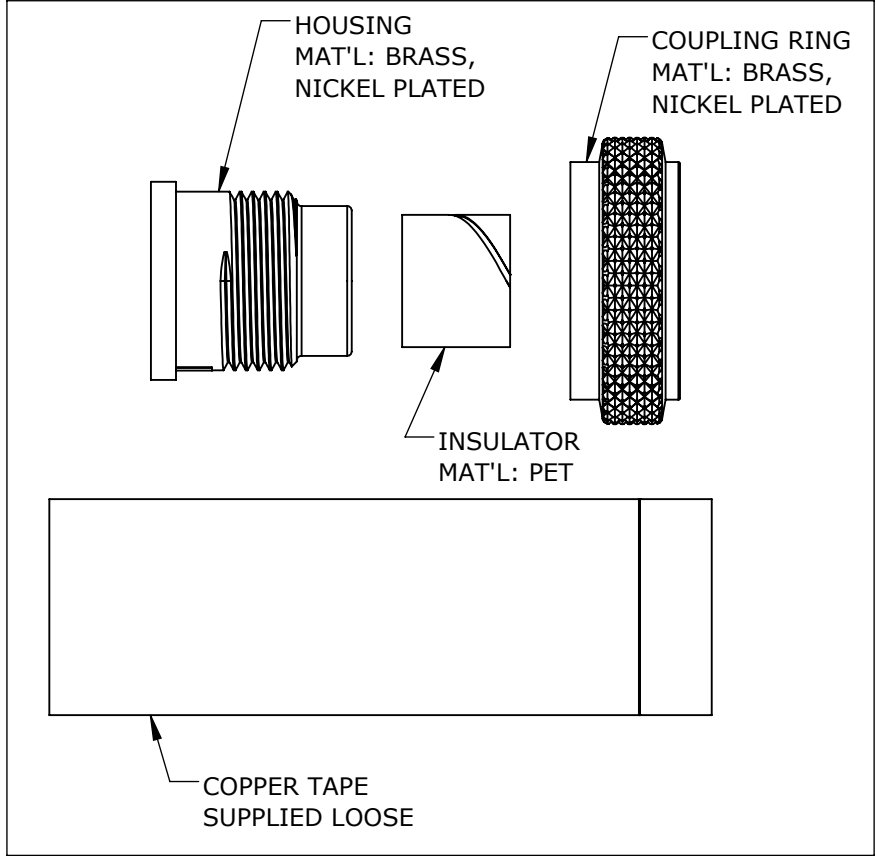

BACKSHELL KIT

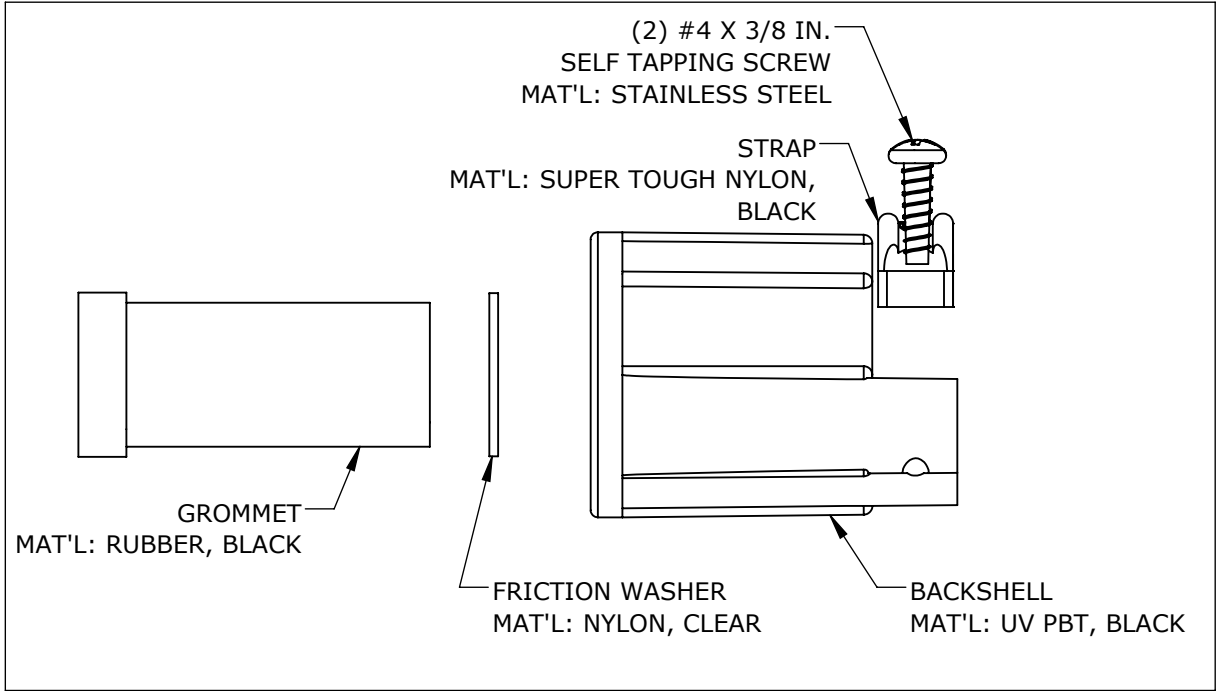

ASS'Y P/N	I.D. FOR CABLE
SF3282-XPG-520	Ø 0.200
SF3282-XPG-530	Ø 0.300
SF3282-XPG-540	Ø 0.400

NO. OF CONTACTS: 2 to 12

CUSTOMER APPROVAL

THIS DOCUMENT CONTAINS CONFIDENTIAL INFORMATION PROPRIETARY TO CONXALL CORPORATION. ANY REPRODUCTION, DISCLOSURE, OR USE OF THIS DOCUMENT /INFORMATION IS EXPRESSLY PROHIBITED UNLESS AUTHORIZED IN WRITING BY CONXALL CORPORATION.

APPROVED BY: \_\_\_\_\_  
DATE: \_\_\_\_\_

RoHS COMPLIANT

0A	JGK	03/31/20	CREATED FOR PDR#15019.	
REV.	INIT.	DATE	DESCRIPTION	
ALL INFORMATION ILLUSTRATED IS THE PROPERTY OF "CONXALL CORPORATION." UNAUTHORIZED DUPLICATION OR DISTRIBUTION OF THIS DOCUMENT IS PROHIBITED.			ORIG. DRAWN BY: JGK	DATE: 03/31/20
ALL UNITS ARE IN FEET, INCHES, FRACTION OF INCHES AND DECIMALS. UNLESS OTHERWISE SPECIFIED TOLERANCES: 3 PLACE DECIMALS ±.005 ANGLES ±1° FRACTIONS ±1/16 - CRITICAL CHARACTERISTIC FLAG PER SPEC. XXXX			CHECKED BY:	
			APPROVED BY:	
			SCALE: NTS	SIZE: B
			SHEET: 1 OF 1	
			FILE: SF3282-XPG-5XX_CD	DIRECTORY: SLW
			PART NUMBER: SF3282-XPG-5XX_CD	REV 0A



TITLE: CONNECTOR ASSEMBLY KIT (2-12) #20 PIN CONTACTS SHIELDED MULTI-CON-X STANDARD PRODUCT