

REV. Status

PRELIMINARY
07/10/00 LLPRELIMINARY 1
ADDED ISO DWG.
07/12/00 LLPRELIMINARY 2
CHANGED
PACKAGE STYLE
08/02/00 LLPRELIMINARY 3
CHANGED OCL
09/01/00 LL

HOME PNA ISOLATION TRANSFORMER

- Designed for 10Mbps Home Phone Line Networks
- Surface Mount Device withstands IR reflow profile process

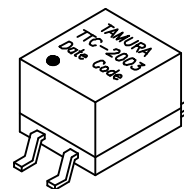

MODEL NUMBER

TTC-2003

Electrical Specification	PNA	Tolerance	Condition
Turns Ratio	1:1	±2%	(1'-2) : (4'-3)
OCL (uH)	8	Min	100KHz, 0.1Vrms, (1-2)
Leakage Inductance (uH)	0.5	Max	100KHz, 0.1Vrms, (1-2), (4-3 SC)
Interwinding Capacitance (pF)	12	Max	From primary to secondary
DC Resistance (Ω)	0.1	Max	(1-2), (4-3)
Dielectric Rating Voltage (Hipot) (Vrms)	500	Min	For one minute

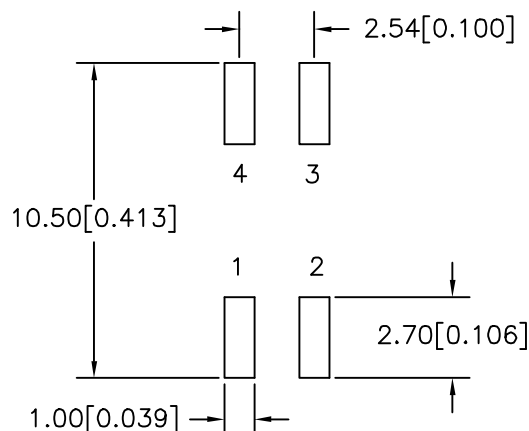
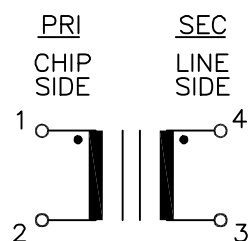

Recommended Solder Pad Layout

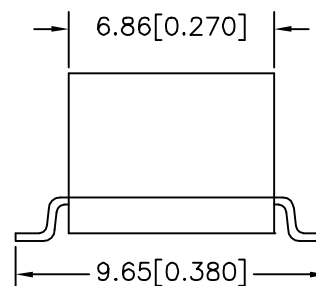
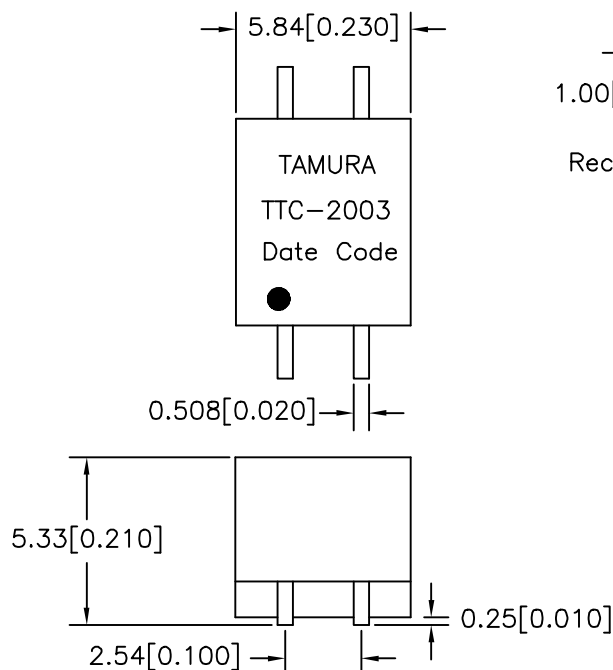

PREPARED BY:

D. Rund

ENGINEER:

L. Le

QUALITY CONTROL:

D. Kelley

APPROVED:

J. Coleman

NOTE: Unless otherwise specified, all dimensions are mm[in] with tolerance of ±0.25[0.010]

DWG CONTROL NO.
P-A1-12525
ACAD\TTC\A1125251.DWGREV
PR3HOME PNA
ISOLATION TRANSFORMERTAMURA CORPORATION OF AMERICA
43352 BUSINESS PARK DRIVE, TEMECULA, CA. 92590-6624
(909) 699-1270 FAX 9096769482

TTC-2003

MODEL SPECIFICATION

DIM: mm(in) SCL: 4/1 SH: 1 OF 1

PROPRIETARY NOTICE: THIS DRAWING PRINT OR DOCUMENT AND SUBJECT MATTER DISCLOSED HEREIN ARE PROPRIETARY ITEMS TO WHICH TAMURA RETAINS THE EXCLUSIVE RIGHT OF DISSEMINATION, REPRODUCTION, MANUFACTURE AND SALE. THIS DRAWING, PRINT OR DOCUMENT IS SUBMITTED IN CONFIDENCE FOR CONSIDERATION BY THE RECIPIENT ALONE UNLESS PERMISSION FOR FURTHER DISCLOSURE IS EXPRESSLY GRANTED IN WRITING.