

## Products

### LED Indicators

CML IT offers panel mount indicators manufactured with LED, Neon or Incandescent light sources. These indicators are available in a number of different lens and termination styles, with voltages of 2V ~ 250V available off-the-shelf.

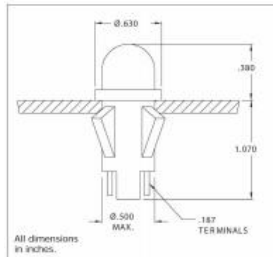

**Part Number:** 1091QM1-12V  
**Serial Number:** 1091  
**Mounting hole (inch):** 1/2"  
**Mounting hole (metric):** 12.7mm  
**Indicator type:**  
**Mounting type:**  
**Bezel type:**  
**Bezel material:**  
**Bezel color:**  
**Bezel size:**  
**Protection:**  
**Lens type:**  
**Lens color:** Red  
**Lens size:**  
**Connector tpe:** .187" QC  
**Connector number:**  
**Connector for lamp test:**  
**Number LED chip:**  
**Indicator color:** red  
**Dom wave length:**  
**Peak wave length (mA):**  
**Op. voltage (V):** 12.0  
**Forward volt max:**  
**Rectifier:**  
**AC current:**  
**DC current:**  
**Lum in min (mcd):**  
**Lum in type (DC):**  
**Voltage type (%):**  
**Op. temperature (°C):**  
**Storage temperature (°C):**  
**Narrative:**  
**Viewing angle (°):**  
**RoHS Status:** Yes

## 1091QM Series Non-Relampable LED Indicator Lights

### DESCRIPTION AND FEATURES

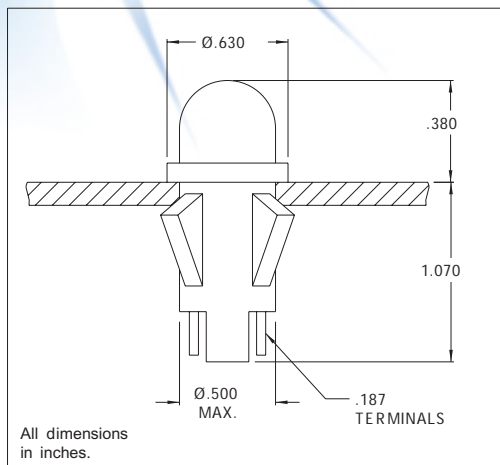

Solid-state indicator lights complete with built-in current-limiting resistor and rectifier diode.

Mounting: Will snap-fit into Ø.500/.505 hole in panels .020/.100 thick. Push-on speednut SN0461 also available.  
 Mounting hole pattern on page SP2.

Terminals: Quick-connect, tinned brass.  
 Lens: Polycarbonate

Anode(+): Marked above terminal

Bezel: Polished stainless steel.  
 For black finish add "X" after the series letter(s).

Housing: White Nylon

Lens Color	Solid State	
	Model No. (12V)	Model No. (24V)
Red	1091QM1-12V	1091QM1-24V
Green	1091QM5-12V	1091QM5-24V
Yellow	1091QM7-12V	1091QM7-24V
Internal Resistor (ohms)	390	1000

Lens Color	Incorporates LED *
Red	4304H1
Green	4304H5
Yellow	4304H7

\* Also incorporates 1N4004 (400 P.I.V.) rectifier diode.

Voltage Table		
Nominal	VAC	VDC
12V	10 to 20	6 to 13.5
24V	22 to 32	12 to 24

To use 24V model: Beyond 32VAC add 30 ohms per volt; beyond 24 VDC add 50 ohms per volt. Use 1/2W resistor up to 50V; 1W resistor for 50V to 70V; 2W resistor for 75V to 125V. Do not use beyond 125V.