

GEARTOOTH SPEED SENSOR



GS1023 Series

Threaded, straight connector gear speed sensor rated to 140°C.

Features

- Capable of operating up to 140°C
- Designed to meet IEC60529 IP68 standard for immersion
- Resistant to fuels, solvents, and lubricants associated with engines, transmissions, brakes and chassis systems
- ESD resistant to 15kV (contact discharge)
- Operates at arbitrarily low speeds
- Mating connector Packard sealed female connector assembly 3F
- Supplied with installed Viton O-ring
- Installs into a standard M20 x 1.5 O-ring port

Applications

- Transmission speed
- Wheel speed
- Engine speed
- Anti-lock braking systems

Specifications

Part Number	Operating Voltage Range (VDC)	Supply Current (mA max.)	Output	Output Saturation Voltage (mV max.)	Output Current (mA max.)	Operating Temp Range (°C)	Storage Temp Range (°C)	Leads	Connector
GS102301	9.0 – 16	6	sink	600	25	–40 to 140	–40 to 150	—	Packard*

Notes: These sensors require the use of an external pull-up resistor, the value of which is dependent on the supply voltage. Pull-up resistor should be connected between output and Vcc.

*Mating connector: Packard MetriPack part number 12162279 or 12162280, terminals: Packard MetriPack part number 12124075 or 12124076

Dimensions inches (mm)

All tolerances ± 0.005 (0.13) unless otherwise noted.

Recommended external pull-up resistor

Volts(DC)	5	9	12	15
Ohms	1000	1800	2400	3000

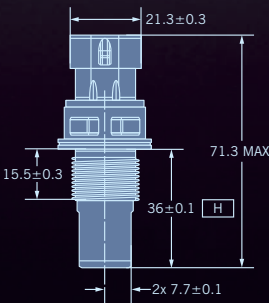
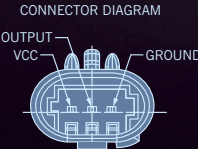
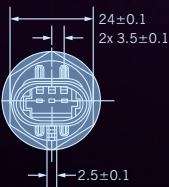

Open Collector Sinking Block Diagram

