

NOTES:

1. Rating: 12VDC 50mA
1. 额定值: 12VDC 50mA
2. Dielectric Strength: 250V AC
2. 耐电压: 250V AC
3. Contact Resistance: ≤100mΩ Max
3. 接触电阻: ≤100mΩ
4. Insulation Resistance: ≥100MΩ
4. 绝缘电阻: ≥100MΩ
5. Operating Force: 180±50gf
5. 操作力: 180±50gf
6. Life: 10,000 times
6. 寿命: 10,000 times
7. Travel: 1.50±0.3mm
7. 行程: 1.50 ± 0.3mm
8. Operating Temperature: -20 to +70°C
8. 使用温度: -20 to +70°C

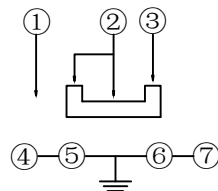
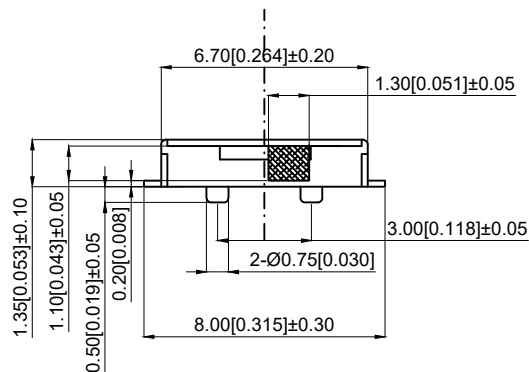

5	Terminal 端子	Brass	3	Ag plating 镀银
4	Reed 簧片	Phosphor bronze 磷青铜	1	silvery white 银白色
3	Hull 外壳	Brass	1	silvery white 银白色
2	Pedestal 基座	LCP	1	Black 黑色
1	Hand shank 手柄	PA46	4	Ag plating 镀银
NO 序号	Part name 部件名	Material 材料	QTY 数量	Remark 备注

A4				
A3				
A2				
A1				
REV	DATE	REVISION	DESCRIPTION	ISSUE



COMMON TOLERANCE

X.XX	± 0.10
X.X	± 0.15
X	± 0.25
ANGULAR	—

UNIT	MM	PROJECTED		PRODUCT NAME:
DRAWN BY	FUYUAN	CHECKED BY	COCO	MODEL NO: TP612221215
DATE	2019	APPROVAL B	ALEN	Https: www.rocpcu.tw
<b>ROCPCU TECHNOLOGY CO., LTD</b>				
Copies are issued in strict confidence and shall not be reproduced or copied, or used as the basic of manufacture or sale of apparatus without permission				