

CIRCUIT DIAGRAM

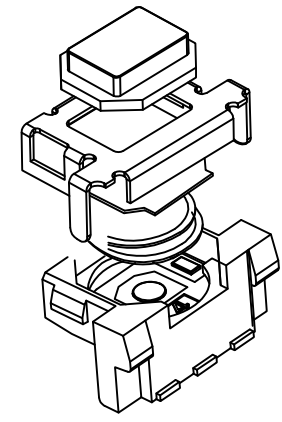

- NOTES:
1. Rating: 12VDC 50mA
  1. 额定值: 12VDC 50mA
  2. Dielectric Strength: 250V AC
  2. 耐电压: 250V AC
  3. Contact Resistance: ≤50mΩ Max
  3. 接触电阻: ≤50mΩ
  4. Insulation Resistance: ≥100MΩ
  4. 绝缘电阻: ≥100MΩ
  5. Operating Force: 260±40gf
  5. 操作力: 260±40gf
  6. Life: 100,000 times
  6. 寿命: 100,000 times
  7. Trip: 0.20±0.10mm
  7. 行程: 0.20±0.10mm

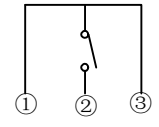
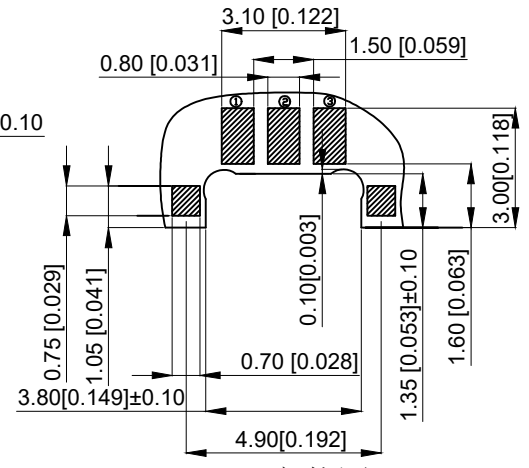
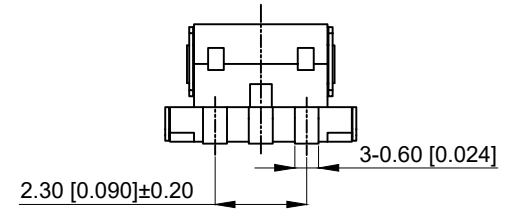
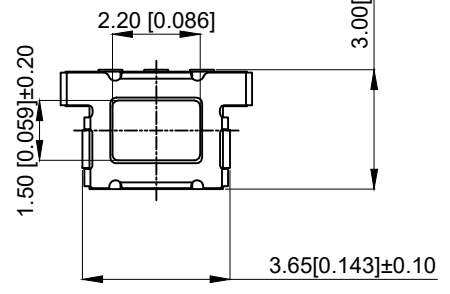

PCB. 安装图

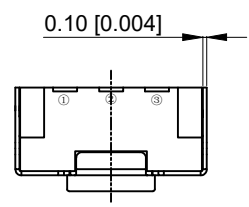

6	Dustproof film 防尘膜	PI	1	Yellow 黄色
5	Contact 触点	Phosphorous copper	1	Ag plating 镀银
4	Base 基座	LCP	1	Black 黑色
3	Reed 簧片	SUS	2	Covered with silver 覆银
2	Cover plate 盖板	Brass	1	Ag plating 镀银
1	Button 按钮	LCP	1	Black 黑色
NO 序号	Part name 部件名	Material 材料	QTY 数量	Remark 备注

A4				
A3				
A2				
A1				
REV	DATE	REVISION	DESCRIPTION	ISSUE
	A		B	



COMMON TOLERANCE	
X.XX	± 0.10
X.X	± 0.15
X	± 0.25
ANGULAR	—

UNIT	MM	PROJECTED		PRODUCT NAME:
DRAWN BY	FUYUAN	CHECKED BY	COCO	MODEL NO: TP14922629
DATE	2019	APPROVAL B	ALEN	Https: www.rocpcu.tw

**ROCPCU TECHNOLOGY CO., LTD**

Copies are issued in strict confidence and shall not be reproduced or copied, or used as the basic of manufacture or sale of apparatus without permission