

PCB LAYOUT
TOP VIEW (TOLERANCE:±0.05)

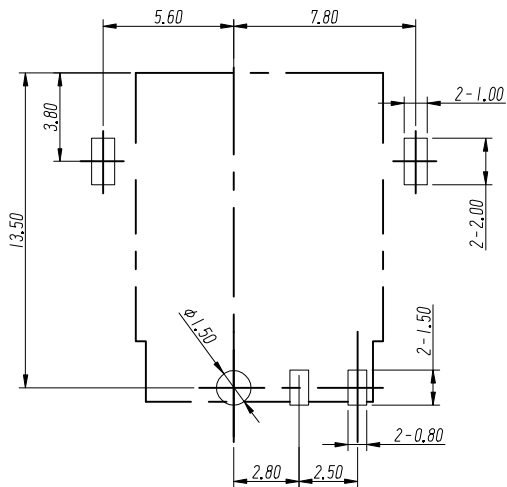

SCHMATIC

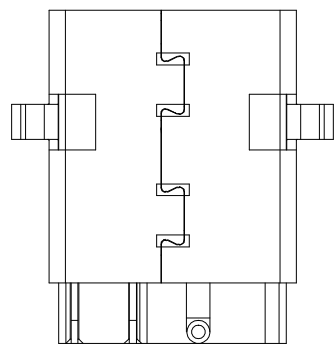
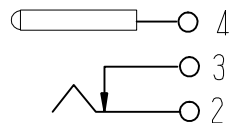

技术特性:

使用条件: -30~70°
 额定负荷: DC30V 10A
 接触电阻: ≤0.02Ω
 绝缘电阻: ≥100mΩ
 耐压: AC250V (50Hz) min
 插拔力: 3~15N
 寿命: 5000次

6	面板	1	不锈钢T=0.12	无
5	外壳	1	不锈钢T=0.4	磷铜
4	插针	1	H59黄铜棒	金
3	弯片	1	H62黄铜带T=0.3	磷铜
2	弹片	1	磷铜=0.3	磷铜
1	底座	1	9T	黑
序号	名称	数量	材料	备注

GENERAL TOLERANCES		
0.X	±0.30	X° ±3°
0.XX	±0.20	
0.XXX	±0.10	X.X° ±1°
UNIT	SIZE	SCALE
MM	A4	1:1

DRAWN		C	TITLE: 电源插座
DESIGN		PART NO.	DC-0125-CB-10A-AU-**
CHECKED		PRODUCT NO.	
APPROVED		DRAWING NO.	
		UNIT: mm	SCALE: 1:1 REV:01-1 SHT:10F1

浙江创都电子科技有限公司

ECN NO.	REV	DATE	DESCRIPTION	MDF'D	APP'D
	01	2021.12.22	NEW DRAWING RELEASE		