

CAB469RF: MMCX R/A PLUG + SMA STRAIGHT BULKHEAD JACK WITH O-RING RATED TO IP67/68 + MULTIPLE CABLE SIZES, 6GHz

SPECIFICATIONS :

- MMCX RIGHT ANGLE PLUG, P/N:
FOR $\phi 1.37\text{MM}$, RG178 CABLE: RFCT-MMCX003-M78.
FOR $\phi 1.13\text{MM}$ LOW LOSS CABLE: RFCT-MMCX002-M13.
- COAXIAL CABLE, SEE P/N OPTIONS.
- SMA STRAIGHT BULKHEAD JACK WITH O-RING RATED TO IP67/68, P/N: RFCT-SMA069-F78.

USAGE PRECAUTIONS: CABLES USING 'MICRO' COAX ARE DELICATE:
 (i) HANDLE WITH CARE.
 (ii) DO NOT TWIST; APPLY EXCESSIVE FORCES OR SHARP BENDS TO THE CABLE. DO NOT FORCEFULLY DEFORM WIRES.
 (iii) CONSULT CONNECTOR MANUFACTURER'S DATASHEETS FOR DETAILED NOTES ON HANDLING INSTRUCTIONS.

ENVIRONMENTAL:

- A. BULKHEAD MOUNTED CONNECTOR (RFCT-SMA069-F78) RATED TO THE FOLLOWING SPECIFICATION:
- IP6X - DUST TIGHT - NO PARTICLE INGRESS.
 - IPX7 WATERPROOF FOR 30 MINUTES UP TO 1 METER UNDERWATER.
 - IPX8 WATERPROOF FOR 48 HOURS AT 1 METER UNDERWATER.

NOTES:

- THE ORIENTATION OF CONNECTORS ON DRAWING IS FOR REFERENCE ONLY, IF THE ORDER IS LEFT BLANK THE CONNECTOR WILL NOT HAVE FIXED ORIENTATION.
- FIXED ORIENTATION IS SUGGESTED FOR CABLE LENGTH 50MM TO 100MM. PLEASE SPECIFY THE FIXED ORIENTATIONS FROM THE ORDER CODE (F1, F2, ETC)
- CONTACT GCT IF THE ORIENTATION YOU REQUIRE IS NOT SHOWN.
- WORKING FREQUENCY RANGE: DC-6GHz.
- OPERATING TEMPERATURE: -40°C TO $+125^{\circ}\text{C}$.
- IMPEDANCE: 50 Ohm.

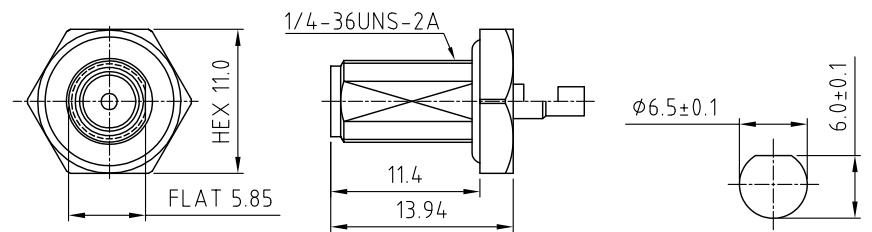
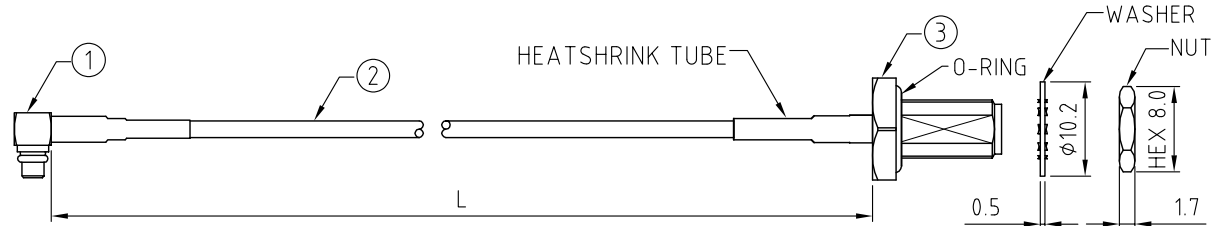

RECOMMENDED SMA MOUNTING HOLE

HOW TO ORDER

CAB469RF - X X X X - X X - X - X

"L" LENGTH IN MM:
 eg: 100MM = 0100
 (MIN. 0050-MAX.0400)
 STANDARD = 0100, 0150, 0200
 TOLERANCE: 50-200mm: $\pm 5\text{mm}$.
 201-400mm: $\pm 7\text{mm}$.

CABLE SIZE OPTIONS:
 1 = RG178 CABLE, COLOR: BROWN
 2 = $\phi 1.37\text{MM}$ CABLE, COLOR: BLACK
 3 = $\phi 1.13\text{MM}$ LOW LOSS CABLE, COLOR: GRAY

WASHER AND NUT OPTIONS:
 BLANK = SEPARATELY PACKED (STANDARD)
 A = ASSEMBLED WITH CONNECTOR

ORIENTATION OPTIONS:
 BLANK = DOES NOT HAVE A FIXED ORIENTATION
 F1 = MMCX CONNECTION DOWN (L=50-200MM)
 F2 = MMCX CONNECTION UP (L=50-200MM)
 F3 = MMCX CONNECTION & SMA FLAT SAME ORIENTATION (L=50-200MM)
 F4 = MMCX CONNECTION & SMA FLAT OPPOSITE ORIENTATION (L=50-200MM)
 (SEE NOTES 1, 2, 3 AND DIAGRAMS FOR MORE INFORMATION)

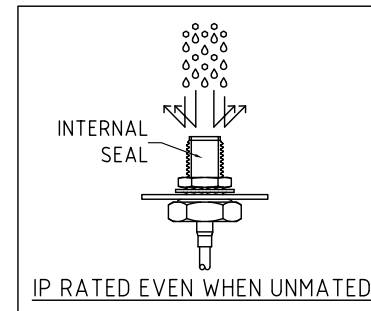
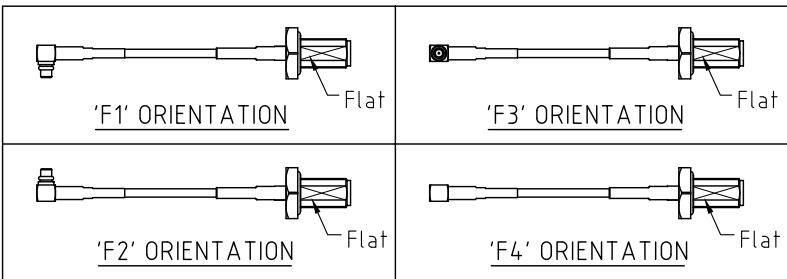

REV. DATE & DRN	10. 24/05/21 - NVM RELEASE
	11. 05/04/22 - NVM
	ADD 131. CABLE OPTION.
	12. ADD F1-F4 ORIENTATION
	13. ADD F1-F4 ORIENTATION
	14. CORRECT RG178 CABLE COLOR.
	ADD 113 LL CABLE OPTION.
	15. 28/01/24 - CC
	ADD IP RATING VIEW
	16. 16/02/25 - CC
	ADD GCT logo.

Scale: NTS	THIRD ANGLE	Unstated: .X, .XX, .XXX ANGLES	Tolerances: N/A, N/A, N/A, N/A
Drawn: CC		Title: CABLE ASSEMBLY	
App'd: XXX	Date: 16 Feb. '25		
Date: 16 Feb. '25	Revision: 1.6	Unit: mm	

IP Rated RF Products



Drawing Number: CAB469RF	
Sheet 1	of 1
Drawing	E and O E

Mouser Electronics

Authorized Distributor

Click to View Pricing, Inventory, Delivery & Lifecycle Information:

[GCT:](#)

[CAB469RF-0050-A-1](#) [CAB469RF-0200-A-1](#) [CAB469RF-0150-A-1](#) [CAB469RF-0100-A-1](#) [CAB469RF-0300-A-1](#)