

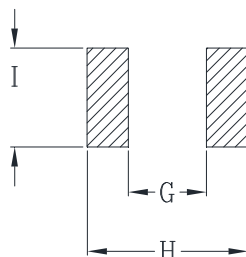

DELTA P/N: HCME606090F Series

Mechanical Dimensions

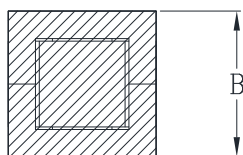

Suggested PWB Layout

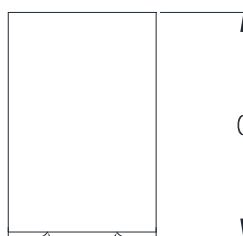

DCR Measure Points

UNIT : mm
 A = 6.0 MAX.
 B = 6.0 MAX.
 C = 9.0 MAX.
 D = 3.3
 E = 1.1
 F = 3.5
 G = 3.0
 H = 6.2
 I = 3.8

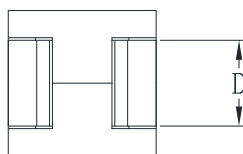

Electrical Characteristics @ 25°C, 100kHz, 1V

Delta P/N	L (nH) ± 15%	Li (nH) MIN	DCR (mΩ) ± 10%	Isat ¹ (A)			Ir ² (A)
				25°C	100°C	125°C	
HCME606090F-101	100	72	0.25	70	60	56	50
HCME606090F-121	120	86		58	50	46	
HCME606090F-151	150	108		45	38	36	

1. Isat is the DC current which causes the inductance drop to Li.
2. Ir is the DC current which causes the surface temperature of the part increase approximately 40 °C.
3. Operating temperature: -40°C to 125°C (Self-temperature rise included).

Mouser Electronics

Authorized Distributor

Click to View Pricing, Inventory, Delivery & Lifecycle Information:

[Cyntec:](#)

[HCME606090F-151](#) [HCME606090F-101](#) [HCME606090F-121](#)